



KING COUNTY

1200 King County Courthouse
516 Third Avenue
Seattle, WA 98104

Signature Report

April 28, 2008

Ordinance 16076

Proposed No. 2008-0186.1

Sponsors Constantine

1 AN ORDINANCE authorizing the King County executive
2 to enter into an interlocal agreement with the city of Burien
3 for the transfer of drainage facilities and property interests
4 and to execute a deed of conveyance in favor of the city of
5 Burien for drainage-related property interests within city
6 limits.

7

8 STATEMENT OF FACTS:

- 9 1. The city of Burien (Burien) recognizes the need for comprehensive
10 surface water management and drainage services to preserve and protect
11 the environment, public and private property, and the health and welfare
12 of its citizens.
- 13 2. Burien has a surface water management and drainage services program
14 that includes the inspection and maintenance of drainage facilities.
- 15 3. The area within Burien city limits contains drainage systems, including
16 facilities and property interests, previously owned and operated by King
17 County but now serving areas within Burien city limits.

18 4. Burien and King County believe that it is in the best interest of the
19 public that King County formally transfer ownership of, and responsibility
20 for, drainage facilities and drainage property interests within Burien
21 municipal boundaries.

22 5. Pursuant to chapter 39.34 RCW, the Interlocal Cooperation Act, the
23 parties are each authorized to enter into an agreement for cooperative
24 action.

25 BE IT ORDAINED BY THE COUNCIL OF KING COUNTY:

26 SECTION 1. The King County executive is hereby authorized to enter into an
27 interlocal agreement, in substantially the same form as Attachment A to this ordinance,
28 with the city of Burien for the transfer of drainage facilities and property interests.

29 SECTION 2. The King County executive is hereby authorized to execute a deed
30 of conveyance in favor of the city of Burien for drainage-related property interests within
31 city limits as shown in Exhibit Three to Attachment A to this ordinance.

32

Ordinance 16076 was introduced on 4/7/2008 and passed by the Metropolitan King County Council on 4/28/2008, by the following vote:

Yes: 8 - Ms. Patterson, Mr. Dunn, Ms. Lambert, Mr. von Reichbauer, Mr. Ferguson, Mr. Gossett, Mr. Phillips and Ms. Hague
No: 0
Excused: 1 - Mr. Constantine

KING COUNTY COUNCIL
KING COUNTY, WASHINGTON

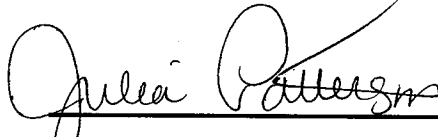

Julia Patterson, Chair

ATTEST:

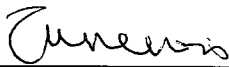

Anne Noris, Clerk of the Council

APPROVED this 6 day of May, 2008.

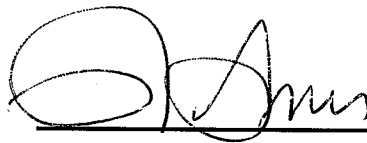

Ron Sims, County Executive

RECEIVED
2008 MAY -7 PM 12:31
KING COUNTY COUNCIL
CLERK

Attachments A. Interlocal Agreement between King County and the City of Burien for the Transfer of Drainage Facilities and Property Interests

**INTERLOCAL AGREEMENT BETWEEN KING COUNTY
AND THE CITY OF BURIEN
FOR THE TRANSFER OF DRAINAGE FACILITIES AND PROPERTY
INTERESTS**

This Agreement is hereby entered into between the City of Burien, a municipal corporation operating as a noncharter code city ("Burien" or "City") and King County (collectively known as "the Parties"), to transfer from King County to the City ownership of and responsibility for drainage facilities and drainage property interests ("Agreement").

WHEREAS, the City is located entirely within the corporate boundaries of King County and incorporated as a code City in 1993, and

WHEREAS, King County owns certain drainage facilities and drainage properties located within the City of Burien municipal boundaries that were not transferred to the City upon incorporation, and

WHEREAS, the City and the County believe that it is in the best interest of the public that King County transfer ownership of and/or responsibility for drainage facilities and drainage property interests within Burien municipal boundaries to the City to be managed under its surface water management program, and

WHEREAS, pursuant to RCW 39.34, the Interlocal Cooperation Act, the Parties are each authorized to enter into an agreement for cooperative action;

NOW THEREFORE, the parties hereto agree as follows:

I. Purpose of the Agreement

The purpose of this Agreement is to set forth the process by which King County will transfer to Burien, in perpetuity, ownership of and responsibility for specific drainage facilities and drainage property interests located within the City limits.

II. Administration

- A. The City and King County shall each appoint a representative to manage activities covered under this Agreement and to resolve any conflicts that arise ("Administrators").
- B. Any conflict that is not resolved by the Administrators within ten (10) working days of the meeting held to discuss the conflict shall be referred for resolution to the City

Manager, or his/her designee, and the King County Water and Land Resources (WLR) Division Director.

III. Responsibilities of the Parties

A. King County Responsibilities

1. On the effective date of this Agreement, all right, title and interest of King County in and to the drainage facilities identified and listed in Exhibit One, attached to this Agreement and incorporated herein and made a part hereof, are hereby transferred to the City free and clear of liens or encumbrances, and the City shall assume full and complete responsibility for the operation, maintenance, repair, and any subsequent improvements to these drainage facilities. The Parties acknowledge that prior to the execution of this Agreement Burien assumed operation and maintenance responsibility for the facilities listed on Exhibit One.
2. As soon as is practicable after the Parties have executed this Agreement, King County will convey to the City by quit claim deed in substantially the same form as Exhibit Two, attached hereto and incorporated herein and made a part hereof, the drainage facility property interests identified in Exhibit Three (real property), attached hereto and incorporated herein and made a part hereof, and Exhibit Four (easements), attached hereto and incorporated herein and made a part hereof.
3. King County shall furnish the City with a list of any and all contracts or other agreements, rights, obligations, restrictions, or dedications related to operations, conditions, ownership, or use of the conveyed property interests. King County shall provide the City a copy of each such contract, agreement, right, obligation, or restriction to the extent known and available to King County.
4. King County shall provide the City, at the earliest opportunity, copies of all warranties, maps, titles, "as built," maintenance logs and records, maintenance and performance standards, and any and all other records related to the facilities and property interests listed on Exhibits One, Three and Four to the extent known and available to King County.

6. In the event legal action is brought or threatened against the City of Burien or the City of Burien and King County jointly with regard to the facilities or property interests listed in Exhibits One, Three and Four King County shall provide Burien access to all relevant information that is maintained by the County in connection with such facilities and property interests.

B. Burien Responsibilities

1. On the effective date of this Agreement, the City shall assume full and complete ownership of and responsibility for the operation, maintenance, repairs, and any subsequent improvements to the drainage facilities listed in Exhibit One.
2. Upon delivery of the quit claim deed, as provided for in III.A.2. this Agreement, the City shall accept the full rights and responsibilities of ownership of the drainage property interests identified in Exhibit Three and Exhibit Four that will be conveyed in such deed.
3. The City shall abide by and enforce all terms, conditions, reservations, restrictions, and covenants to title conveyed in the drainage property interests.
4. In the event that legal action is brought or threatened against King County or King County and the City jointly with regard to the facilities or property interests listed in Exhibits One, Three or Four, the City shall provide King County access to all relevant information that is maintained by the City in connection with such facilities and property interests.
5. The City shall consult with King County prior to the destruction of any documentation associated with the facilities and/or property interests listed on Exhibits One, Three and Four for a period of seven (7) years.
6. The City accepts the facilities in "As Is" condition. The County makes no warranty concerning such facilities other than as set forth in this Agreement. The City assumes full and complete responsibility for all operations, maintenance, repairs, and improvements for the drainage facility property interests from and after its acceptance.

Both Parties

1. Both Parties shall make staff available to identify and review any additional County-owned drainage facilities and/or property interests to be conveyed to the City. Additional County-owned drainage facilities and/or drainage

property interests shall be transferred to the City pursuant to this Agreement upon the City's and County's approval, including, where required, the adoption of an ordinance authorizing the transfer of King County owned drainage properties.

2. The records related to matters covered by this Agreement are subject to inspection, review or audit by King County or the City at the requesting party's sole expense. Such records shall be made available for inspection during regular business hours within a reasonable time of the request.

IV. Effectiveness, Termination and Amendment

- A. This Agreement is effective upon signature of the Parties.
- B. This Agreement is of indefinite duration and shall continue in existence until terminated by mutual agreement in writing of the Parties
- C. This Agreement may be amended, altered, or clarified only by written agreement of the Parties hereto.
- D. This Agreement is a complete expression of the terms hereto and any oral or written representations or understandings not incorporated herein are excluded. The parties recognize that time is of the essence in the performance of the provisions of this Agreement. Waiver of any default shall not be deemed to be a waiver of any subsequent default. Waiver of breach of any provision of this Agreement shall not be deemed to be a waiver of any other or subsequent breach and shall not be construed to be a modification of the terms of the Agreement unless stated to be such through written approval by the parties which shall be attached to the original Agreement.

V. Indemnification and Hold Harmless

- A. King County shall indemnify and hold harmless the City and its elected officials, officers, agents or employees, or any of them, from and against any and all claims, actions, suits, liability, loss, costs, expenses and damages, which are caused by or result from a negligent action or omission of King County, its officers, agents and employees in performing its obligations pursuant to this Agreement.

In the event that any suit based upon such a claim, action, loss or damage is brought against the City or the City and King County, King County shall defend the

same at its sole cost and expense and, if final judgment be rendered against the City and its elected officials, officers, agents and employees or jointly against the City and King County and their respective elected officials, officers, agents and employees, King County shall satisfy the same.

- B. In executing this Agreement, the County does not assume liability or responsibility for or in any way release the City from any liability or responsibility which arises in whole or in part from the existence or effect of City ordinances, rules or regulations. If any cause, claim, suit, action or administrative proceeding is commenced in which the enforceability and/or validity of any such City ordinance, rule or regulation is at issue, the City shall defend the same at its sole expense, and if judgment is entered or damages are awarded against the City, the County or both, the City shall satisfy the same, including all chargeable costs and attorney's fees.
- C. The City shall indemnify and hold harmless King County and its elected officials, officers, agents and employees, or any of them, from and against any and all claims, actions, suits, liability, loss, costs, expenses and damages, which are caused by or result from a negligent act or omission of the City, its officers, agents and employees in performing obligations pursuant to this Agreement.

In the event that any suit based upon such a claim, action, loss or damage is brought against King County or King County and the City, the City shall defend the same at its sole cost and expense and, if final judgment be rendered against King County and its officers, agents and employees or jointly against King County and the City and their respective officers, agents and employees, the City shall satisfy the same.

- D. Each Party to this Agreement shall immediately notify the other of any and all claims, actions, losses or damages that arise or are brought against that Party relating

to or pertaining to the sites identified in the Agreement Exhibits One, Three and Four.

- E. Each Party agrees that its obligations under this subparagraph extend to any claim, demand, and/or cause of action brought by or on behalf of any employees, or agents. For this purpose, each Party, by mutual negotiation, hereby waives, with respect to the other party only, any immunity that would otherwise be available against such claims under the Industrial Insurance provisions of Title 51 RCW.
- F. The indemnifications provided for in this Article shall survive the termination of this Agreement.

IN WITNESS WHEREOF, the parties hereto have executed this Agreement on the _____ of _____, 2008.

Approved as to form:

KING COUNTY:

Deputy Prosecuting Attorney

King County Executive

CITY OF BURIEN:

Chris Bacha
Kenyon Disend, PLLC
Interim City Attorney

Michael Martin, City Manager

Attachment A

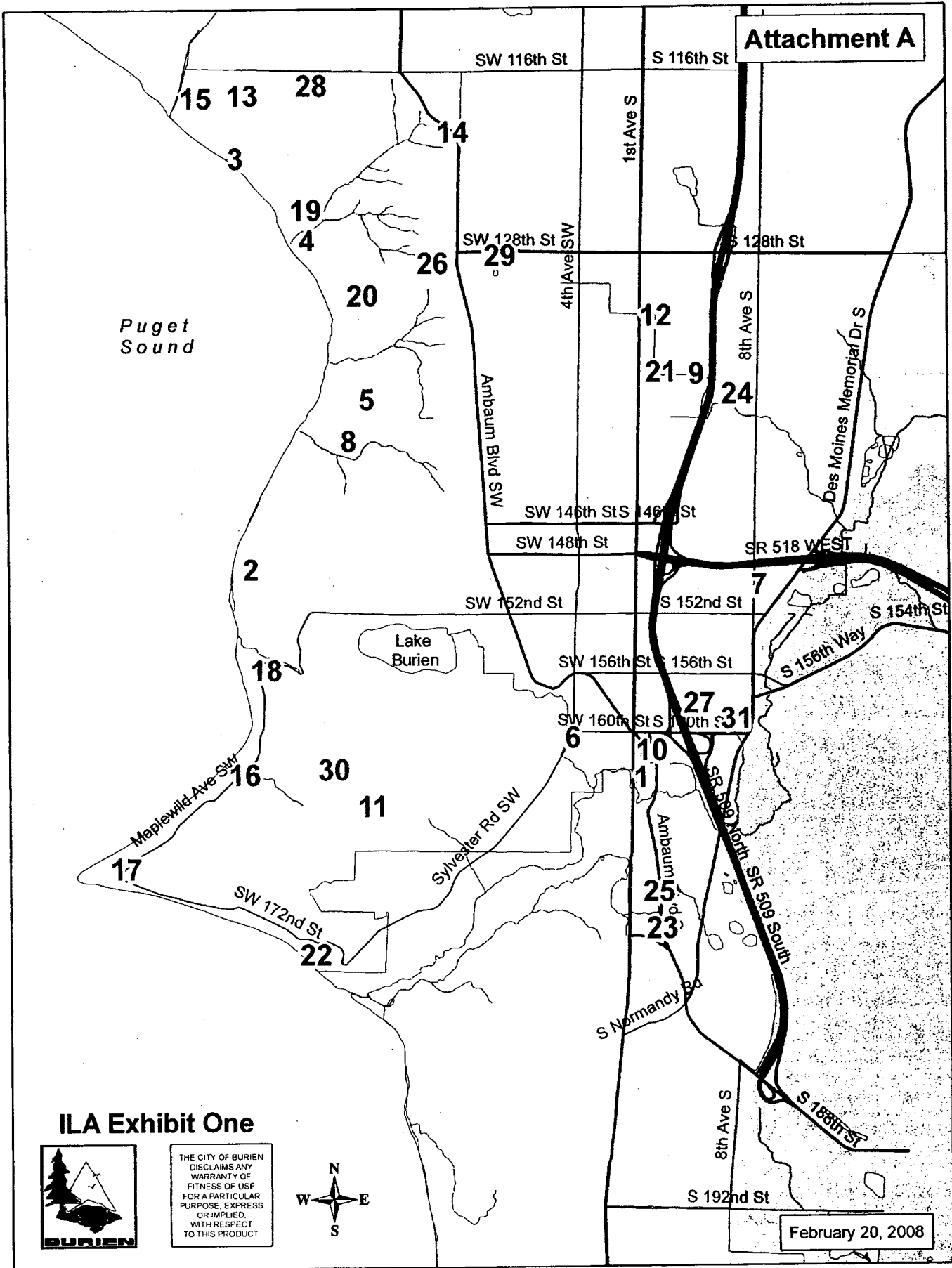

ILA Exhibit One



THE CITY OF BURIEN
 DISCLAIMS ANY
 WARRANTY OF
 FITNESS OF USE
 FOR A PARTICULAR
 PURPOSE, EXPRESS
 OR IMPLIED,
 WITH RESPECT
 TO THIS PRODUCT



February 20, 2008

Attachment A

Puget Sound

SW 116th St

S 116th St

1st Ave S

SW 128th St

S 128th St

4th Ave SW

8th Ave S

Ambaum Blvd SW

Des Moines Memorial Dr S

SW 146th St

SW 148th St

SR 518 WEST

SW 152nd St

S 152nd St

S 154th St

Lake Burien

SW 156th St

S 156th Way

SW 160th St

S 160th St

Maplewild Ave SW

Sylvester Rd SW

Ambaum Blvd S

SR 509 North
SR 509 South

SW 172nd St

S Normandy Rd

8th Ave S

S 188th St

S 192nd St

ILA Exhibit Three



THE CITY OF BURIEN
DISCLAIMS ANY
WARRANTY OF
FITNESS OF USE
FOR A PARTICULAR
PURPOSE, EXPRESS
OR IMPLIED,
WITH RESPECT
TO THIS PRODUCT



February 20, 2008

1 2

5

3 4

6

7

Attachment A

ILA Exhibit One - Facilities to be Transferred

	Facility Name	Location	On Dedicated Tract?	Facility Type
Regional Facilities				
1	Ambaum Regional Pond	S 162nd St & 1st Ave S	No - Esmt	Pond
2	FO-040	14901 28th Ave SW	No - ROW, Esmt	Enclosed Drain
3	FO-140	Shorewood Dr SW/30th Ave SW	No - ROW, Esmt.	Enclosed Drain
4	FO-150	12575 Standing Lane SW	No - ROW, Esmt.	Enclosed Drain
5	FO-190	13678 18th Ave SW	No - ROW	Enclosed Drain
6	FO-210	SW 160th St/Sylvester Rd SW	No - Esmt.	Enclosed Drain
7	FO-310	825 S 149th Pl	No - ROW, Esmt.	Enclosed Drain
8	FO-400	SW 140th St & 16th Ave SW	No - Esmt.	Enclosed Drain
9	FO-410	S 136th St/SR 509	ROW	Enclosed Drain
10	FO-430	S 162nd St/Ambaum Blvd S	No - Esmt.	Enclosed Drain
11	Gregory Heights Sed. Facility	16424 19th Avenue SW	No - ROW, Esmt.	Sediment Vault
12	Occidental Drainage System	13231 Occidental Ave S	No - ROW, Esmt.	Enclosed Drain
13	Seola Creek at 29th Pl SW	11647 29th Pl SW	ROW	Enclosed Drain
14	Ambaum Drain at Salmon Creek	Ambaum Blvd SW/SW 120th St.	No - ROW	Pipe
15	Seola Beach Pipeline	11650 Seola Beach Dr SW	No - ROW, Esmt.	Pipe
16	FO-020	16327 Maplewild Ave. SW	No, ROW	Enclosed Drain
17	FO-020 A	Maplewild Ave. SW/171 st St.	No, ROW	Enclosed Drain
18	FO-030	15612 Maplewild Ave. SW	No, Esmt.	Enclosed Drain
19	FO-160	12550 Shorewood Dr. SW	No, ROW	Enclosed Drain
20	FO-170	1915 SW Cove Point Rd.	No, ROW	Enclosed Drain
21	FO-390	13418 Occidental Ave. S.	No	Enclosed Drain
22	23 rd Place SW Drain	2329 SW 172 nd St.	No, ROW	ROW to Puget Sound
Residential Facilities				
23	Ambaum Place	201 S 172nd Pl	No - ROW, Esmt.	tank
24	Kennedy Vista	531 S 137th Pl	No - ROW, Esmt.	tank
25	Krohn Estates	16831 Ambaum Blvd S	No - ROW, Esmt.	tank
26	Shep's Olympic View Addition	1445 SW 129th St	No - ROW, Esmt.	tank
27	SP 0186025	15834 5th Ln S	No - Esmt.	infiltration
28	SP 0583074	11650 23rd Ave SW	No - Esmt.	infiltration
39	SP 0685040	12805 8th Ave SW	No - ROW, Esmt.	tank, conveyance
30	SP 0788028	2021 SW 163rd Ct	No - Esmt.	tank
31	SP 0884008	15823 5th Ln S	No - Esmt.	infiltration, oil/water separator

ILA Exhibit Two - Form of Quit Claim Deed

AFTER RECORDING RETURN TO:

City of Burien

QUIT CLAIM DEED

GRANTOR – KING COUNTY

GRANTEE - CITY OF Burien

LEGAL --

C. TAX NO. – N/A

The Grantor, KING COUNTY, WASHINGTON, a political subdivision of the State of Washington, for and in consideration of mutual benefits, receipt of which is hereby acknowledged, conveys and quit claims unto the Grantee, the CITY OF BURIEN, a municipal corporation of the State of Washington, those certain real property interests, as legally described in Exhibit A, attached hereto and made a part of this Deed:

Dated this _____ day of _____, 2008.

KING COUNTY, WASHINGTON

BY _____

TITLE _____

ILA Exhibit Three - Property Interests to be Transferred

	Name	Location	Tax acct. #	Facil. type
1	Mayfair R/D Pond	861 SW 128 th St.	182304-9114	Pond
2	Hermes Pond	SW 130 th /6 th Pl. SW	182304-9088	Pond
3	Drywell Storage R/D	SW 142 nd /6 th Ave. SW	433100-0146	Infiltration
4	Chelsea Pond (P-21)	13030 4 th Ave. S.	144640-2140	Pond and pump
5	Drywell Storage Facility East	420 SW 142 nd St.	433100-0165	Infiltration
6	BSF041 (KC ID D92088)	140 S. 169 th Pl.	394440-0056	Detention Tank, Bioswale
7	BSF044 (KC ID D92479)	479 S. 190 th St.	809180-0150	R/D Pond

ILA Exhibit Four - Property Interests to be Transferred (Easements)

Easements per associated facility:

Ambaum Pond

Easement filed under recording # 9102270253 (Mueller)

Easement filed under recording #9102270252 (Mueller)

Easement filed under recording #9306030714 (Clark)

Easement filed under recording #8612170428

FO-430

Easement filed under recording #4742055 (Burchedian)

Easement filed under recording #4742054 (Schuck)

Easement filed under recording #4742054 (Justice)

Easement filed under recording # 4670892 (Rickman)

Easement filed under recording # 6161554 (Ryder)

Easement filed under recording #6161553 (Ryder)

Easement filed under recording #7403110088 (Wilcher)

Easement filed under recording #6683391 (Bashey)

Easement filed under recording #6683393 (Roberts)

Easement filed under recording #5141310 (Novak)

Easement filed under recording #7402220256 (Arnold)

Easement filed under recording #7402220257 (Arnold)

Easement filed under recording #7402220258 (Arnold)

Easement filed under recording #2980983 (Murison)

Easement filed under recording #7912050746 (BLR Partnership)

Easement filed under recording #8412120743 (North American Realty & Investment Co.)

Attachment A

Gregory Heights Sediment Facility

Easement filed under recording # 4764075 (Gippe)

Easement filed under recording # (rec. # still being obtained) (Lemmon)

Easement filed under recording # 8003280602 (Poague)

Easement filed under recording # 8003280601 (Nelson)

Easement filed under recording # 8003280600 (Nelson)

Easement filed under recording # 8003280603 (Rismiller)

FO-030

Easement filed under recording # 7411010103 (McFarland)

Occidental Drainage Facility

Easement filed under recording # 8712010920 (Mid Oil Company)

Easement filed under recording # 8712010922 (Schreiner)

Easement filed under recording # 8712010923 (Radenbaugh)

FO-210

Easement filed under recording # 4664418 (Scheeler)

Easement filed under recording # 4664419 (General Improvement Co. Inc.)

Easement filed under recording # 2927726 (Graves)

Easement filed under recording # 2928445 (Anderson)

Easement filed under recording # 2927726 (Graves)

Easement filed under recording # 5965851 (Fleming)

Easement filed under recording # 2980019 (Potter)

Easement filed under recording # 7904030834 (Saboe-Gerber)

Easement filed under recording # 8007150468 (Lauzon)

Easement filed under recording # 8007150467 (Seibert)

Easement filed under recording # 8309220422 (Nestbrook)

FO-040

Easement filed under recording # 7306080492 (Kennett)

Attachment A

P-21 Pond

Easement filed under recording # 6398764 (Security Savesco)

FO-150

Easement filed under recording # 4666004 (Standing)

FO-140

Easement filed under recording # 5720789 (Spittler)

Easement filed under recording # 5714521 (Garvin)

Easement filed under recording # 5714523 (Fellhauer)

Easement filed under recording # 5714522 (Currie)

Easement filed under recording # 5714520 (Brill)

Easement filed under recording # 5113280 (Shorewood Community Club)

Seola Beach Pipeline

Easement filed under recording # 4937783 (Higgins)

Not Associated with Any Known Facility

Easement filed under recording # 5848115 (Knishka)

Easement filed under recording # 5848115 (Shorewood Baptist Church)

All drainage easements dedicated to King County or to the public within the following recorded plats:

AIRWAY HEIGHTS ADD, as recorded in Volume 037 of Plats, page 053, records of King County, Washington

ALDERWOOD ACRES ADD, as recorded in Volume 024 of Plats, page 029, records of King County, Washington

ALINES EVERGREEN PARK ADD, as recorded in Volume 063 of Plats, page 062, records of King County, Washington

ALPHA PH I, as recorded in Volume 049 of Plats, pages 053 through 057, records of King County, Washington

AMBAUM MANOR, as recorded in Volume 103 of Plats, pages 015 through 018, records of King County, Washington

AMBAUM PLACE, as recorded in Volume 110 of Plats, pages 026 through 027, records of King County, Washington

AMBAUM SQUARE, as recorded in Volume 053 of Plats, pages 068 through 072, records of King County, Washington

Attachment A

ANDREW HOUSE, as recorded in Volume 095 of Plats, pages 060 through 063, records of King County, Washington

ANTHONY HEIGHTS ADD, as recorded in Volume 046 of Plats, pages 016 through 017, records of King County, Washington

BABCOCKS ADD, as recorded in Volume 056 of Plats, page 031, records of King County, Washington

BASSETS S J PLAT ADD, as recorded in Volume 051 of Plats, page 022, records of King County, Washington

BENTLER ADD, as recorded in Volume 044 of Plats, page 080, records of King County, Washington

BENTONS SOUNDVIEW ADD, as recorded in Volume 051 of Plats, page 028, records of King County, Washington

BLAKLEY MANOR DIV NO. 01, as recorded in Volume 053 of Plats, page 079, records of King County, Washington

BLAKLEY MANOR DIV NO. 02, as recorded in Volume 053 of Plats, page 078, records of King County, Washington

BLAKLEY MANOR DIV NO. 03, as recorded in Volume 054 of Plats, page 096, records of King County, Washington

BLUFFS THE, as recorded in Volume 105 of Plats, pages 044 through 049, records of King County, Washington

BONI VIEU ADD, as recorded in Volume 052 of Plats, page 089, records of King County, Washington

BROOKS G L SOUTHWOOD ADD, as recorded in Volume 038 of Plats, page 012, records of King County, Washington

BROOKSIDE PARK (0005), as recorded in Volume 050 of Plats, page 090, records of King County, Washington

BRUNEAUS GARDEN ADD, as recorded in Volume 060 of Plats, page 016, records of King County, Washington

BRUNEAUS GARDEN ADD NO. 02, as recorded in Volume 071 of Plats, page 032, records of King County, Washington

BURCH ADD, as recorded in Volume 055 of Plats, page 030, records of King County, Washington

BURCH ADD NO. 02, as recorded in Volume 059 of Plats, page 003, records of King County, Washington

BURIEN 146, as recorded in Volume 022 of Plats, pages 054 through 056, records of King County, Washington

BURIEN CASCADE VIEW TRS, as recorded in Volume 047 of Plats, page 076, records of King County, Washington

BURIEN COURT, as recorded in Volume 067 of Plats, page 067, records of King County, Washington

BURIEN ESTATES ADD, as recorded in Volume 073 of Plats, page 018, records of King County, Washington

BURIEN GLEN, as recorded in Volume 063 of Plats, pages 053 through 055, records of King County, Washington

BURIEN HEIGHTS, as recorded in Volume 145 of Plats, pages 093 through 095, records of King County, Washington

Attachment A

BURIEN HILLS ADD, as recorded in Volume 060 of Plats, page 099, records of King County, Washington

BURIEN LAKE VIEW TRACTS, as recorded in Volume 019 of Plats, page 002, records of King County, Washington

BURIEN LAKE VIEW TRACTS DIV NO. 02, as recorded in Volume 019 of Plats, page 087, records of King County, Washington

BURIEN LAKE VIEW TRACTS DIV NO. 03, as recorded in Volume 022 of Plats, page 085, records of King County, Washington

BURIEN LAKE VIEW TRACTS DIV NO. 04, as recorded in Volume 023 of Plats, page 050, records of King County, Washington

BURIEN LAKE VIEW TRACTS DIV NO. 05, as recorded in Volume 023 of Plats, page 049, records of King County, Washington

BURIEN LAKE VIEW TRACTS DIV NO. 06, as recorded in Volume 902 of Plats, page 046, records of King County, Washington

BURIEN MEDICAL DENTAL CENTER, as recorded in Volume 021 of Plats, pages 078 through 082, records of King County, Washington

BURIEN PARK ADD, as recorded in Volume 051 of Plats, page 065, records of King County, Washington

BURIEN PARK ESTATES ADD, as recorded in Volume 075 of Plats, page 037, records of King County, Washington

BURIEN TOWNHOUSES, as recorded in Volume 019 of Plats, pages 039 through 043, records of King County, Washington

BURIEN VIEW PH 01, as recorded in Volume 073 of Plats, pages 047 through 049, records of King County, Washington

BURIENHURST ADD, as recorded in Volume 020 of Plats, page 040, records of King County, Washington

CANDLEWOOD, as recorded in Volume 015 of Plats, pages 034 through 035, records of King County, Washington

CANDLEWOOD AMENDED, as recorded in Volume 022 of Plats, pages 051 through 053, records of King County, Washington

CASCADE VILLA ADD, as recorded in Volume 034 of Plats, page 032, records of King County, Washington

CEDARHURST DIV NO. 01, as recorded in Volume 031 of Plats, page 040, records of King County, Washington

CHRISTOPHERSON A E ADD, as recorded in Volume 042 of Plats, page 038, records of King County, Washington

COLBY VIEW HOME TRS, as recorded in Volume 049 of Plats, page 093, records of King County, Washington

COLBYS HAZEL VALLEY ADD, as recorded in Volume 052 of Plats, page 058, records of King County, Washington

CORMODES 5-ACRE GARDEN TRS, as recorded in Volume 005 of Plats, page 060, records of King County, Washington

Attachment A

COUNTRY CLUB HOME TRS, as recorded in Volume 902 of Plats, page 069, records of King County, Washington

COURTYARD TOWNHOMES, as recorded in Volume 148 of Plats, pages 048 through 050, records of King County, Washington

COVE POINT ADD, as recorded in Volume 065 of Plats, page 010, records of King County, Washington

CRESCENT BEACH ADD, as recorded in Volume 017 of Plats, page 044, records of King County, Washington

CRESTWOOD ADD, as recorded in Volume 045 of Plats, page 044, records of King County, Washington

DASHLEYS ADD NO. 01, as recorded in Volume 020 of Plats, page 005, records of King County, Washington

DASHLEYS ADD NO. 02, as recorded in Volume 020 of Plats, page 006, records of King County, Washington

DASHLEYS ADD NO. 03, as recorded in Volume 022 of Plats, page 076, records of King County, Washington

DASHLEYS W A LAKE ADD, as recorded in Volume 022 of Plats, page 056, records of King County, Washington

DETTA MANHATTAN ADD, as recorded in Volume 063 of Plats, page 023, records of King County, Washington

DINES ADD, as recorded in Volume 049 of Plats, page 044, records of King County, Washington

DODDS HI-LINE HOMES ADD, as recorded in Volume 048 of Plats, page 086, records of King County, Washington

EL CAMINO ADD, as recorded in Volume 051 of Plats, page 083, records of King County, Washington

EMONDALE ADD, as recorded in Volume 021 of Plats, page 057, records of King County, Washington

EVANSVALE ADD, as recorded in Volume 032 of Plats, page 021, records of King County, Washington

EVERGREEN-SITES, as recorded in Volume 070 of Plats, page 049, records of King County, Washington

FENTON WOOD ADD, as recorded in Volume 072 of Plats, page 079, records of King County, Washington

FERRYS C P PLAT, as recorded in Volume 001 of Plats, page 257, records of King County, Washington

FLORENCE ACRES ADD, as recorded in Volume 049 of Plats, page 017, records of King County, Washington

FONIS SPIROS ADD, as recorded in Volume 055 of Plats, page 029, records of King County, Washington

GENEVIEVE PARK ADD, as recorded in Volume 020 of Plats, page 086, records of King County, Washington

GILLUM HILLTOP TRS, as recorded in Volume 049 of Plats, page 006, records of King County, Washington

GLADLEE ADD, as recorded in Volume 083 of Plats, page 067, records of King County, Washington

GLENNIS PARK ADD, as recorded in Volume 053 of Plats, page 025, records of King County, Washington

GLENVIEW TERRACE ADD, as recorded in Volume 053 of Plats, page 095, records of King County, Washington

GREGORY HEIGHTS DIV NO. 01, as recorded in Volume 023 of Plats, page 044, records of King County, Washington

Attachment A

GREGORY HEIGHTS DIV NO. 02, as recorded in Volume 024 of Plats, page 004, records of King County, Washington

GREGORY HEIGHTS DIV NO. 03, as recorded in Volume 024 of Plats, page 027, records of King County, Washington

GREGORY HEIGHTS PARK ADD, as recorded in Volume 049 of Plats, page 015, records of King County, Washington

GREGORY HOMES ADD, as recorded in Volume 052 of Plats, page 051, records of King County, Washington

GREGORY MANOR ADD, as recorded in Volume 054 of Plats, page 048, records of King County, Washington

GREGORY MANOR NO. 02, as recorded in Volume 056 of Plats, page 092, records of King County, Washington

GUNTHERS BUENA VISTA TRS, as recorded in Volume 021 of Plats, page 044, records of King County, Washington

GUNTHERS HIGHLAND VIEW TRS, as recorded in Volume 019 of Plats, page 064, records of King County, Washington

GUNTHERS LAKE BURIEN HOME SITES, as recorded in Volume 021 of Plats, page 059, records of King County, Washington

HAHNS V I ADD, as recorded in Volume 035 of Plats, page 018, records of King County, Washington

HALL JOAN C ACRE TRS, as recorded in Volume 902 of Plats, page 099, records of King County, Washington

HALLS FRED C 1ST ADD, as recorded in Volume 032 of Plats, page 042, records of King County, Washington

HAMILTON HEIGHTS ADD, as recorded in Volume 051 of Plats, page 095, records of King County, Washington

HAMILTON HEIGHTS NO. 02, as recorded in Volume 054 of Plats, page 005, records of King County, Washington

HAMILTON HEIGHTS NO. 03, as recorded in Volume 057 of Plats, page 050, records of King County, Washington

HAMILTON HEIGHTS NO. 04, as recorded in Volume 058 of Plats, page 062, records of King County, Washington

HASSELL ADD, as recorded in Volume 046 of Plats, page 084, records of King County, Washington

HAZEL VALLEY, as recorded in Volume 902 of Plats, page 102, records of King County, Washington

HAZEL VALLEY TERRACE ADD, as recorded in Volume 047 of Plats, page 095, records of King County, Washington

HEADS 1/4 ACRE TRS, as recorded in Volume 023 of Plats, page 018, records of King County, Washington

HENRY ADD, as recorded in Volume 046 of Plats, page 046, records of King County, Washington

HIGGINS ADD, as recorded in Volume 057 of Plats, pages 082 through 083, records of King County, Washington

Attachment A

HIGHLINE MED ARTD BLDG, as recorded in Volume 197 of Plats, pages 055 through 057, records of King County, Washington

HIGHPOINTER, as recorded in Volume 14 of Plats, pages 4 through 8, records of King County, Washington

HILL VISTA, as recorded in Volume 074 of Plats, pages 077 through 078, records of King County, Washington

HILLCREST VIEW HEIGHTS ADD, as recorded in Volume 074 of Plats, page 055, records of King County, Washington

HOLLYHURST RPLT OF MARSHALLS LK B TRS, as recorded in Volume 021 of Plats, page 097, records of King County, Washington

HUGHES ESTATES NO. 01, as recorded in Volume 073 of Plats, page 011, records of King County, Washington

HUGHES SHOREWOOD ADD, as recorded in Volume 062 of Plats, page 086, records of King County, Washington

HUGHES TRS, as recorded in Volume 052 of Plats, page 094, records of King County, Washington

HURSTWOOD 1ST DIV, as recorded in Volume 059 of Plats, pages 085 through 086, records of King County, Washington

HURSTWOOD SECOND ADD, as recorded in Volume 063 of Plats, page 019, records of King County, Washington

INMO ESTATES, as recorded in Volume 177 of Plats, pages 038 through 039, records of King County, Washington

INVERNESS HEIGHTS ADD, as recorded in Volume 041 of Plats, page 039, records of King County, Washington

J & J RANCH HOMES ADD, as recorded in Volume 056 of Plats, page 001, records of King County, Washington

JINIWOOD ADD, as recorded in Volume 075 of Plats, page 007, records of King County, Washington

JONES VIEW TRS, as recorded in Volume 047 of Plats, pages 014 through 015, records of King County, Washington

JORDANS ACRE GARDENS ADD, as recorded in Volume 007 of Plats, page 084, records of King County, Washington

KATHRYN APARTMENTS, as recorded in Volume 018 of Plats, pages 015 through 016, records of King County, Washington

KAYS ADD, as recorded in Volume 060 of Plats, page 001, records of King County, Washington

KENNEDY VISTA, as recorded in Volume 106 of Plats, pages 088 through 089, records of King County, Washington

KERRS SUBURBAN VILLA ONE-ACRE TRACTS, as recorded in Volume 007 of Plats, page 004, records of King County, Washington

KESSLER SYLVAN VILLA TRACTS, as recorded in Volume 902 of Plats, page 125, records of King County, Washington

KRISTI APARTMENTS, as recorded in Volume 031 of Plats, pages 044 through 045, records of King County, Washington

Attachment A

KROHN ESTATES, as recorded in Volume 111 of Plats, page 101, records of King County, Washington

LABRI, as recorded in Volume 093 of Plats, pages 093 through 096, records of King County, Washington

LAKE BURIEN ESTATES, as recorded in Volume 053 of Plats, pages 007 through 011, records of King County, Washington

LAKE BURIEN TERRACE, as recorded in Volume 079 of Plats, pages 049, records of King County, Washington

LAKE BURIEN WATERFRONT TRS, as recorded in Volume 026 of Plats, page 014, records of King County, Washington

LAKEWOOD TERRACE ADD, as recorded in Volume 048 of Plats, page 078, records of King County, Washington

LAMBERTS ORCHARD ADD, as recorded in Volume 055 of Plats, page 088, records of King County, Washington

LATHROPS JAMES A TRS, as recorded in Volume 902 of Plats, page 149, records of King County, Washington

LAURELWOOD, as recorded in Volume 045 of Plats, pages 033 through 035, records of King County, Washington

LEE ANNA ADD, as recorded in Volume 066 of Plats, page 003, records of King County, Washington

LEONARD ADD, as recorded in Volume 050 of Plats, page 068, records of King County, Washington

LEONARDS GREGORY HEIGHTS DIV, as recorded in Volume 049 of Plats, page 016, records of King County, Washington

LINDE & HILL PARK ADD, as recorded in Volume 041 of Plats, page 007, records of King County, Washington

LINDE & HILL PARK NO. 02, as recorded in Volume 042 of Plats, page 004, records of King County, Washington

LINDE & HILL PARK NO. 03, as recorded in Volume 045 of Plats, page 060, records of King County, Washington

LINDE & HILL PARK NO. 04, as recorded in Volume 046 of Plats, page 047, records of King County, Washington

LINDE & HILL PARK NO. 05, as recorded in Volume 052 of Plats, pages 043 through 044, records of King County, Washington

LINDE & LEE PARK ADD, as recorded in Volume 046 of Plats, page 076, records of King County, Washington

LINDE & LEE PARK NO. 02, as recorded in Volume 047 of Plats, page 051, records of King County, Washington

LINDE TERRACE ADD, as recorded in Volume 038 of Plats, page 039, records of King County, Washington

LINDE TERRACE NO. 02 REPLAT, as recorded in Volume 039 of Plats, page 013, records of King County, Washington

LINDE TERRACE NO. 03, as recorded in Volume 039 of Plats, page 026, records of King County, Washington

LINDE TERRACE NO. 04, as recorded in Volume 039 of Plats, page 034, records of King County, Washington

LINDE-ERBES HEIGHTS ADD, as recorded in Volume 045 of Plats, page 069, records of King County, Washington

Attachment A

LLOYDS MANHATTAN ADD, as recorded in Volume 088 of Plats, page 034, records of King County, Washington

LOUISA PARK ADD, as recorded in Volume 051 of Plats, page 099, records of King County, Washington

LOWES TERRACE NO. 07, as recorded in Volume 050 of Plats, page 063, records of King County, Washington

LOWES TERRACE NO. 10, as recorded in Volume 052 of Plats, page 075, records of King County, Washington

LYNMAR ADD, as recorded in Volume 022 of Plats, page 057, records of King County, Washington

LYNMAR NO. 02, as recorded in Volume 022 of Plats, page 068, records of King County, Washington

LYNMAR NO. 03, as recorded in Volume 023 of Plats, page 026, records of King County, Washington

MACLEANS ALLAN 2ND ADD, as recorded in Volume 039 of Plats, page 030, records of King County, Washington

MADRONA SLOPE DIV NO. 01, as recorded in Volume 073 of Plats, page 085, records of King County, Washington

MADRONA SLOPE DIV NO. 02, as recorded in Volume 074 of Plats, pages 053 through 054, records of King County, Washington

MAGNUSON ADD, as recorded in Volume 044 of Plats, page 051, records of King County, Washington

MANHATTAN LANE ADD, as recorded in Volume 079 of Plats, page 015, records of King County, Washington

MANHATTAN PARK ADD, as recorded in Volume 068 of Plats, page 010, records of King County, Washington

MANHATTAN RIDGE ADD, as recorded in Volume 064 of Plats, page 055, records of King County, Washington

MANHATTAN VILLAGE ADD, as recorded in Volume 050 of Plats, page 024, records of King County, Washington

MAPLETON MANOR ADD, as recorded in Volume 077 of Plats, page 008, records of King County, Washington

MAPLEWILD TERRACES ADD, as recorded in Volume 045 of Plats, pages 094 through 095, records of King County, Washington

MAYBROOK ADD, as recorded in Volume 045 of Plats, page 066, records of King County, Washington

MAYBROOK PARK ADD, as recorded in Volume 053 of Plats, page 050, records of King County, Washington

MC INTYRES ADD, as recorded in Volume 053 of Plats, page 038, records of King County, Washington

MC KAYS ADD, as recorded in Volume 062 of Plats, pages 081 through 082, records of King County, Washington

MERLIN PARK ADD, as recorded in Volume 007 of Plats, page 042, records of King County, Washington

MILLER COURT, as recorded in Volume 192 of Plats, pages 088 through 089, records of King County, Washington

NESS JOHN T ADD, as recorded in Volume 065 of Plats, page 022, records of King County, Washington

