

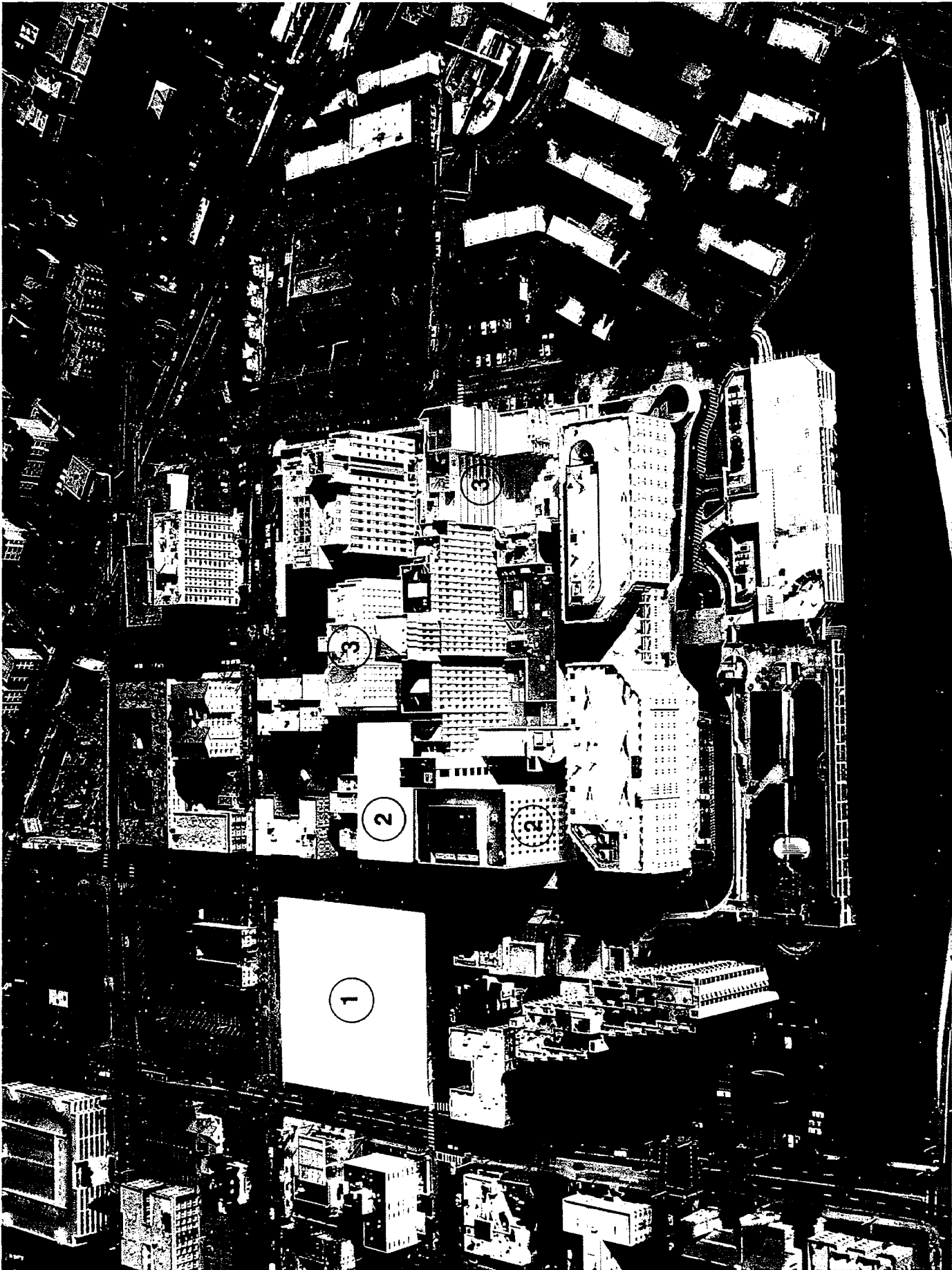

3008

MIN





Maleng Building:

- 252,192 sf
- 21,000 sf foot print
- 50 additional beds
- 10 levels above street
- 2 levels below street
- Tunnel connections to NJB and North Wing
- Skybridge connect at each level 4-10



Norm Maleng Building Planning Flexibility

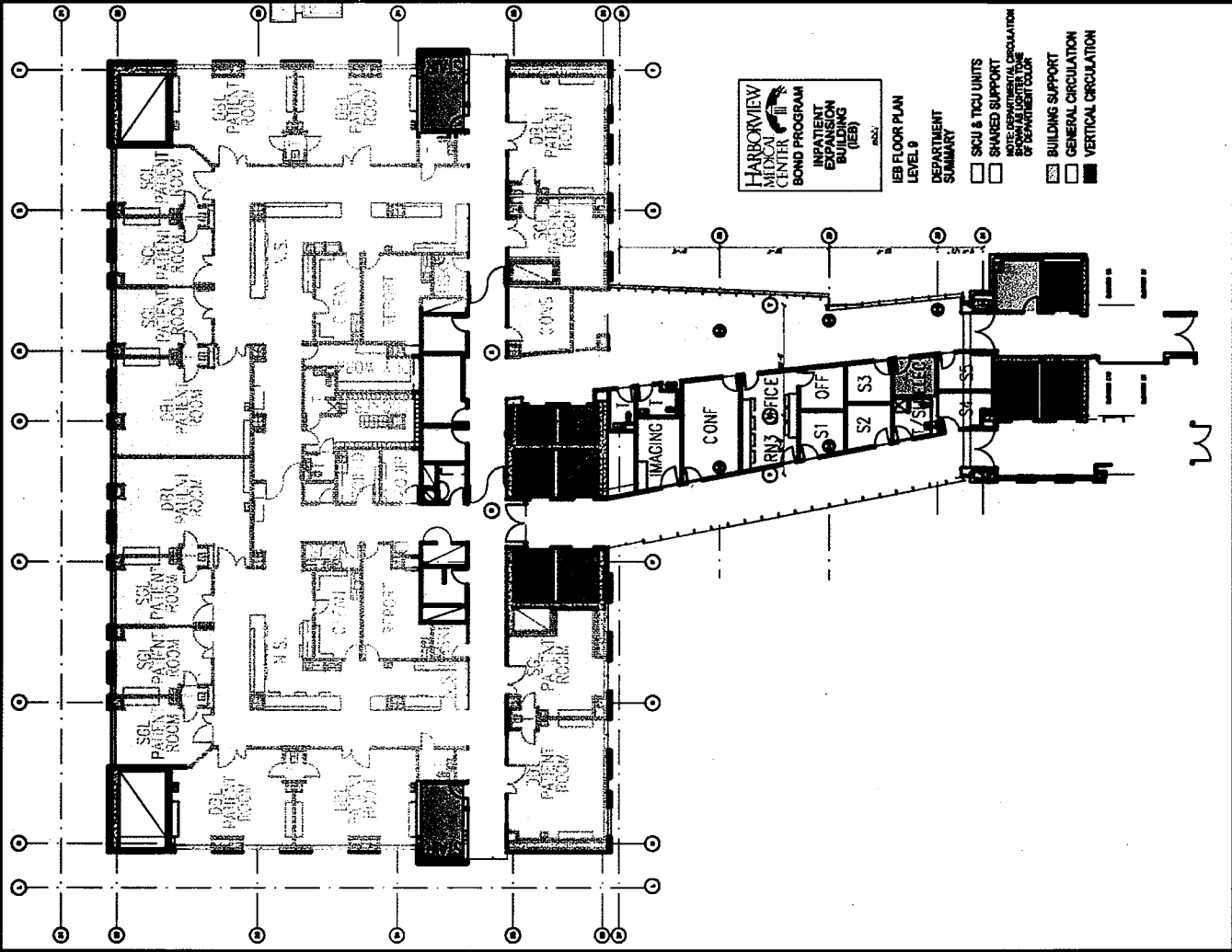

Seismic Damper

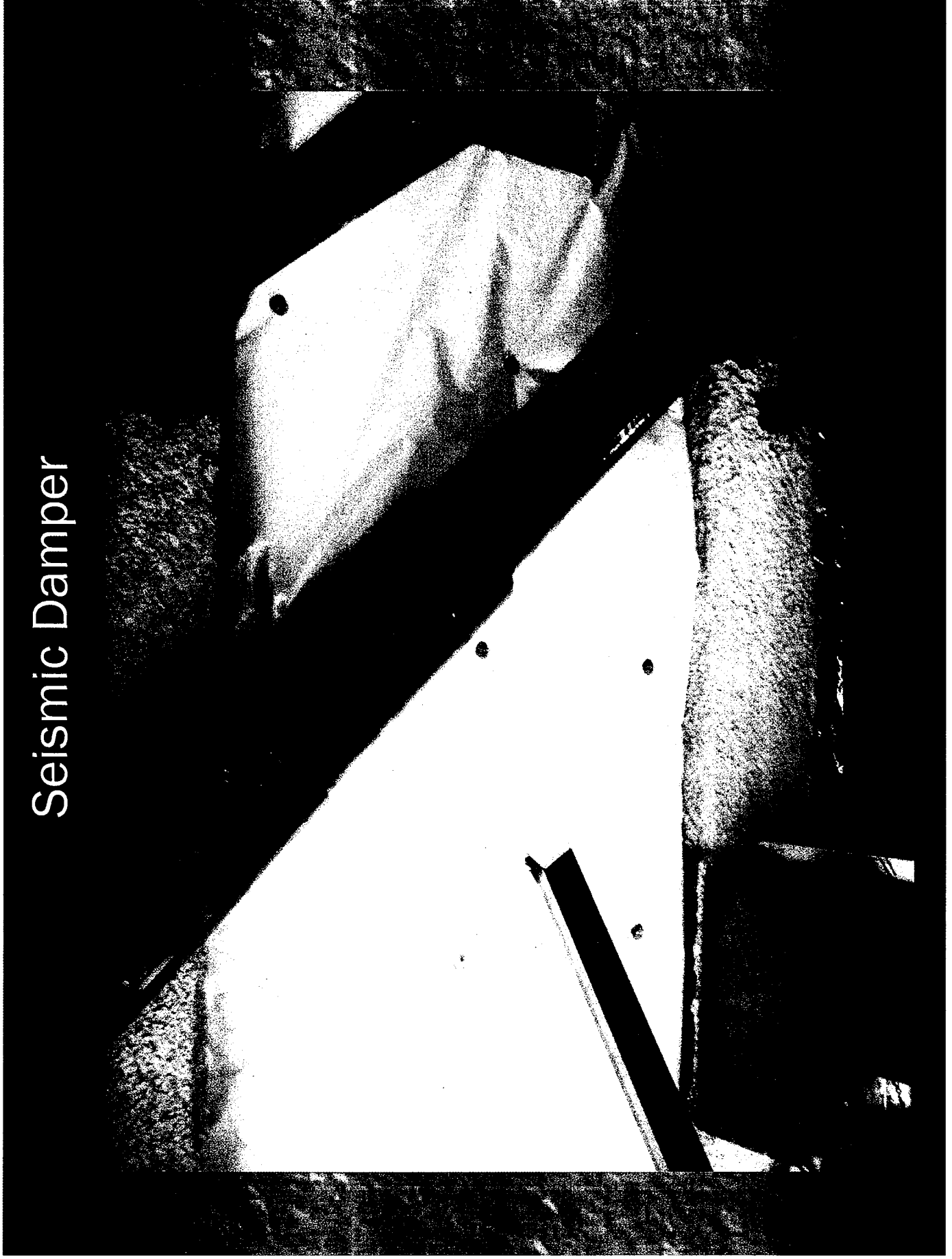

Harborview Medical Center

Sun Shades on South Side

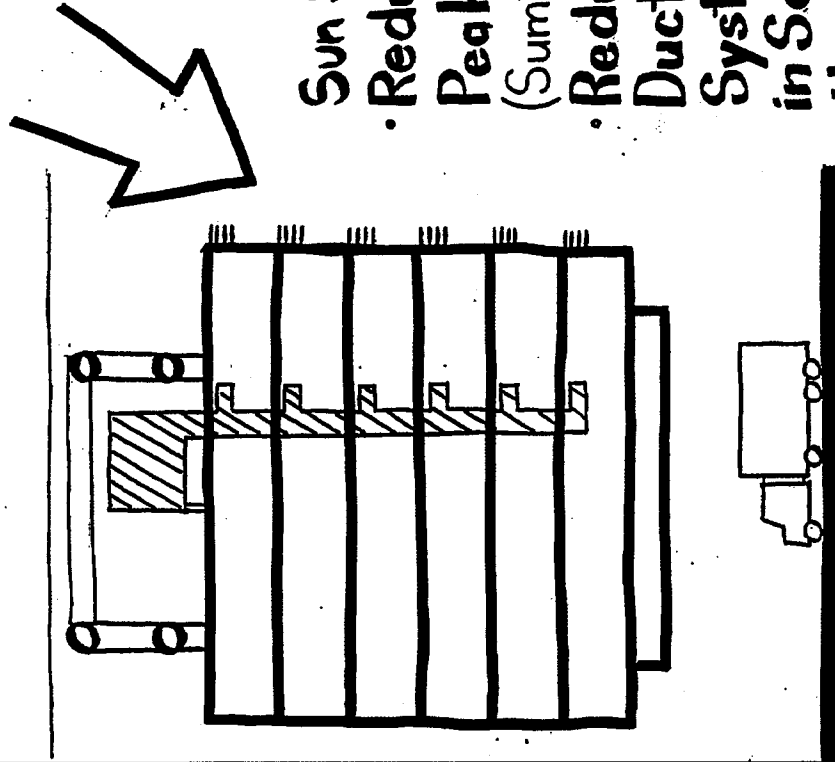

- Sun Shades =
- Reduction to Peak Heat Load (Summer South Sun)
 - Reduction to Ductwork & Mech Systems results in Savings Greater than the Cost of the Sun Shades

Harborview Medical Center

Cooling for Computer Equipment

is used to Preheat Water & Air

- Server Rms.
- Elevator Equip. Rms.
- MDF Rooms
- IDF Rooms

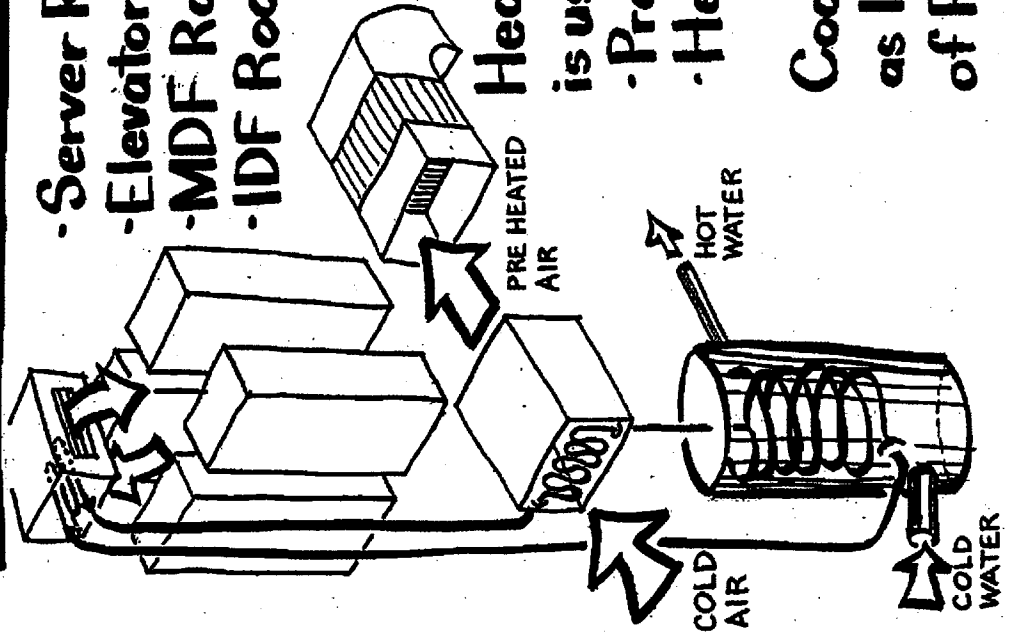

Heat from Computer

is used to:

- Pre heat Air
- Heat Water

Cooling can be as much
as 100 tons = Equivalent
of Power used by 10 homes

Harborview Medical Center

100% Outside Air

- Excellent Indoor Air Quality
- Best Infection Control Precaution

Commissioning - For all systems

Insulation & Moisture Control

- Tough Criteria Rigorously Enforced in Construction

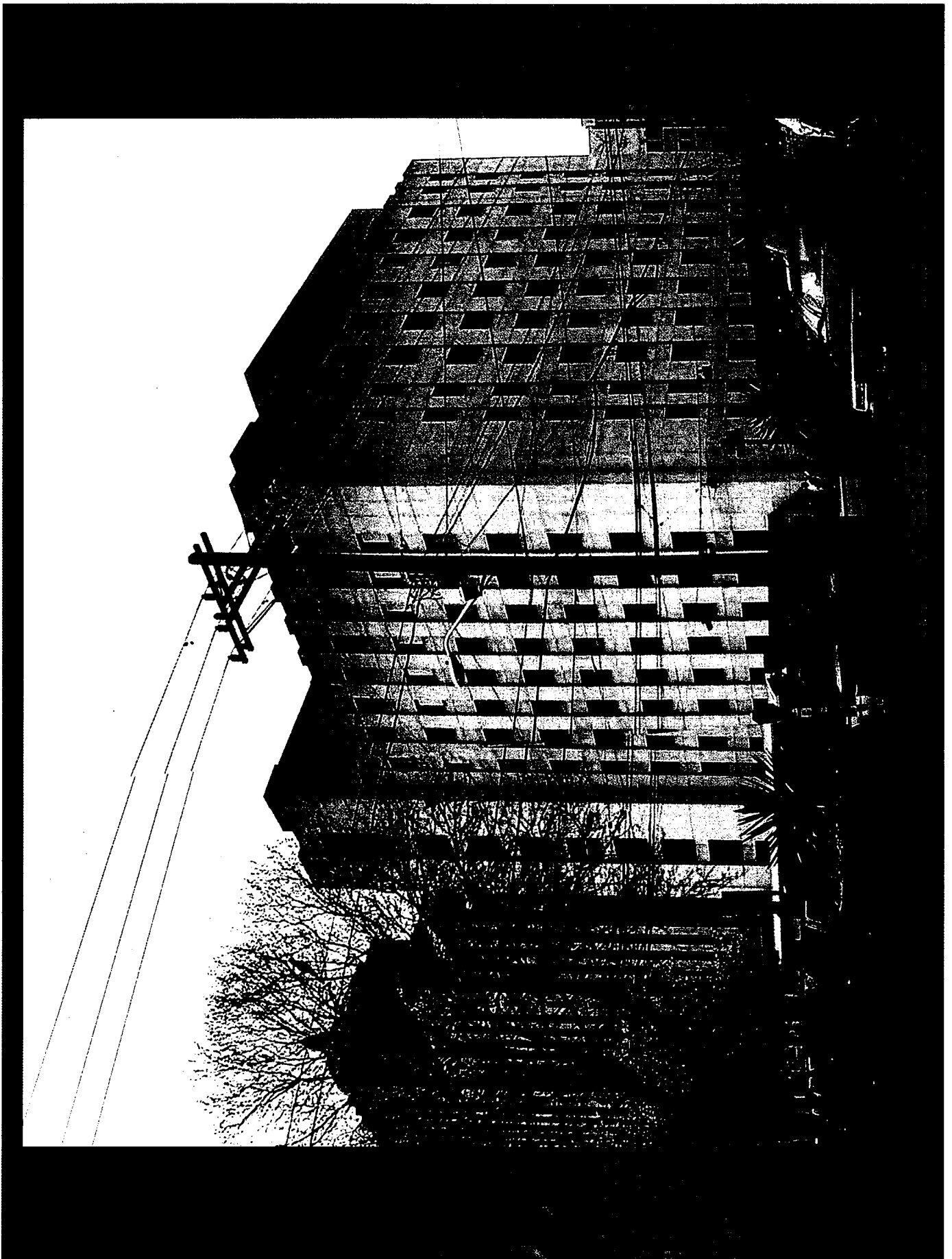

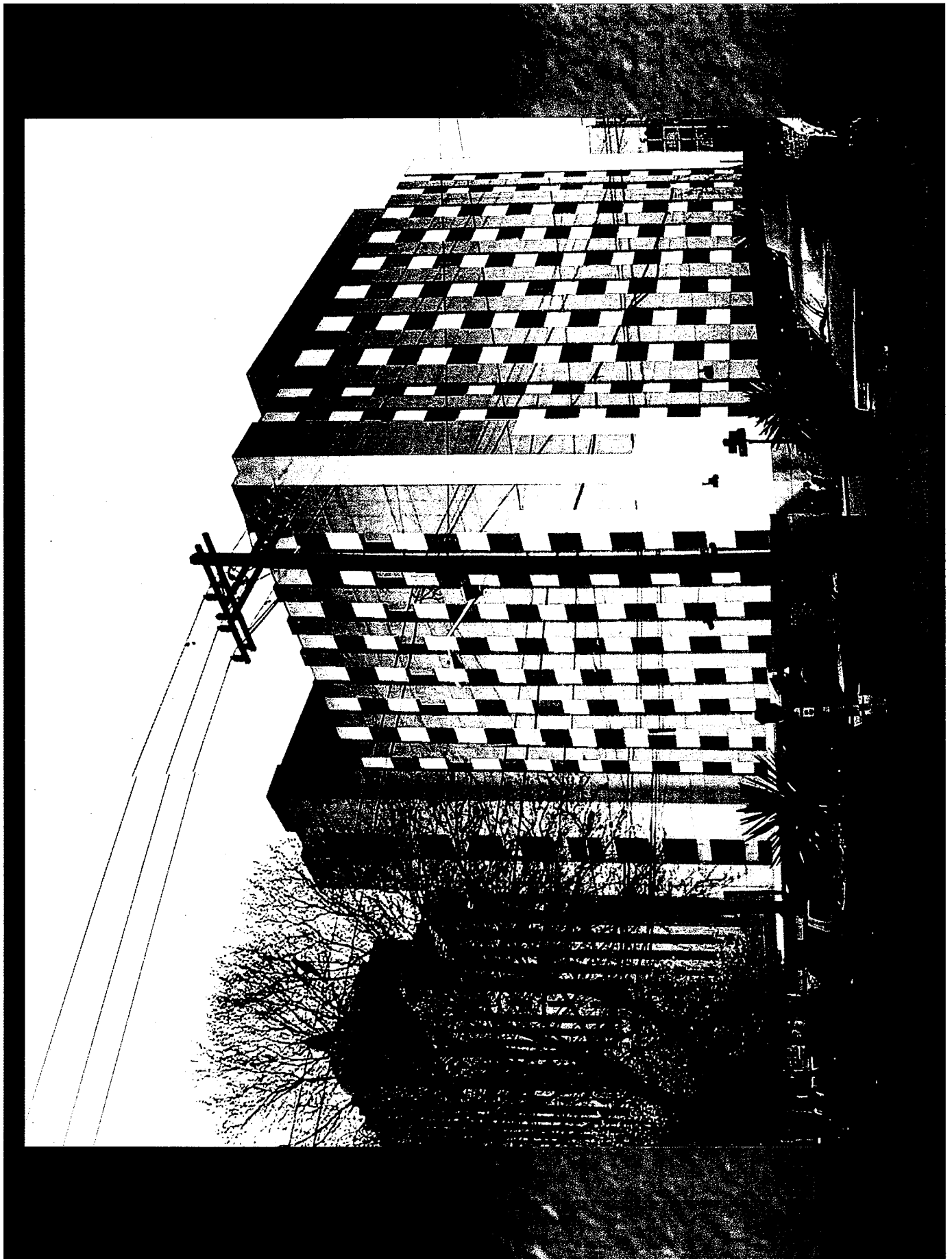

Panels Are Tested Without FRP

