



KING COUNTY

1200 King County Courthouse
516 Third Avenue
Seattle, WA 98104

Signature Report

April 30, 2007

Ordinance 15736

Proposed No. 2007-0232.1

Sponsors Gossett

1 AN ORDINANCE adopting the revision of voting
2 precincts of King County for the year 2007.

3

4 BE IT ORDAINED BY THE COUNCIL OF KING COUNTY:

5 SECTION 1. Pursuant to K.C.C. 1.12.010.E and RCW 29A.16.040, the 2007
6 revisions and alterations to the King County voting precincts as contained in the
7 attachments to this ordinance are adopted and shall constitute an amendment to the

8 official list of county voting precincts maintained by the records, elections and licensing
9 services division.

10

Ordinance 15736 was introduced on 4/16/2007 and passed by the Metropolitan King
County Council on 4/30/2007, by the following vote:

Yes: 9 - Mr. Gossett, Ms. Patterson, Ms. Lambert, Mr. von Reichbauer, Mr.
Dunn, Mr. Ferguson, Mr. Phillips, Ms. Hague and Mr. Constantine
No: 0
Excused: 0

KING COUNTY COUNCIL
KING COUNTY, WASHINGTON

Larry Gossett, Chair

ATTEST:

Anne Noris, Clerk of the Council

APPROVED this 8 day of May, 2007.

Ron Sims, County Executive

RECEIVED
2007 MAY 10 PM 12:46
KING COUNTY COUNCIL

Attachments A. 2007 Voting Precinct Alteration Summary: Council District Composite, B. 2007
Precinct Summary Report--Sorted by King County Council District, C. Precinct Maps

**2007 VOTING PRECINCT ALTERATION SUMMARY:
COUNCIL DISTRICT COMPOSITE**

The following is a summary of the precinct changes made in the 2007 Precinct Alteration Project:

Precincts altered	59
Precincts added	14
Precincts abolished	16
Net gain/loss of precincts	-2

Changes by Council District:

Council District	Altered	Added	Abolished
1	3	0	1
2	4	0	3
3	10	4	2
4	3	0	3
5	7	2	2
6	4	0	3
7	4	1	0
8	2	0	1
9	22	7	1

3/15/2007

2007 Precinct Summary Report

Sorted by King County Council District

15736

ATTACHMENT B

New Code	New Name	LEG	CONG	KCC	Old Code	Old Name
2217	SEA 46-2217	46	1	1	2217	SEA 46-2217
2218	SEA 46-2218	46	1	1	2217	SEA 46-2217
2218	SEA 46-2218	46	1	1	2218	SEA 46-2218
2319	SEA 46-2319	46	7	1	2319	SEA 46-2319
2319	SEA 46-2319	46	7	1	2376	SEA 46-2376*
0271	BROKEN HILL	37	7	2	0271	BROKEN HILL
0271	BROKEN HILL	37	7	2	0541	IRMA*
2025	SEA 43-2025	43	7	2	2022	SEA 43-2022*
2025	SEA 43-2025	43	7	2	2025	SEA 43-2025
2028	SEA 43-2028	43	7	2	2022	SEA 43-2022*
2028	SEA 43-2028	43	7	2	2028	SEA 43-2028
2115	SEA 43-2115	43	7	2	2053	SEA 43-2053*
2115	SEA 43-2115	43	7	2	2115	SEA 43-2115
2653	BIG BEND	45	8	3	2653	BIG BEND
0544	ISS 05-0544	5	8	3	0544	ISS 05-0544
0544	ISS 05-0544	5	8	3	2807	ISS 05-2807*
3464	ISS 05-3464	5	8	3	3464	ISS 05-3464
3527	ISS 05-3527	5	8	3	3464	ISS 05-3464
3145	ISS 41-3145	41	8	3	3145	ISS 41-3145
3533	ISS 41-3533	41	8	3	3145	ISS 41-3145
2733	ISS 48-2733	48	8	3	2574	ISS 48-2574*
2733	ISS 48-2733	48	8	3	2733	ISS 48-2733
3522	WELCOME LAKE	45	8	3	2653	BIG BEND
3270	WOD 45-3270	45	1	3	3270	WOD 45-3270
3530	WOD 45-3530	45	1	3	3270	WOD 45-3270
1805	SEA 36-1805	36	7	4	1804	SEA 36-1804*
1805	SEA 36-1805	36	7	4	1805	SEA 36-1805
1845	SEA 43-1845	43	7	4	1844	SEA 43-1844*
1845	SEA 43-1845	43	7	4	1845	SEA 43-1845
2000	SEA 43-2000	43	7	4	2000	SEA 43-2000
2000	SEA 43-2000	43	7	4	2005	SEA 43-2005*
0362	DES 33-0362	33	9	5	0362	DES 33-0362
0362	DES 33-0362	33	9	5	3277	DES 33-3277*
0363	DES 33-0363	33	9	5	0363	DES 33-0363
0363	DES 33-0363	33	9	5	3277	DES 33-3277*
3445	KEN 33-3445	33	8	5	3274	KEN 33-3274*
3445	KEN 33-3445	33	8	5	3445	KEN 33-3445
2490	KEN 47-2490	47	8	5	2490	KEN 47-2490
3537	KEN 47-3537	47	8	5	2490	KEN 47-2490
2472	RNT 11-2472	11	9	5	2472	RNT 11-2472
3535	RNT 11-3535	11	9	5	2472	RNT 11-2472
0201	BEL 41-0201	41	8	6	0200	BEL 41-0200*
0201	BEL 41-0201	41	8	6	0201	BEL 41-0201
0203	BEL 41-0203	41	8	6	0200	BEL 41-0200*
0203	BEL 41-0203	41	8	6	0203	BEL 41-0203
0212	BEL 48-0212	48	8	6	0212	BEL 48-0212
0212	BEL 48-0212	48	8	6	0215	BEL 48-0215*
0212	BEL 48-0212	48	8	6	2431	BEL 48-2431*
2776	BEL 48-2776	48	8	6	0212	BEL 48-0212
2776	BEL 48-2776	48	8	6	2776	BEL 48-2776
3457	FISHER	47	8	7	3457	FISHER

2007 Precinct Summary Report

Sorted by King County Council District

15736

ATTACHMENT B

New Code	New Name	LEG	CONG	KCC	Old Code	Old Name
3457	FISHER	47	8	7	3456	SEDGE
3523	KENTLAKE	47	8	7	2741	SAWYER
2741	SAWYER	47	8	7	2741	SAWYER
3456	SEDGE	47	8	7	3456	SEDGE
0956	REGAL	34	7	8	0956	REGAL
0956	REGAL	34	7	8	1215	WHITE CENTER
1215	WHITE CENTER	34	7	8	0508	HEIGHTS*
1215	WHITE CENTER	34	7	8	1215	WHITE CENTER
3525	BRIARWOOD	41	8	9	2606	HUSKY
3525	BRIARWOOD	41	8	9	1183	VALENCIA
0293	CARRIAGE LANE	47	8	9	0293	CARRIAGE LANE
0300	CEDAR PARK	41	8	9	0300	CEDAR PARK
0300	CEDAR PARK	41	8	9	2804	DANIEL
2804	DANIEL	41	8	9	2804	DANIEL
0404	ELLIOTT	5	8	9	0404	ELLIOTT
0404	ELLIOTT	5	8	9	0822	MORRIS
0413	ENM 31-0413	31	8	9	0413	ENM 31-0413
0413	ENM 31-0413	31	8	9	0414	ENM 31-0414*
0413	ENM 31-0413	31	8	9	0418	ENM 31-0418
0418	ENM 31-0418	31	8	9	0418	ENM 31-0418
2459	FAIRHAVEN	5	8	9	2459	FAIRHAVEN
3526	FAIRMONT GLEN	5	8	9	2459	FAIRHAVEN
3526	FAIRMONT GLEN	5	8	9	0822	MORRIS
3526	FAIRMONT GLEN	5	8	9	3509	WOODSIDE
2606	HUSKY	41	8	9	2606	HUSKY
3534	LOUIE	47	8	9	0293	CARRIAGE LANE
3532	MAPLE RIDGE	47	8	9	0932	RAVENSDALE
0822	MORRIS	5	8	9	0822	MORRIS
2614	M-V 05-2614	5	8	9	2614	M-V 05-2614
3536	M-V 05-3536	5	8	9	2614	M-V 05-2614
0840	NEW 41-0840	41	8	9	0840	NEW 41-0840
3528	NEW 41-3528	41	8	9	0840	NEW 41-0840
3529	NEW 41-3529	41	8	9	0840	NEW 41-0840
0932	RAVENSDALE	47	8	9	0932	RAVENSDALE
1142	TANYA	41	8	9	1142	TANYA
1183	VALENCIA	41	8	9	2606	HUSKY
1183	VALENCIA	41	8	9	1142	TANYA
1183	VALENCIA	41	8	9	1183	VALENCIA
3509	WOODSIDE	5	8	9	3509	WOODSIDE

15736

2007 PRECINCT ALTERATIONS

Code	Precinct Name	LG	CG	CC	JU
2217	SEA 46-2217	46	1	1	W
2217	SEA 46-2217	46	1	1	W

Attachment C

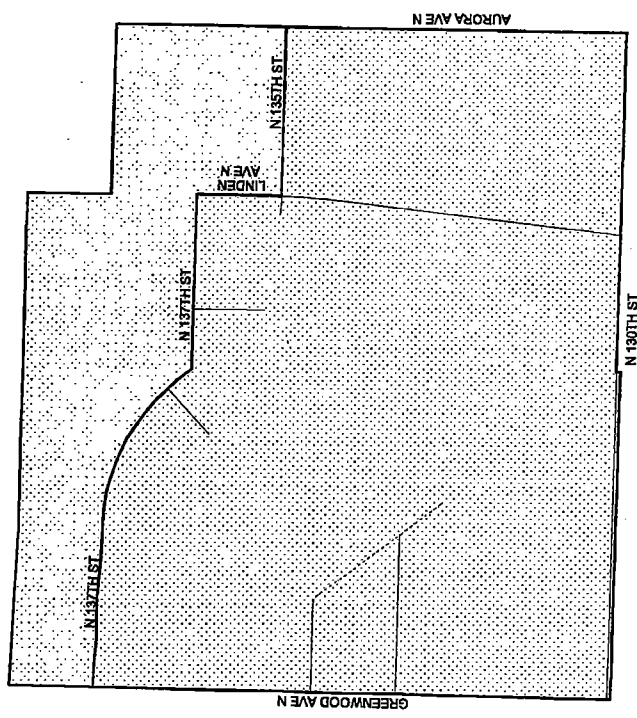

Legislative District Boundaries
 Congressional District Boundaries
 Council District Boundaries
 New Precinct
 Old Precinct



Census Tract	Kroll Page	Title	S-T-R
000401	219		19-26-04

2007-232

2007 PRECINCT ALTERATIONS

Code	Precinct Name	LG	CG	CC	JU
2218	SEA 46-2218	46	1	1	W
2218	SEA 46-2218	46	1	1	W
2217	SEA 46-2217	46	1	1	W

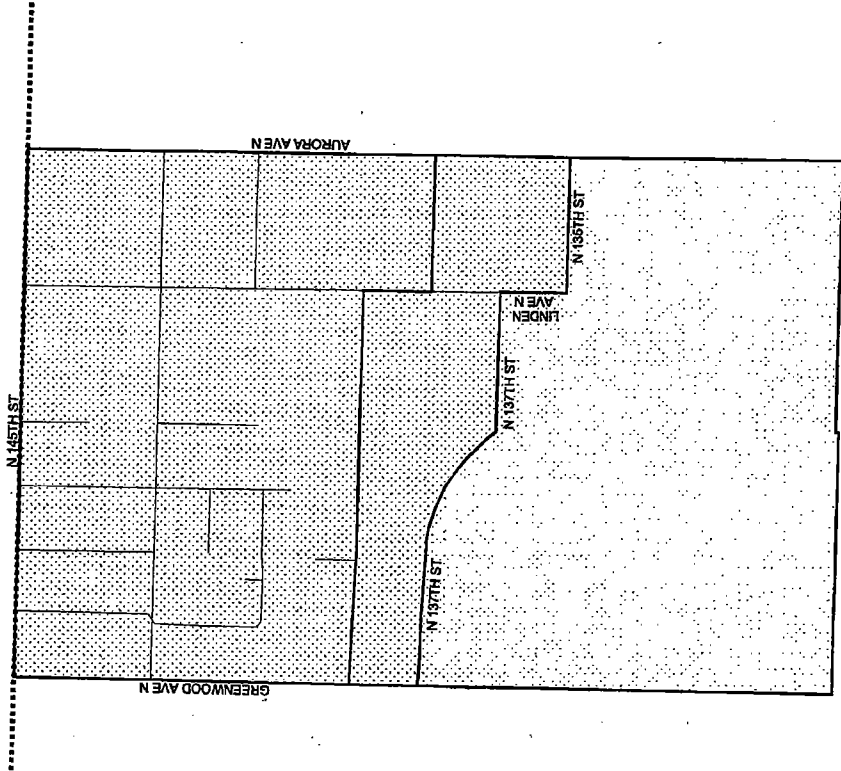

Legislative District Boundaries
 Congressional District Boundaries
 Council District Boundaries
 New Precinct
 Old Precinct

N
 0 0.2 Miles

Census Tract	Kroll Page	Title	S-T-R
000401	219		19-26-04

2007 PRECINCT ALTERATIONS

Code	Precinct Name	LG	CG	CC	JU
2319	SEA 46-2319	46	7	1	W
2319	SEA 46-2319	46	7	1	W
2376	SEA 46-2376*	46	7	1	W

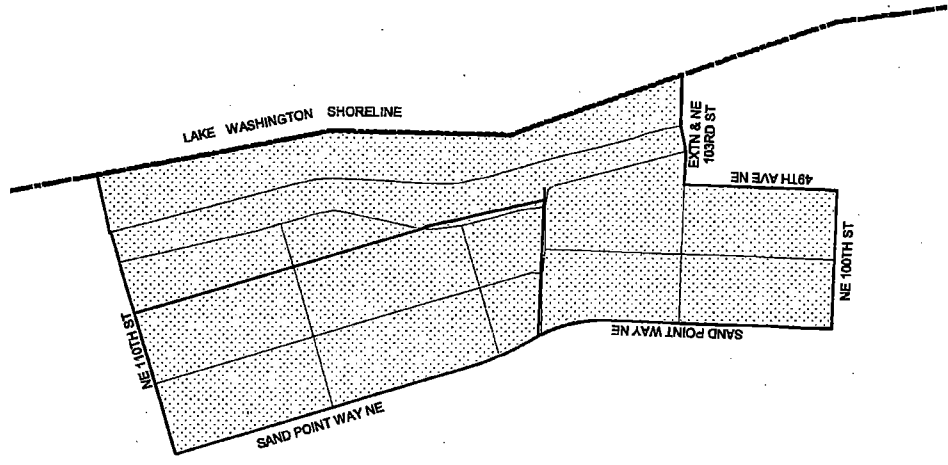

- Legislative District Boundaries
- Congressional District Boundaries
- Council District Boundaries
- New Precinct
- ▨ Old Precinct



Census Tract	Kroll Page	Title	S-T-R
000900	235		34-26-04

15736

2007 PRECINCT ALTERATIONS

Code	Precinct Name	LG	CG	CC	JU
0271	BROKEN HILL	37	7	2	SE
0271	BROKEN HILL	37	7	2	SE
0541	IRMA*	37	7	2	SE

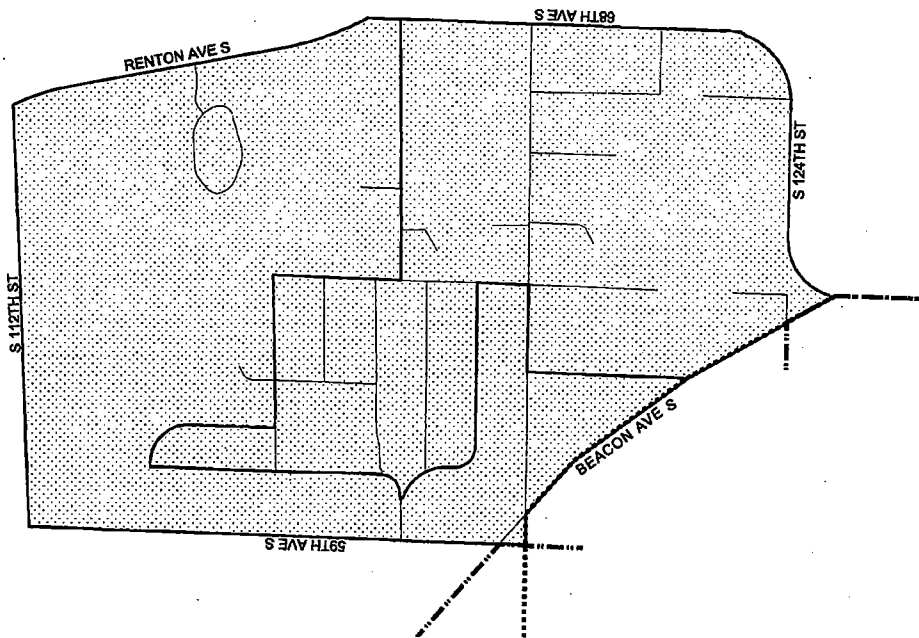

Census Tract	Kroll Page	Title	S-T-R
026100	316		11-23-04

15736

2007 PRECINCT ALTERATIONS

Code	Precinct Name	IG	CG	CC	JU
2025	SEA 43-2025	43	7	2	W
2025	SEA 43-2025	43	7	2	W
2022	SEA 43-2022*	43	7	2	W

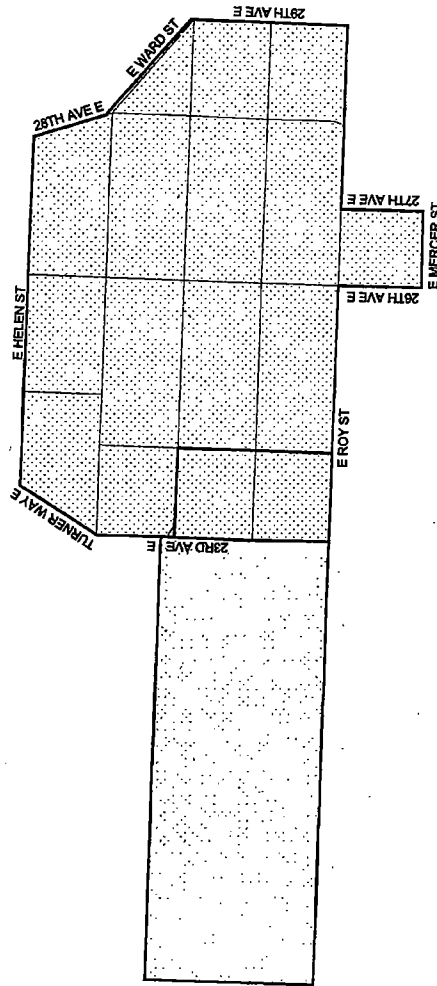

- Legislative District Boundaries
- Congressional District Boundaries
- Council District Boundaries
- New Precinct
- Old Precinct



Census Tract	Kroll Page	Title	S-T-R
006400	37		28-25-04

15736

2007 PRECINCT ALTERATIONS

Code	Precinct Name	IG	CG	CC	JU
2028	SEA 43-2028	43	7	2	W
2028	SEA 43-2028	43	7	2	W
2022	SEA 43-2022*	43	7	2	W

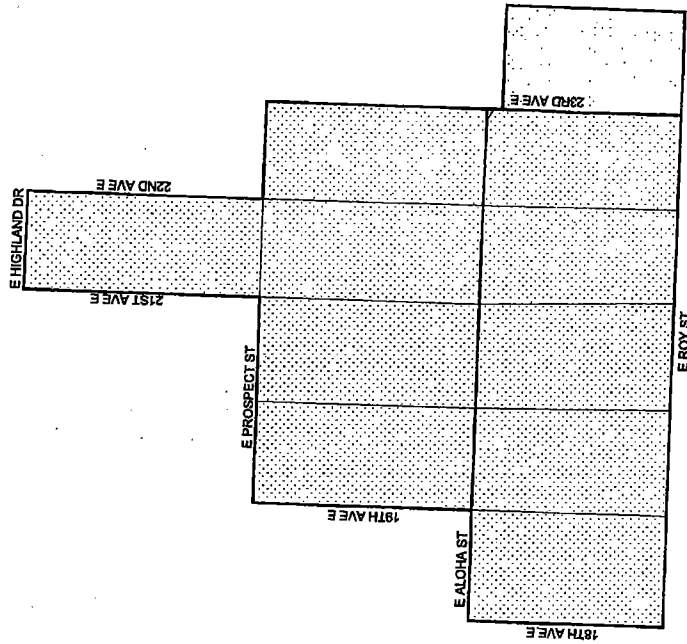

Legislative District Boundaries
 Congressional District Boundaries
 Council District Boundaries
 New Precinct
 Old Precinct



Census Tract	Kroll Page	Title	S-T-R
006400	37		28-25-04

15736

2007 PRECINCT ALTERATIONS

Code	Precinct Name	LG	CG	CC	JU
2115	SEA 43-2115	43	7	2	W
2053	SEA 43-2053*	43	7	2	W
2115	SEA 43-2115	43	7	2	W

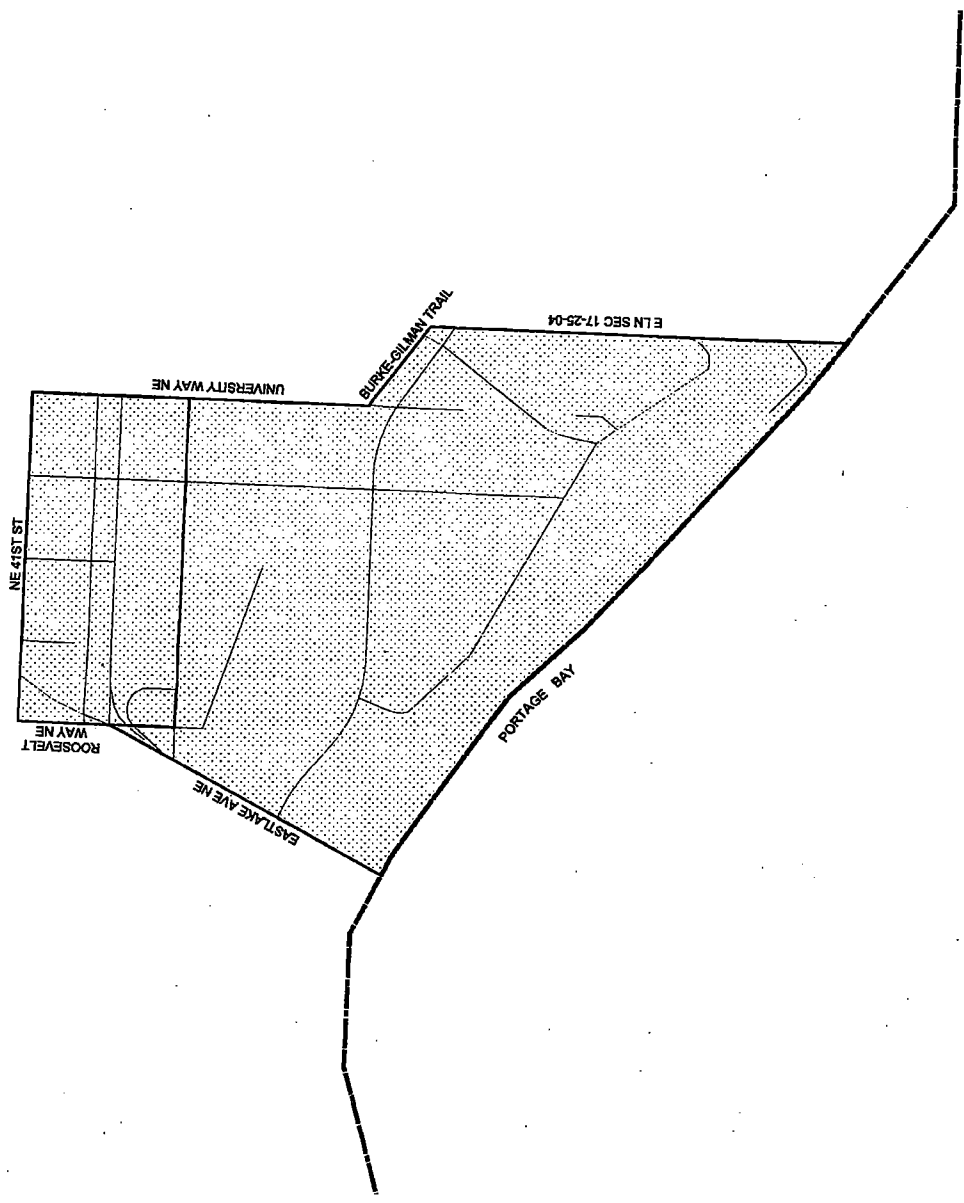

Census Tract	Kroll Page	Title	S-T-R
005302	23		17-25-04

15736

2007 PRECINCT ALTERATIONS

Code	Precinct Name	LG	CG	CC	JU
2653	BIG BEND	45	8	3	NE
2653	BIG BEND	45	8	3	NE

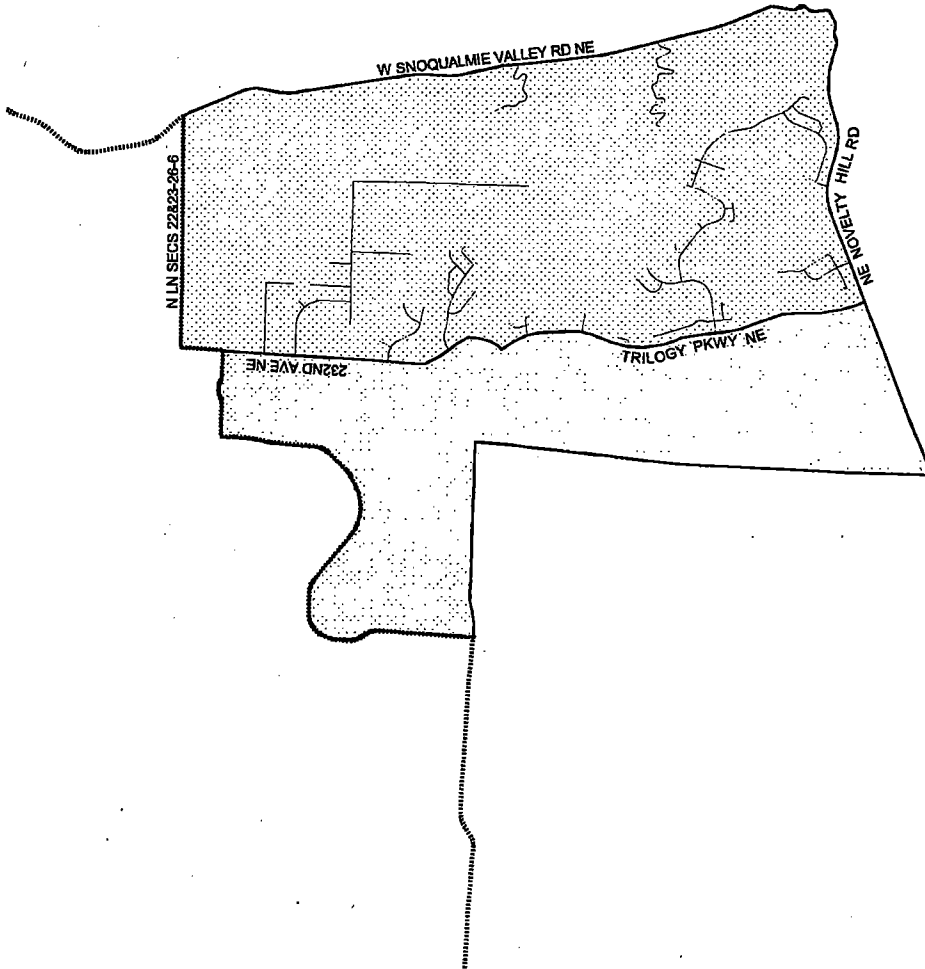

Census Tract	Kroll Page	Title	S-T-R
032312	921		22-26-06

15736

2007 PRECINCT ALTERATIONS

Code	Precinct Name	IG	CG	CC	JU
0544	ISS 05-0544	5	8	3	NE
0544	ISS 05-0544	5	8	3	NE
2807	ISS 05-2807*	5	8	3	NE

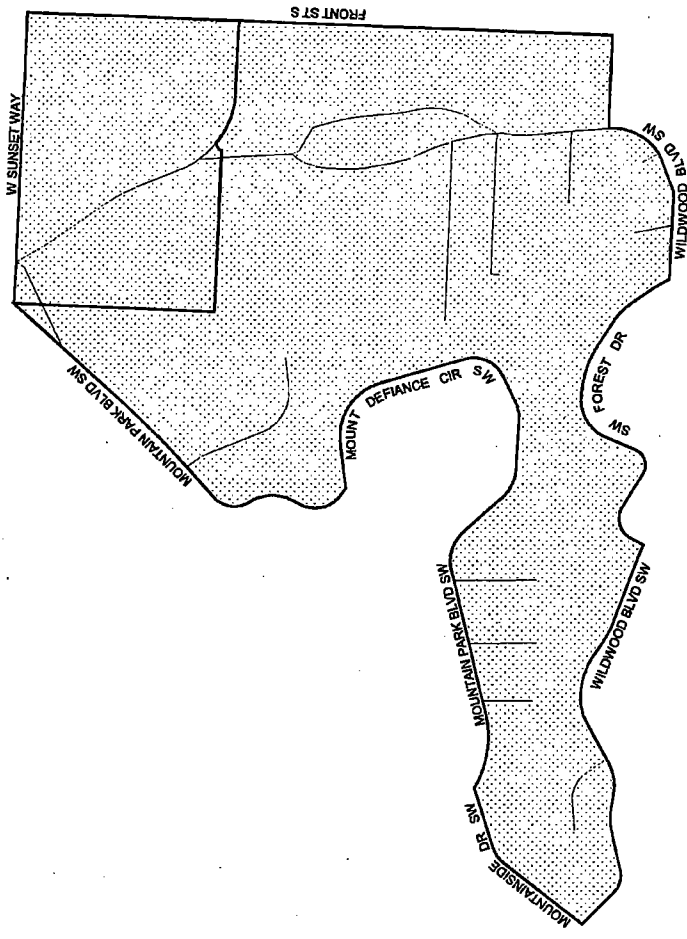

Legislative District Boundaries
 Congressional District Boundaries
 Council District Boundaries
 New Precinct
 Old Precinct



Census Tract	Kroll Page	Title	S-T-R
032104	563		23-242-06

15736

2007 PRECINCT ALTERATIONS

Code	Precinct Name	IG	CG	CC	JU
3464	ISS 05-3464	5	8	3	NE
3464	ISS 05-3464	5	8	3	NE

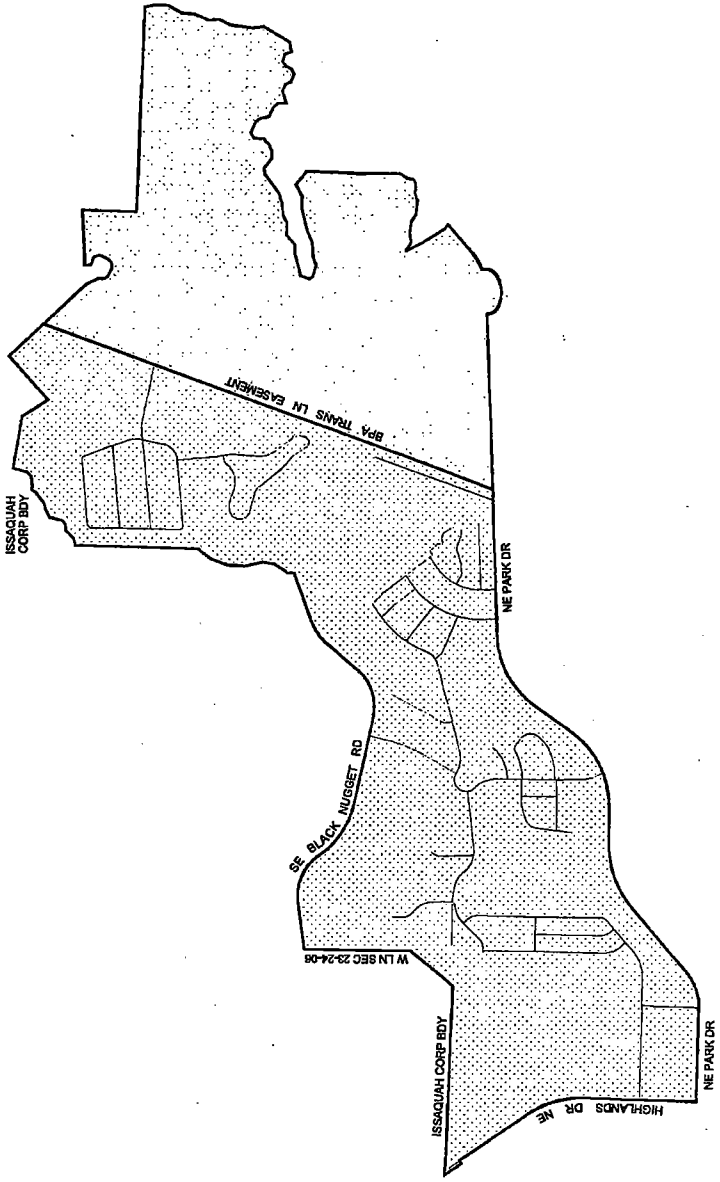

Legislative District Boundaries
 Congressional District Boundaries
 Council District Boundaries
 New Precinct
 Old Precinct



Census Tract	Kroll Page	Title	S-T-R
032210	965		23-24-06

15736

2007 PRECINCT ALTERATIONS

Code	Precinct Name	IG	CG	CC	JU
3527	ISS 05-3527	5	8	3	NE
3464	ISS 05-3464	5	8	3	NE

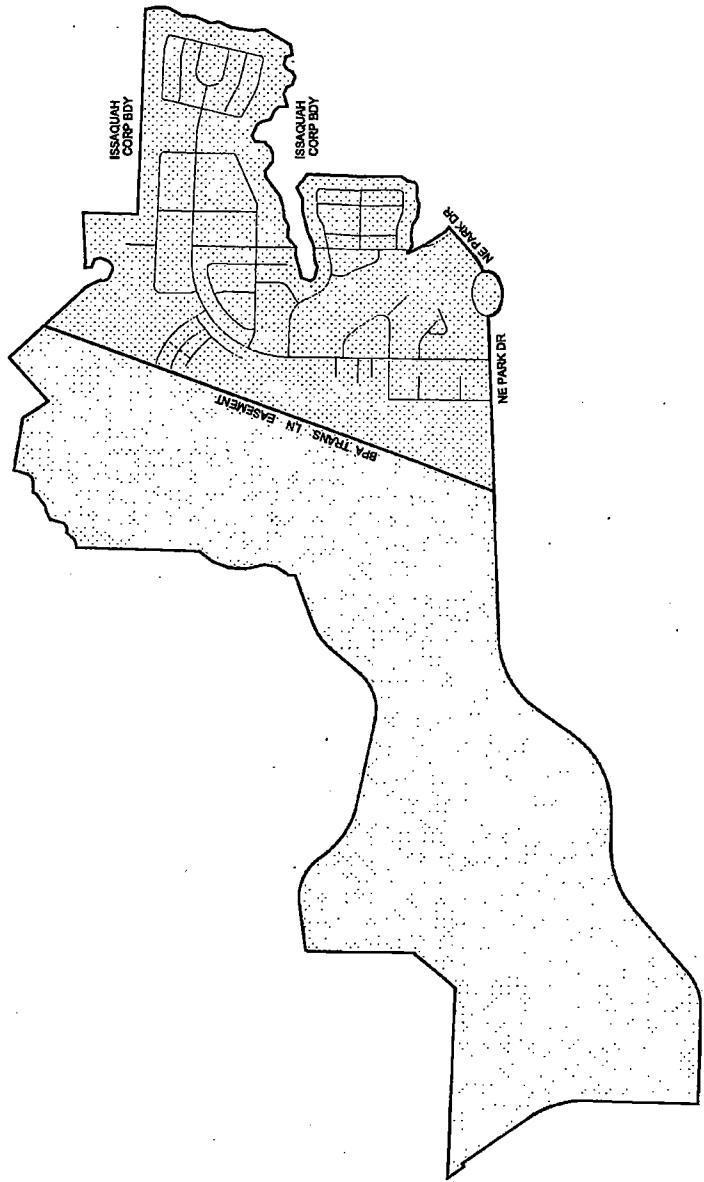

-  Legislative District Boundaries
-  Congressional District Boundaries
-  Council District Boundaries
-  New Precinct
-  Old Precinct



Census Tract	Kroll Page	Title	S-T-R
032210	966		23-24-06

15736

2007 PRECINCT ALTERATIONS

Code	Precinct Name	IG	CG	CC	JU
3145	ISS 41-3145	41	8	3	NE
3145	ISS 41-3145	41	8	3	NE

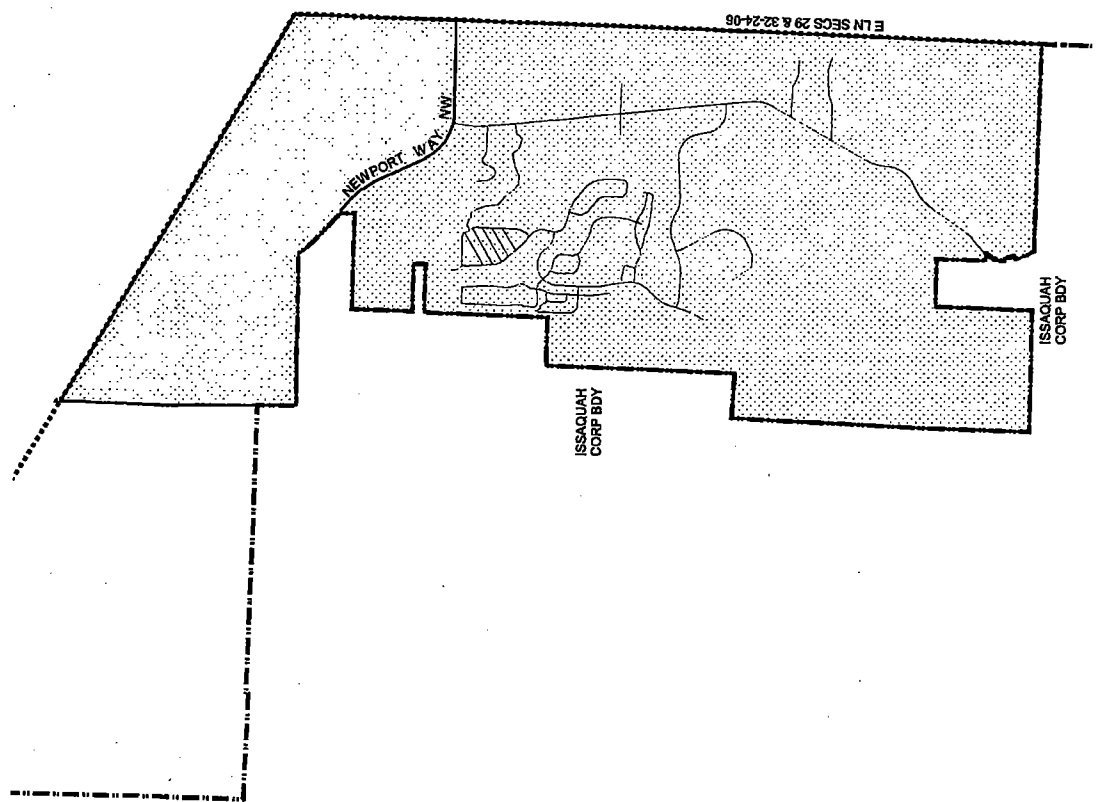

- Legislative District Boundaries
- Congressional District Boundaries
- Council District Boundaries
- New Precinct
- Old Precinct



Census Tract	Kroll Page	Title	S-T-R
025004	560		29-24-06

15736

2007 PRECINCT ALTERATIONS

Code	Precinct Name	LG	CG	CC	JU
3533	ISS 41-3533	41	8	3	NE
3145	ISS 41-3145	41	8	3	NE

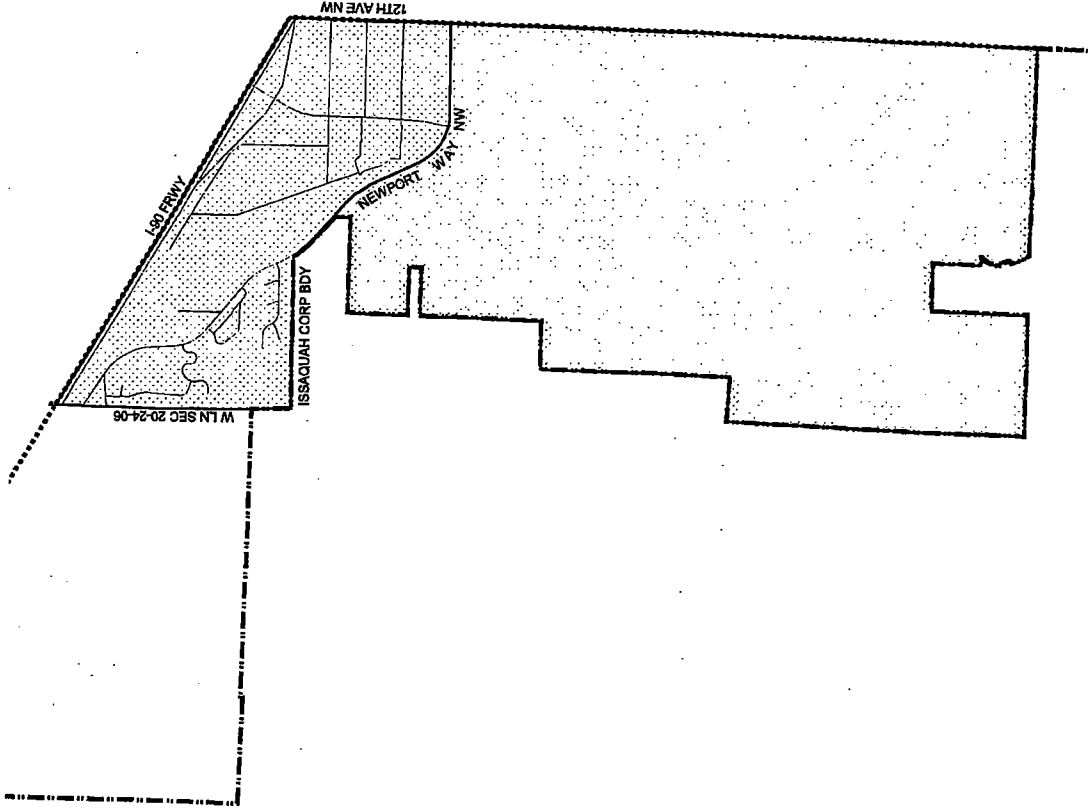

- Legislative District Boundaries
- Congressional District Boundaries
- Council District Boundaries
- New Precinct
- Old Precinct



Census Tract	Kroll Page	Title	S-T-R
025004	558		20-24-06

15736

2007 PRECINCT ALTERATIONS

Code	Precinct Name	IG	CG	CC	JU
2733	ISS 48-2733	48	8	3	NE
2574	ISS 48-2574*	48	8	3	NE
2733	ISS 48-2733	48	8	3	NE

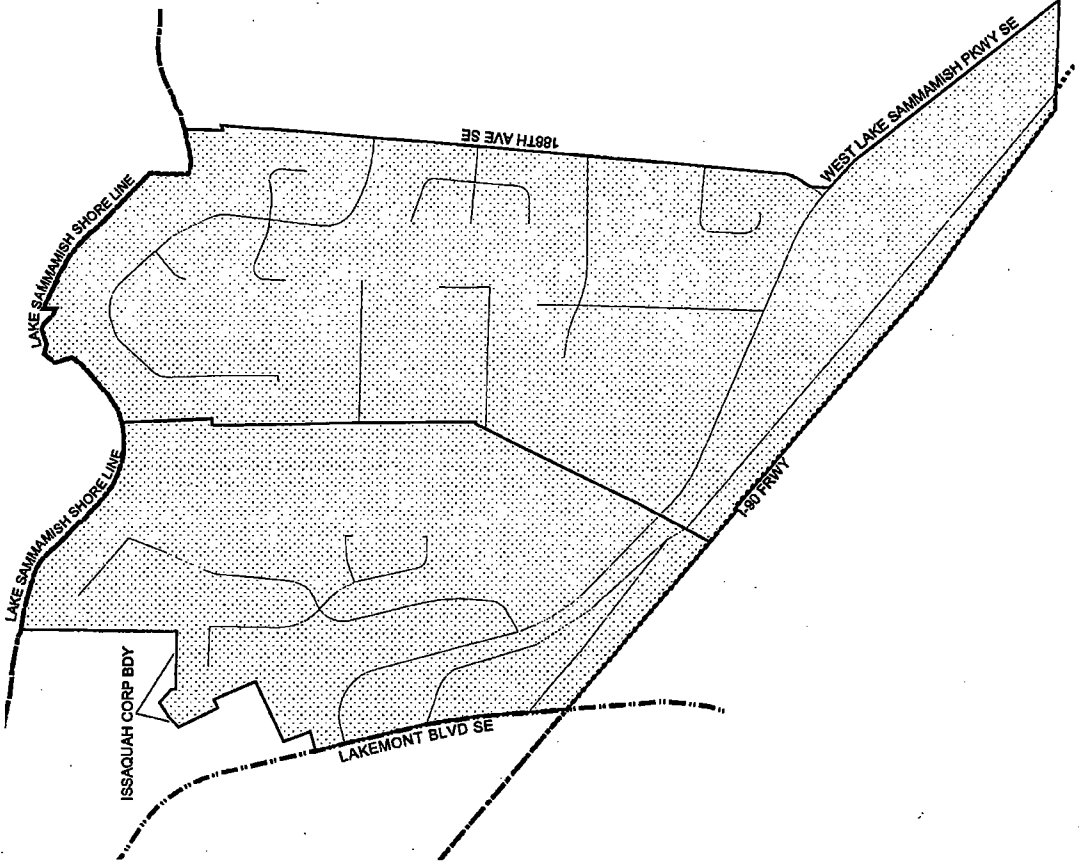

- Legislative District Boundaries
- Congressional District Boundaries
- Council District Boundaries
- New Precinct
- ▨ Old Precinct



Census Tract	Kroll Page	Title	S-T-R
023402	554		18-24-06

15736

2007 PRECINCT ALTERATIONS

Code	Precinct Name	LG	CG	CC	JU
3522	WELCOME LAKE	45	8	3	NE
2653	BIG BEND	45	8	3	NE

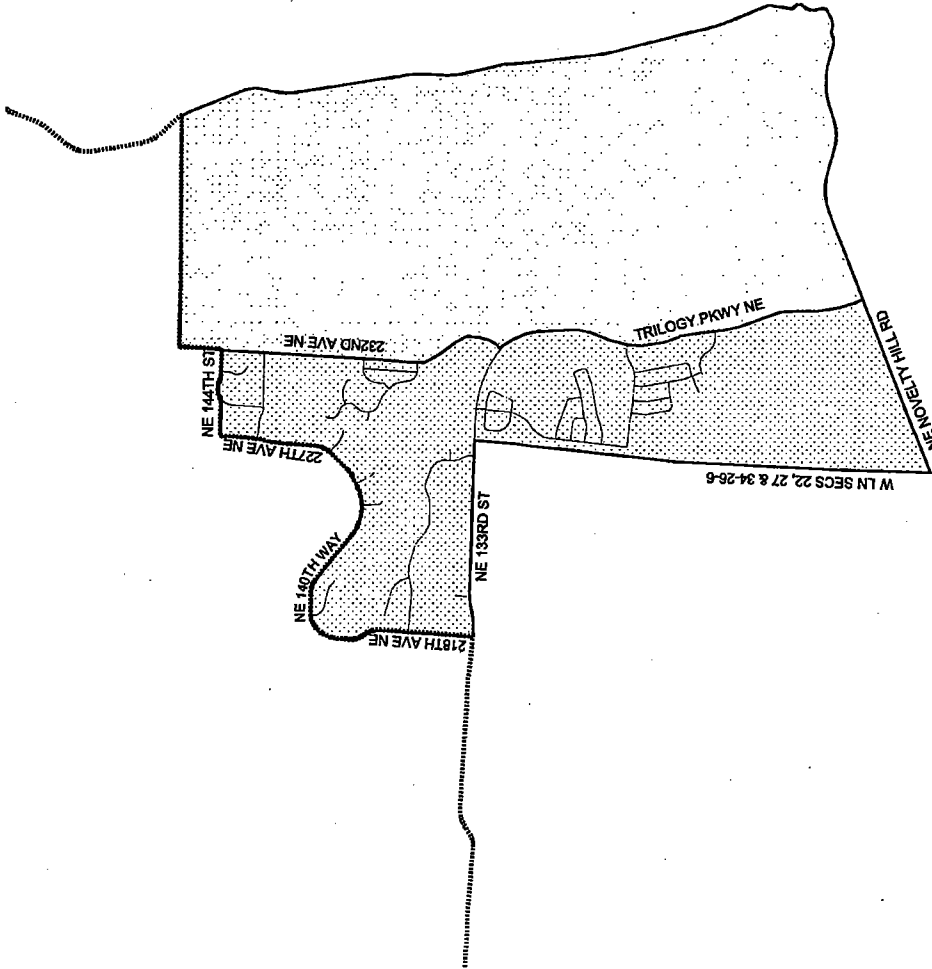

- Legislative District Boundaries
- Congressional District Boundaries
- Council District Boundaries
- New Precinct
- Old Precinct



Census Tract	Kroll Page	Title	S-T-R
032312	920		21-26-06

15736

2007 PRECINCT ALTERATIONS

Code	Precinct Name	LG	CG	CC	JU
3270	WOD 45-3270	45	1	3	NE
3270	WOD 45-3270	45	1	3	NE

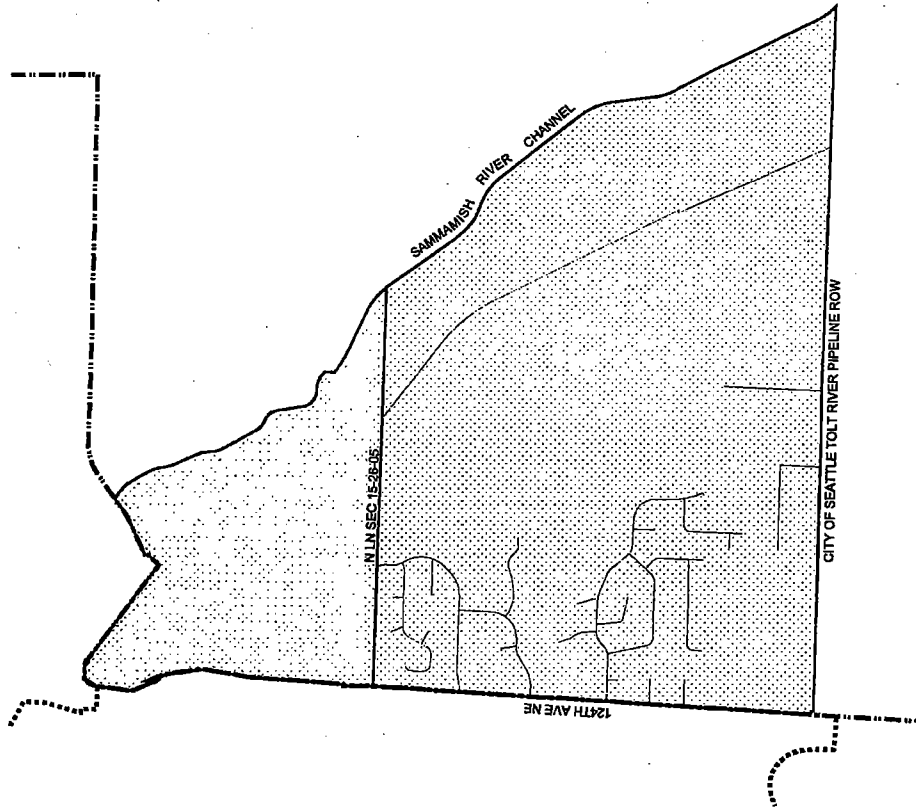

- Legislative District Boundaries
- Congressional District Boundaries
- Council District Boundaries
- New Precinct
- Old Precinct



Census Tract	Kroll Page	Title	S-T-R
029106	507		15-26-05

15736

2007 PRECINCT ALTERATIONS

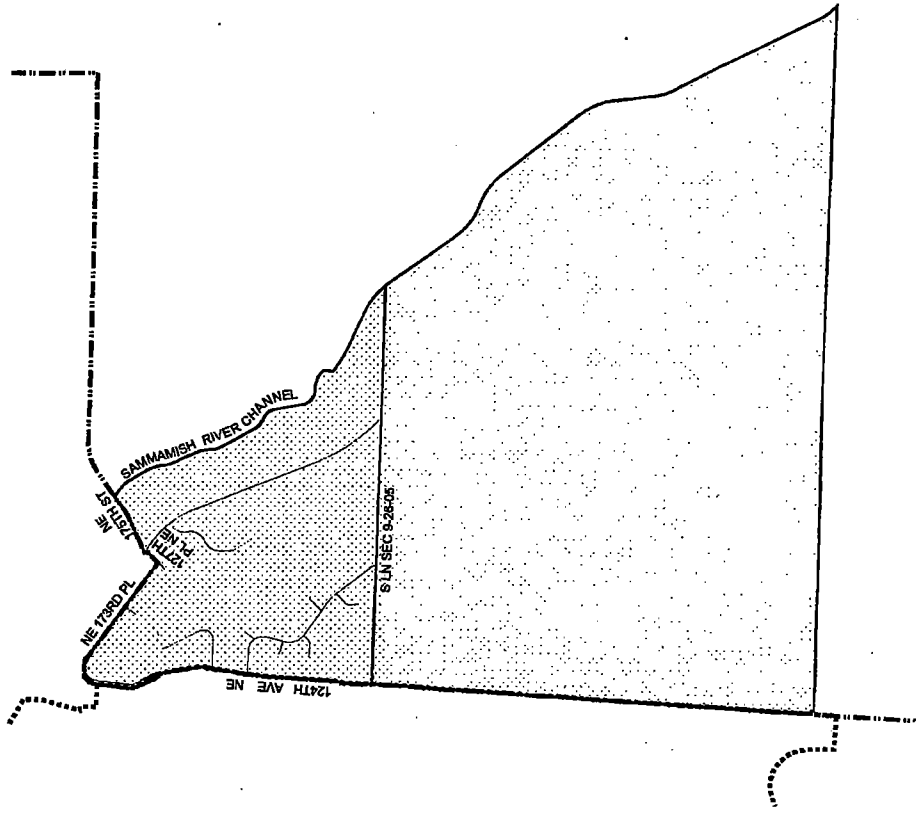

Code	Precinct Name	IG	CG	CC	JU
3530	WOD 45-3530	45	1	3	NE
3270	WOD 45-3270	45	1	3	NE

- Legislative District Boundaries
- Congressional District Boundaries
- Council District Boundaries



Census Tract	Kroll Page	Title	S-T-R
029106	409		9-26-05

15236

2007 PRECINCT ALTERATIONS

Code	Precinct Name	LG	CG	CC	JU
1805	SEA 36-1805	36	7	4	W
1804	SEA 36-1804*	36	7	4	W
1805	SEA 36-1805	36	7	4	W

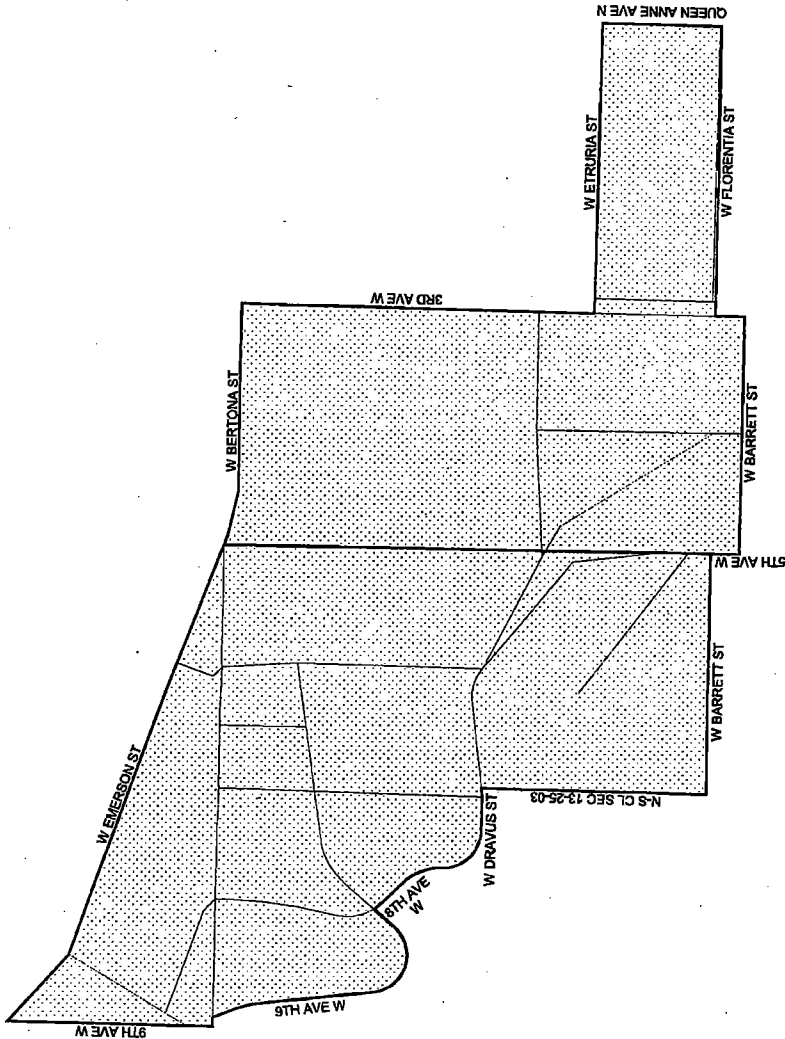

Census Tract	Kroll Page	Title	S-T-R
05900	21		13-25-03

15736

2007 PRECINCT ALTERATIONS

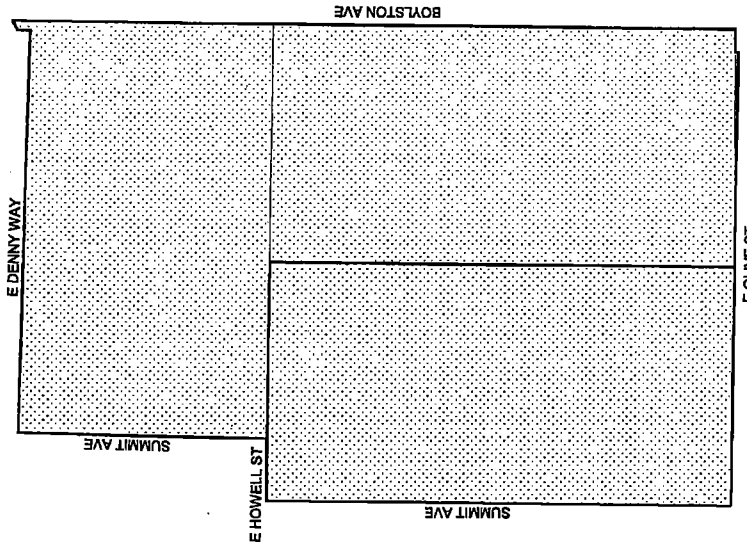

Code	Precinct Name	IG	CG	CC	JU
1845	SEA 43-1845	43	7	4	W
1844	SEA 43-1844*	43	7	4	W
1845	SEA 43-1845	43	7	4	W

- Legislative District Boundaries
- Congressional District Boundaries
- Council District Boundaries



Census Tract	Kroll Page	Title	S-T-R
007400	40		32-25-04

15736

2007 PRECINCT ALTERATIONS

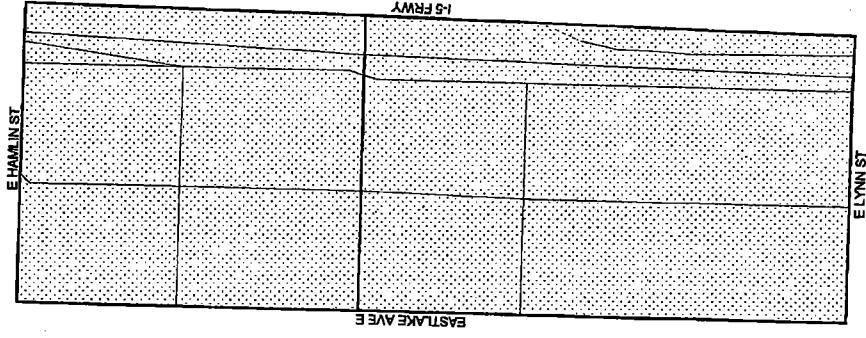

Code	Precinct Name	IG	CG	CC	JU
2000	SEA 43-2000	43	7	4	W
2000	SEA 43-2000	43	7	4	W
2005	SEA 43-2005*	43	7	4	W

- Legislative District Boundaries
- Congressional District Boundaries
- Council District Boundaries



- New Precinct
- Old Precinct



Census Tract	Kroll Page	Title	S-T-R
006100	30		20-25-04

15733

2007 PRECINCT ALTERATIONS

Code	Precinct Name	IG	CG	CC	JU
0362	DES 33-0362	33	9	5	SW
0362	DES 33-0362	33	9	5	SW
3277	DES 33-3277*	33	9	5	SW

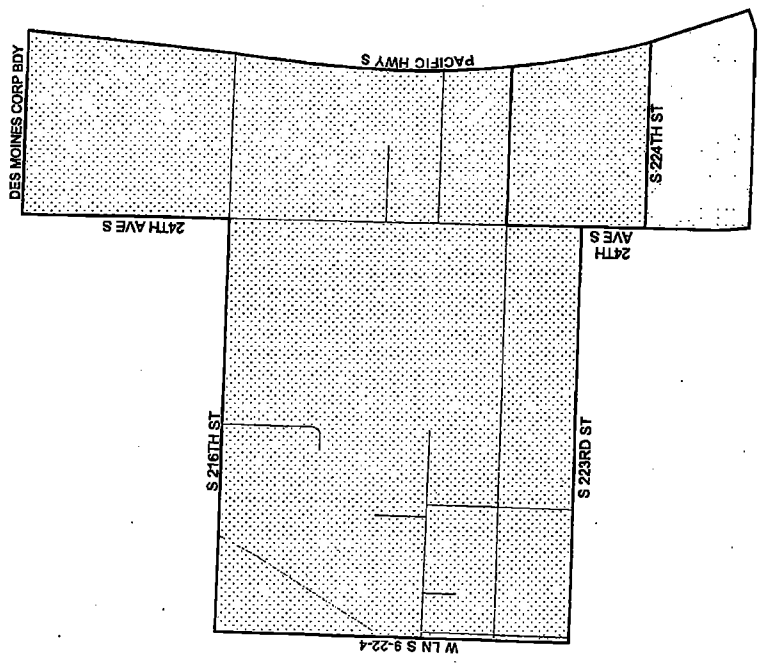

- Legislative District Boundaries
- Congressional District Boundaries
- Council District Boundaries
- New Precinct
- Old Precinct



Census Tract	Kroll Page	Title	S-T-R
028901	358		9-22-04

15736

2007 PRECINCT ALTERATIONS

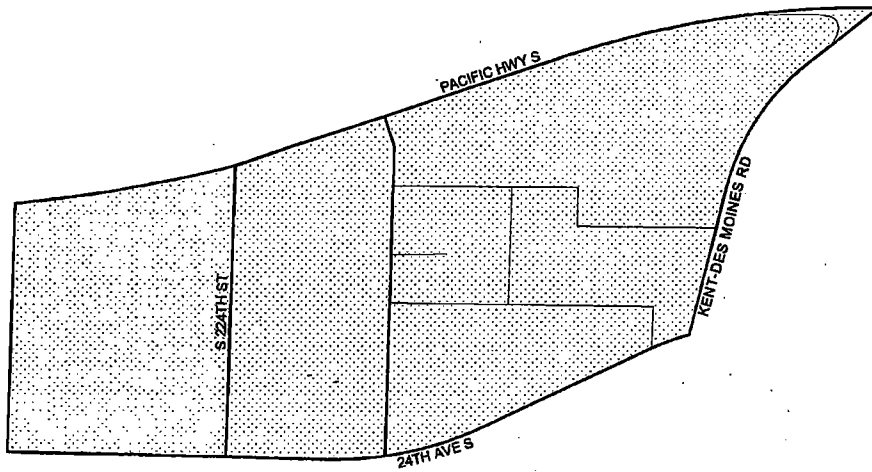

Code	Precinct Name	LG	CG	CC	JU
0363	DES 33-0363	33	9	5	SW
0363	DES 33-0363	33	9	5	SW
3277	DES 33-3277*	33	9	5	SW

- Legislative District Boundaries
- Congressional District Boundaries
- Council District Boundaries
- New Precinct
- Old Precinct



Census Tract	Kroll Page	Title	S-T-R
028901	358		9-22-04

15736

2007 PRECINCT ALTERATIONS

Code	Precinct Name	LG	CG	CC	JU
3445	KEN 33-3445	33	8	5	SE
3274	KEN 33-3274*	33	8	5	SE
3445	KEN 33-3445	33	8	5	SE

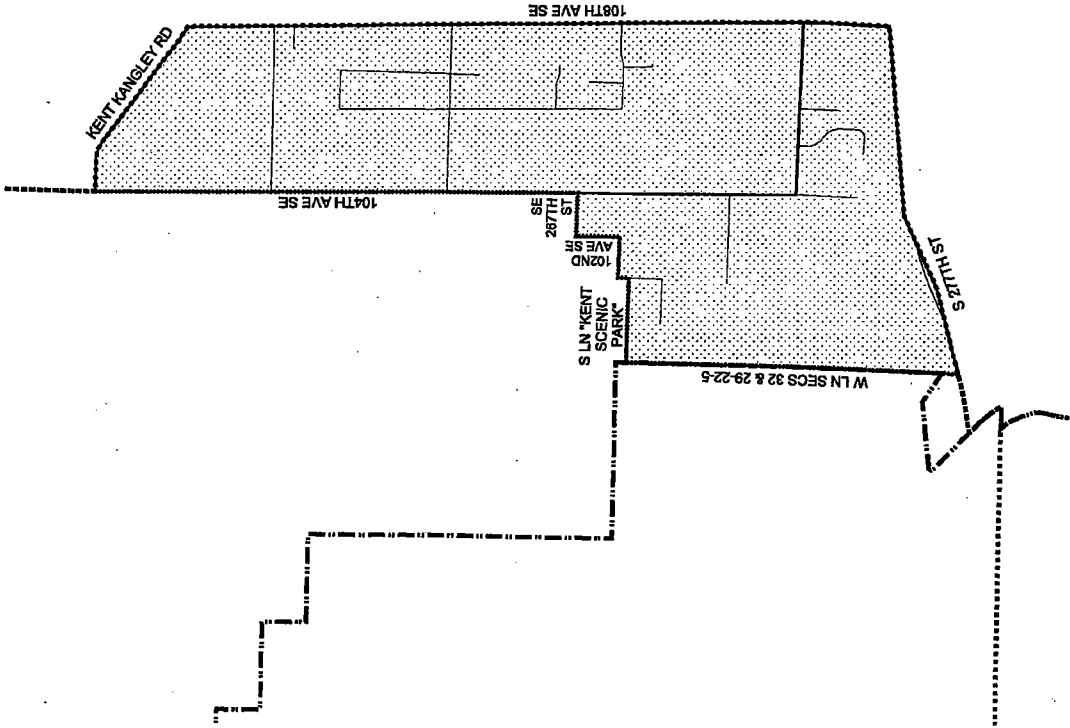

- Legislative District Boundaries
- Congressional District Boundaries
- Council District Boundaries
- New Precinct
- Old Precinct



Census Tract	Kroll Page	Title	S-T-R
029700	627		29-22-05

15736

2007 PRECINCT ALTERATIONS

Code	Precinct Name	LG	CG	CC	JU
2490	KEN 47-2490	47	8	5	SE
2490	KEN 47-2490	47	8	5	SE

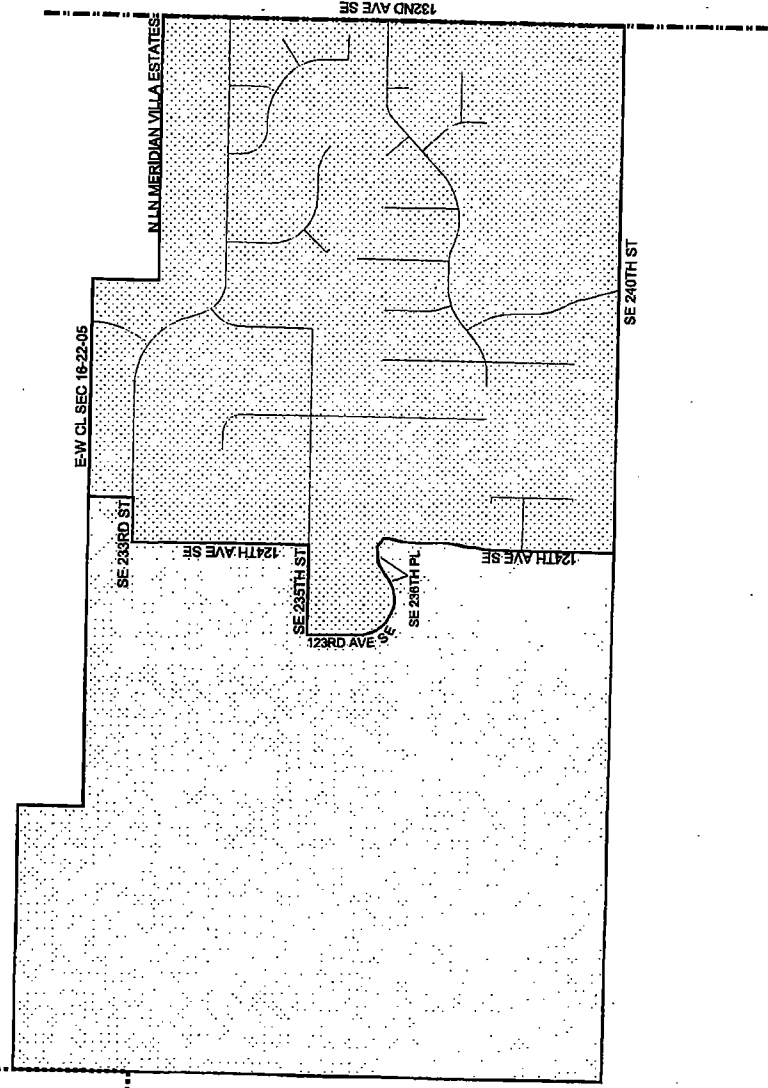

- Legislative District Boundaries
- Congressional District Boundaries
- Council District Boundaries
- New Precinct
- Old Precinct



Census Tract	Kroll Page	Title	S-T-R
029406	642		16-22-05

15793

2007 PRECINCT ALTERATIONS

Code	Precinct Name	LG	CG	CC	JU
3537	KEN 47-3537	47	8	5	SE
2490	KEN 47-2490	47	8	5	SE

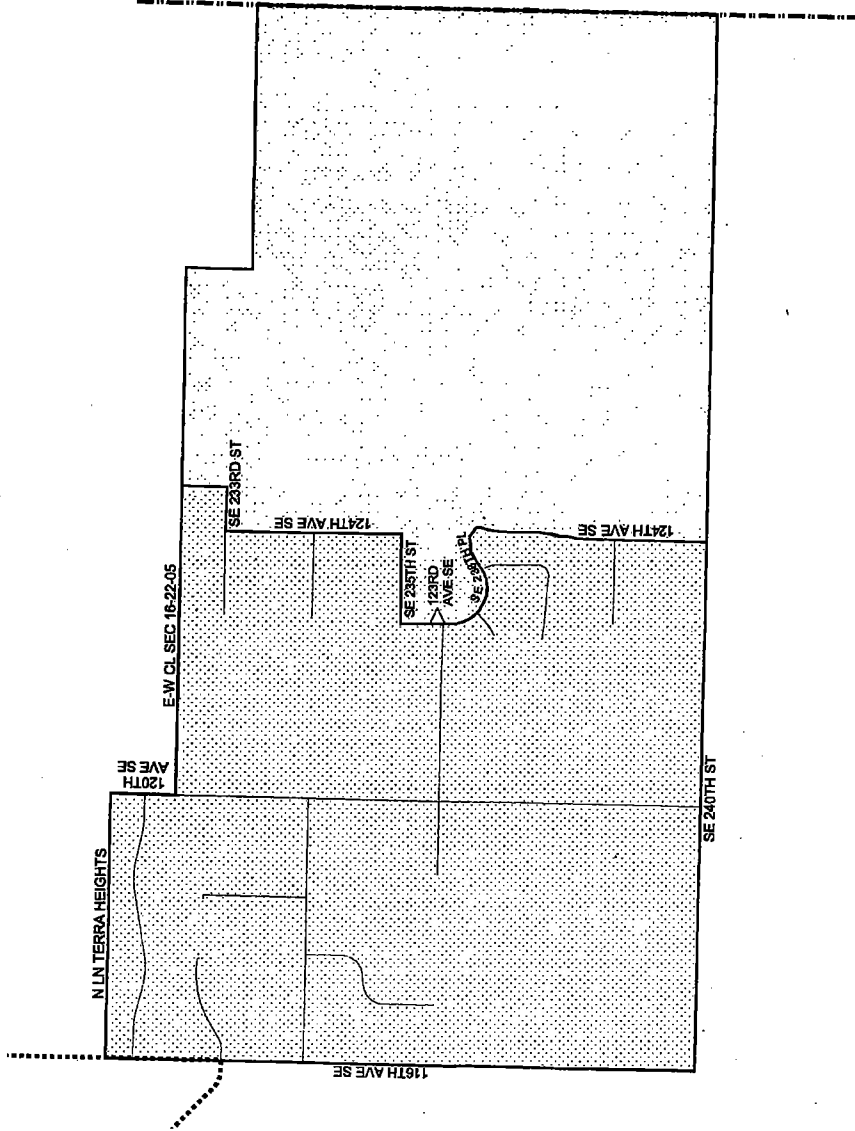

- Legislative District Boundaries
- Congressional District Boundaries
- Council District Boundaries
- New Precinct
- Old Precinct



0.5 Miles



Census Tract	Kroll Page	Title	S-T-R
029406	642		16-22-05

15736

2007 PRECINCT ALTERATIONS

Code	Precinct Name	LG	CG	CC	JU
2472	RNT 11-2472	11	9	5	SE
2472	RNT 11-2472	11	9	5	SE

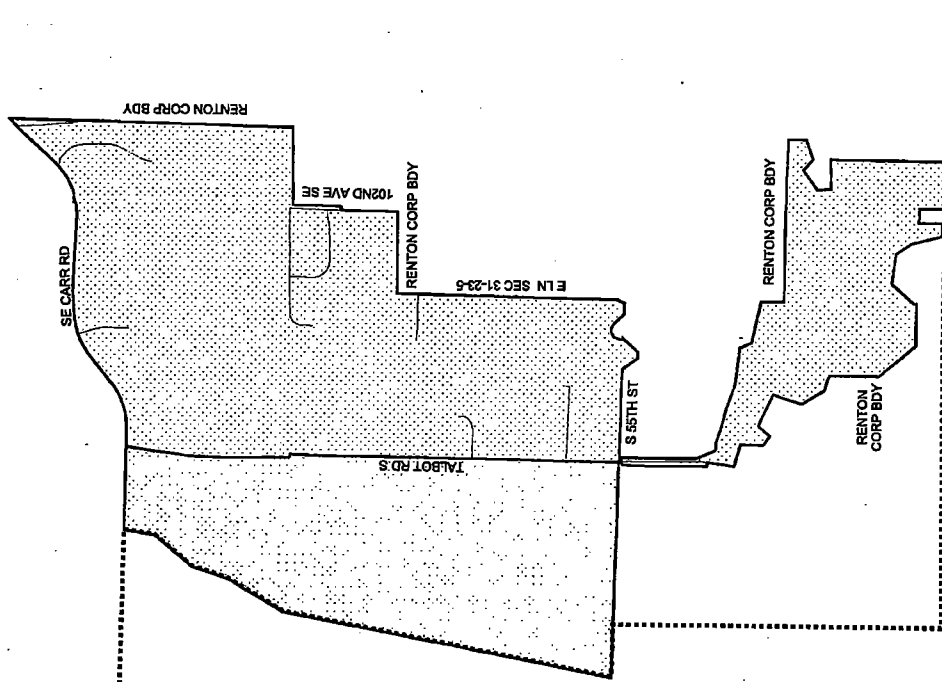

- Legislative District Boundaries
- Congressional District Boundaries
- Council District Boundaries
- New Precinct
- Old Precinct



Census Tract	Kroll Page	Title	S-T-R
029303	603		31-23-05

15736

2007 PRECINCT ALTERATIONS

Code	Precinct Name	LG	CG	CC	JU
3535	RNT 11-3535	11	9	5	SE
2472	RNT 11-2472	11	9	5	SE

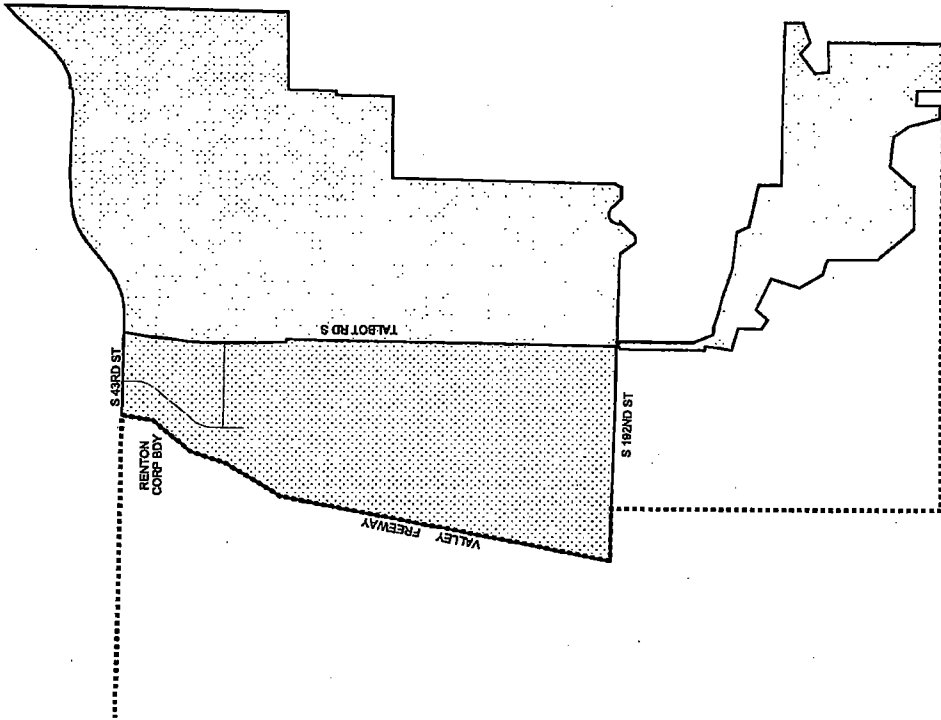

- Legislative District Boundaries
- Congressional District Boundaries
- Council District Boundaries



- New Precinct
- Old Precinct

0.25 0 0.25 0.5 Miles

Census Tract	Kroll Page	Title	S-T-R
029303	603		31-23-05

15736

2007 PRECINCT ALTERATIONS

Code	Precinct Name	LG	CG	CC	JU
0201	BEL 41-0201	41	8	6	NE
0201	BEL 41-0201	41	8	6	NE
0200	BEL 41-0200*	41	8	6	NE

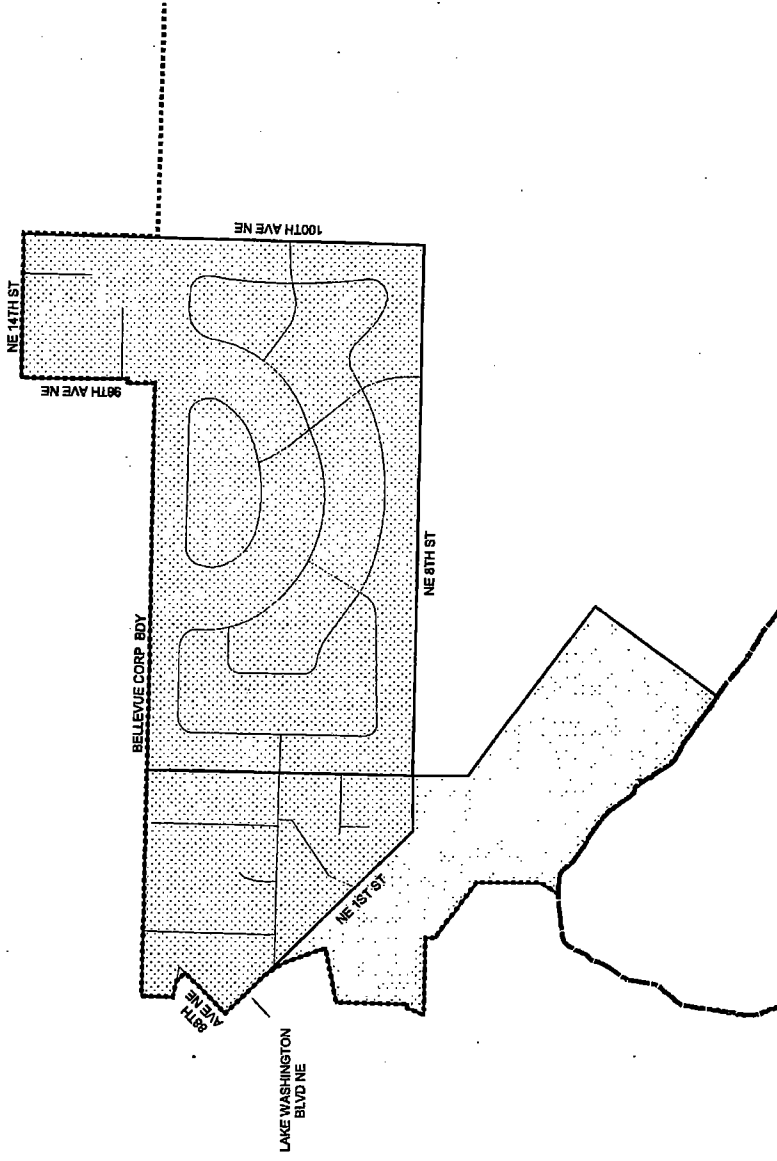

- Legislative District Boundaries
- Congressional District Boundaries
- Council District Boundaries
- New Precinct
- Old Precinct



Census Tract	Kroll Page	Title	S-T-R
02400	441		30-25-05

15723

2007 PRECINCT ALTERATIONS

Code	Precinct Name	LG	CG	CC	JU
0203	BEL 41-0203	41	8	6	NE
0203	BEL 41-0203	41	8	6	NE
0200	BEL 41-0200*	41	8	6	NE

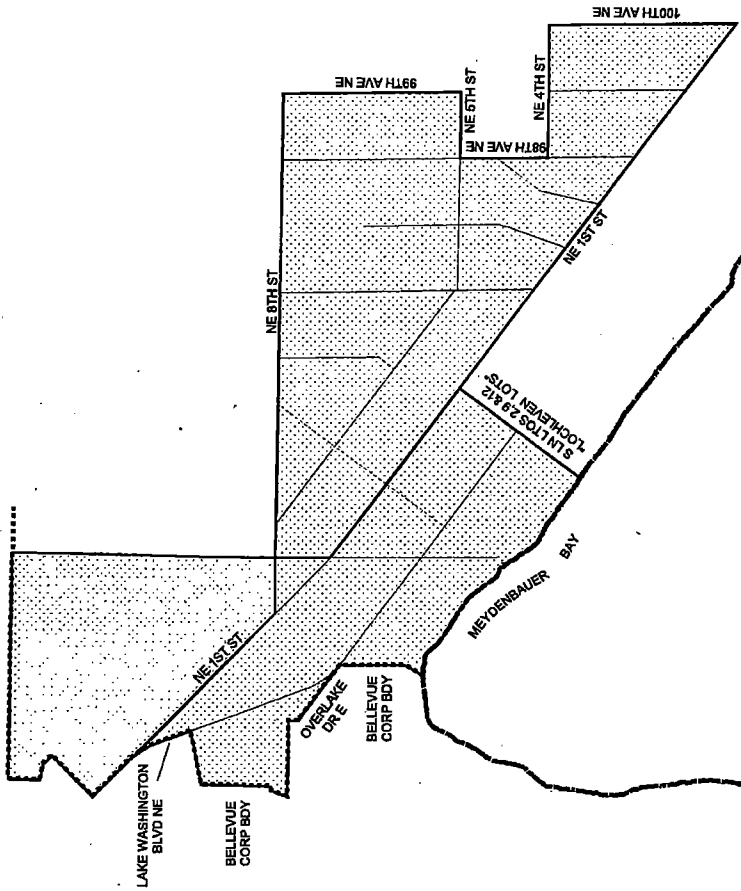

- Legislative District Boundaries
- Congressional District Boundaries
- Council District Boundaries
- New Precinct
- Old Precinct



Census Tract	Kroll Page	Title	S-T-R
02400	444		31-25-05

15735

2007 PRECINCT ALTERATIONS

Code	Precinct Name	LG	CG	CC	JU
0212	BEL 48-0212	48	8	6	NE
0215	BEL 48-0215*	48	8	6	NE
2431	BEL 48-2431*	48	8	6	NE
0212	BEL 48-0212	48	8	6	NE

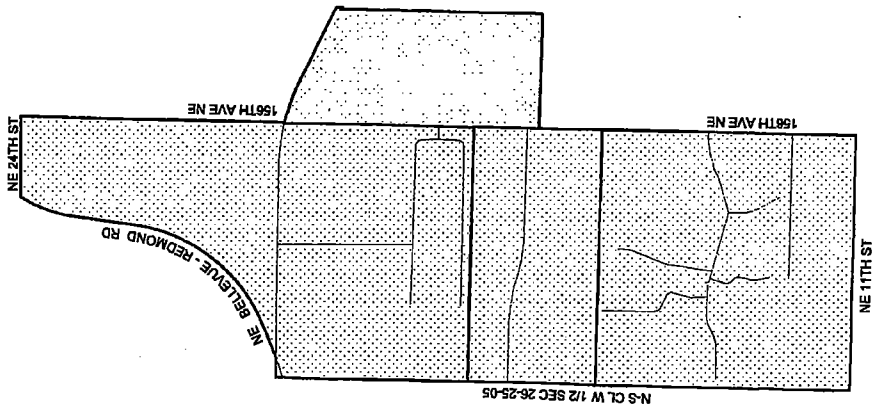

- Legislative District Boundaries
- Congressional District Boundaries
- Council District Boundaries
- New Precinct
- Old Precinct



Census Tract	Kroll Page	Title	S-T-R
023000	537		26-25-05

15736

2007 PRECINCT ALTERATIONS

Code	Precinct Name	IG	CG	CC	JU
2776	BEL 48-2776	48	8	6	NE
2776	BEL 48-2776	48	8	6	NE
0212	BEL 48-0212	48	8	6	NE

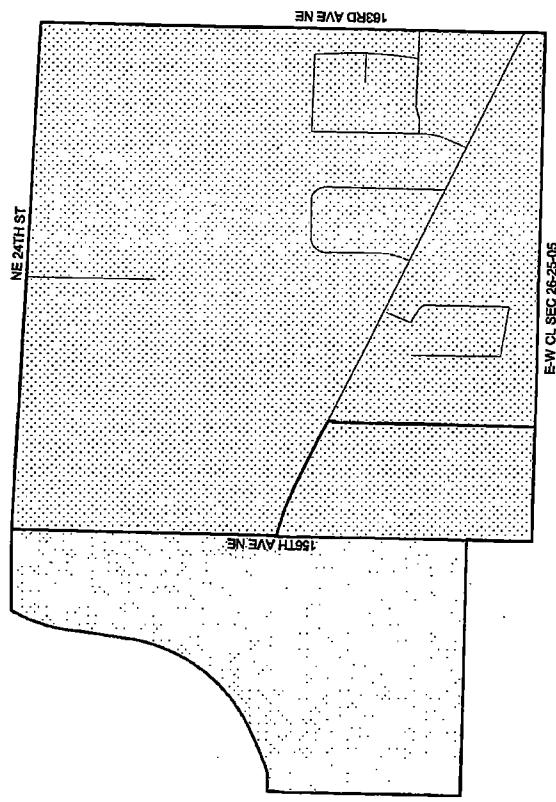

- Legislative District Boundaries
- Congressional District Boundaries
- Council District Boundaries
- New Precinct
- Old Precinct



Census Tract	Kroll Page	Title	S-T-R
023000	537		26-25-05

15736

2007 PRECINCT ALTERATIONS

Code	Precinct Name	IG	CG	CC	JU
3457	FISHER	47	8	7	SE
3457	FISHER	47	8	7	SE
3456	SEDGE	47	8	7	SE

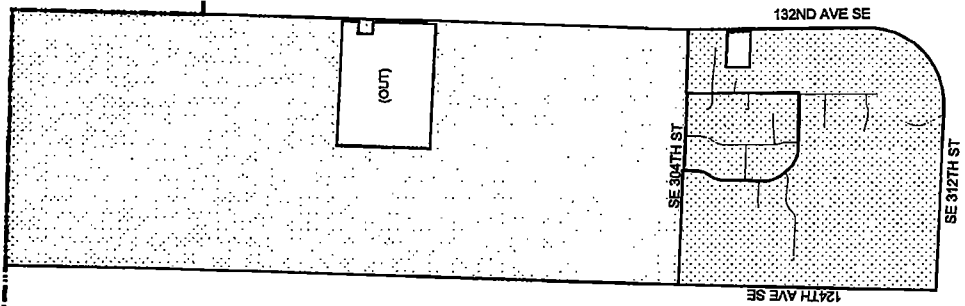

- Legislative District Boundaries
- Congressional District Boundaries
- Council District Boundaries
- New Precinct
- Old Precinct



Census Tract	Kroll Page	Title	S-T-R
031205	721		09-21-05

15736

2007 PRECINCT ALTERATIONS

Code	Precinct Name	LG	CG	CC	JU
3523	KENTLAKE	47	8	7	SE
2741	SAWYER	47	8	7	SE

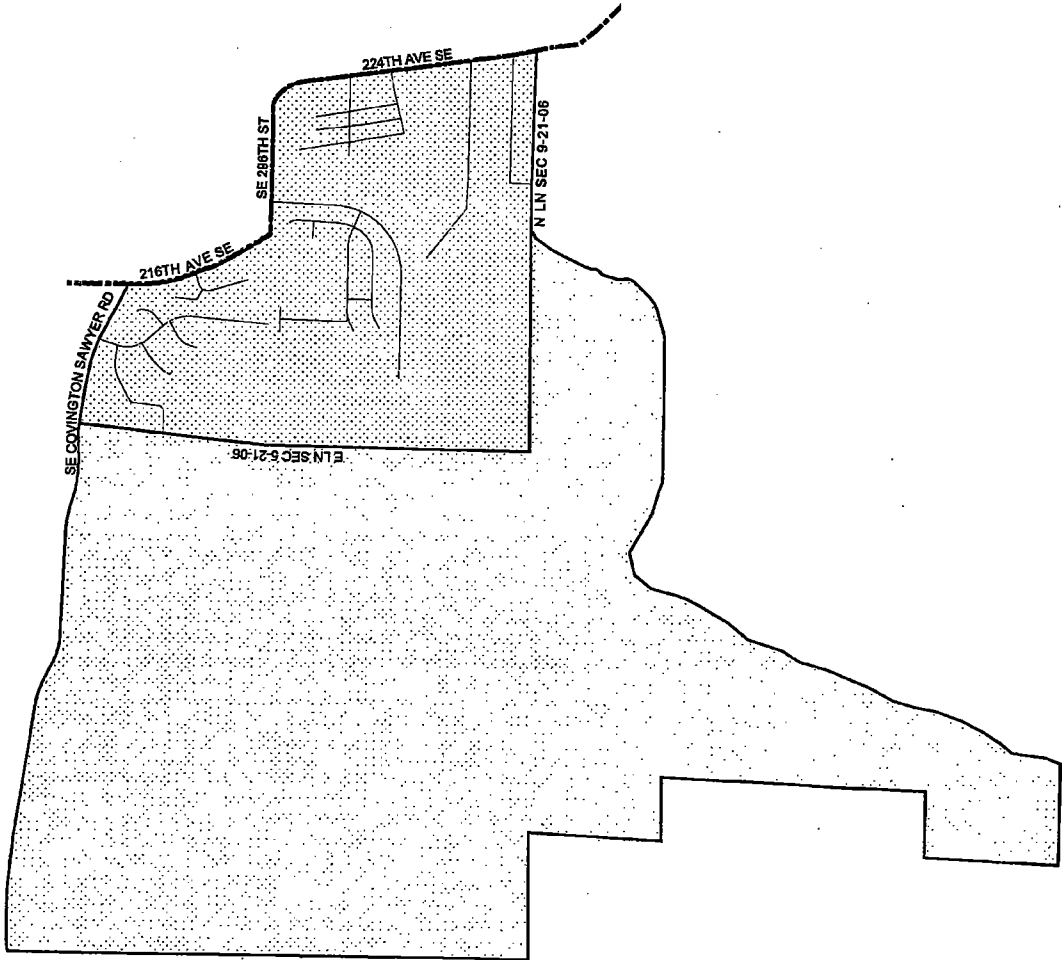

- Legislative District Boundaries
- Congressional District Boundaries
- Council District Boundaries



- New Precinct
- Old Precinct



Census Tract	Kroll Page	Title	S-T-R
031601	B26		5-06-21

15236

2007 PRECINCT ALTERATIONS

Code	Precinct Name	LG	CG	CC	JU
2741	SAWYER	47	8	7	SE
2741	SAWYER	47	8	7	SE

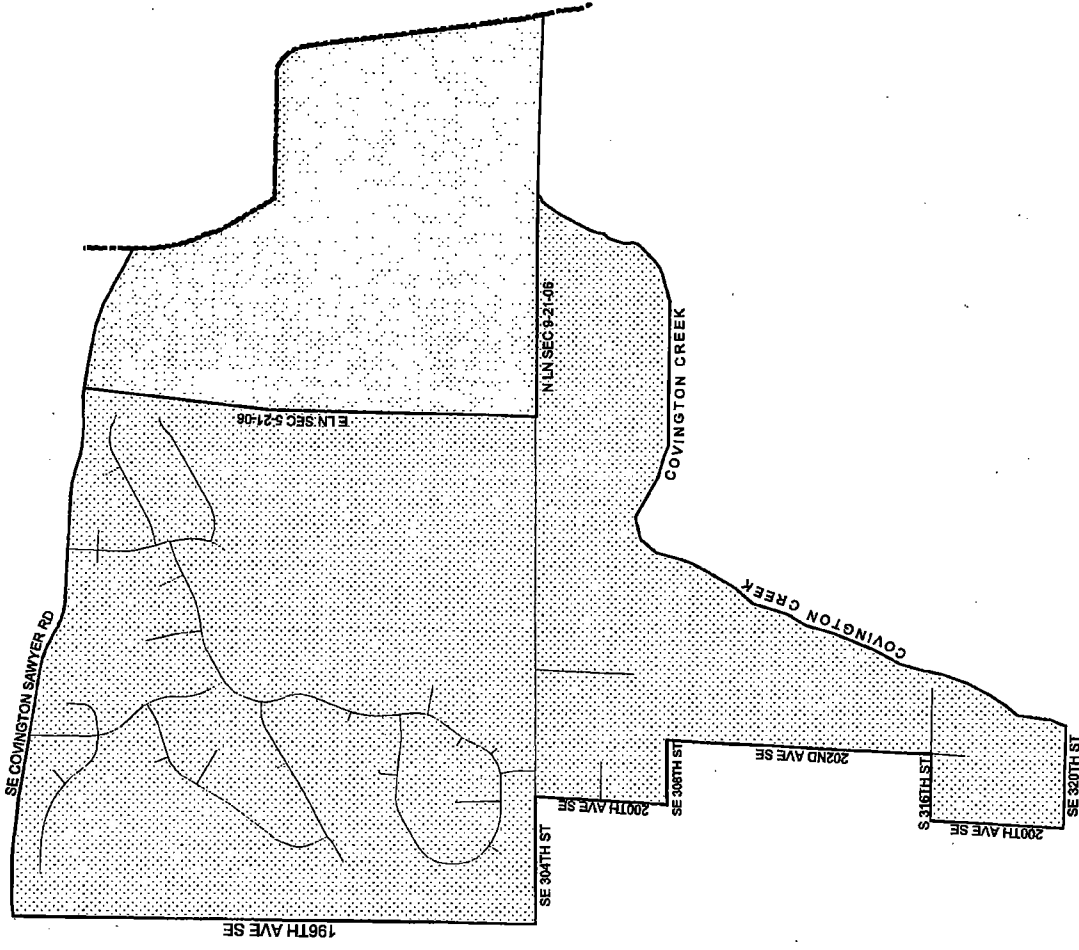

- Legislative District Boundaries
- Congressional District Boundaries
- Council District Boundaries
- New Precinct
- Old Precinct



Census Tract	Kroll Page	Title	S-T-R
031601	B26		5-06-21

15736

2007 PRECINCT ALTERATIONS

Code	Precinct Name	LG	CG	CC	JU
3456	SE DGE	47	8	7	SE
3456	SE DGE	47	8	7	SE

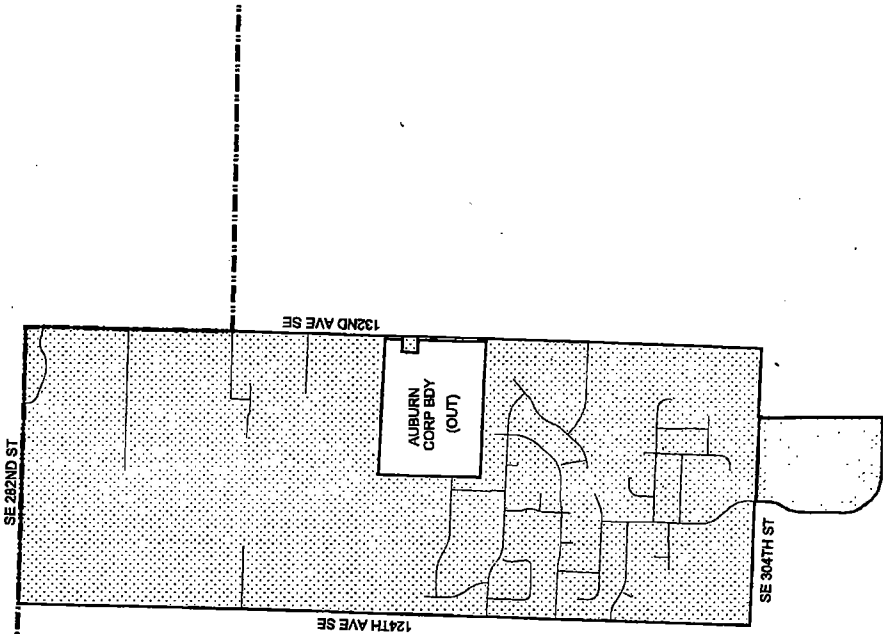

- Legislative District Boundaries
- Congressional District Boundaries
- Council District Boundaries
- New Precinct
- Old Precinct



Census Tract	Kroll Page	Title	S-T-R
029602	709		33-22-05

15736

2007 PRECINCT ALTERATIONS

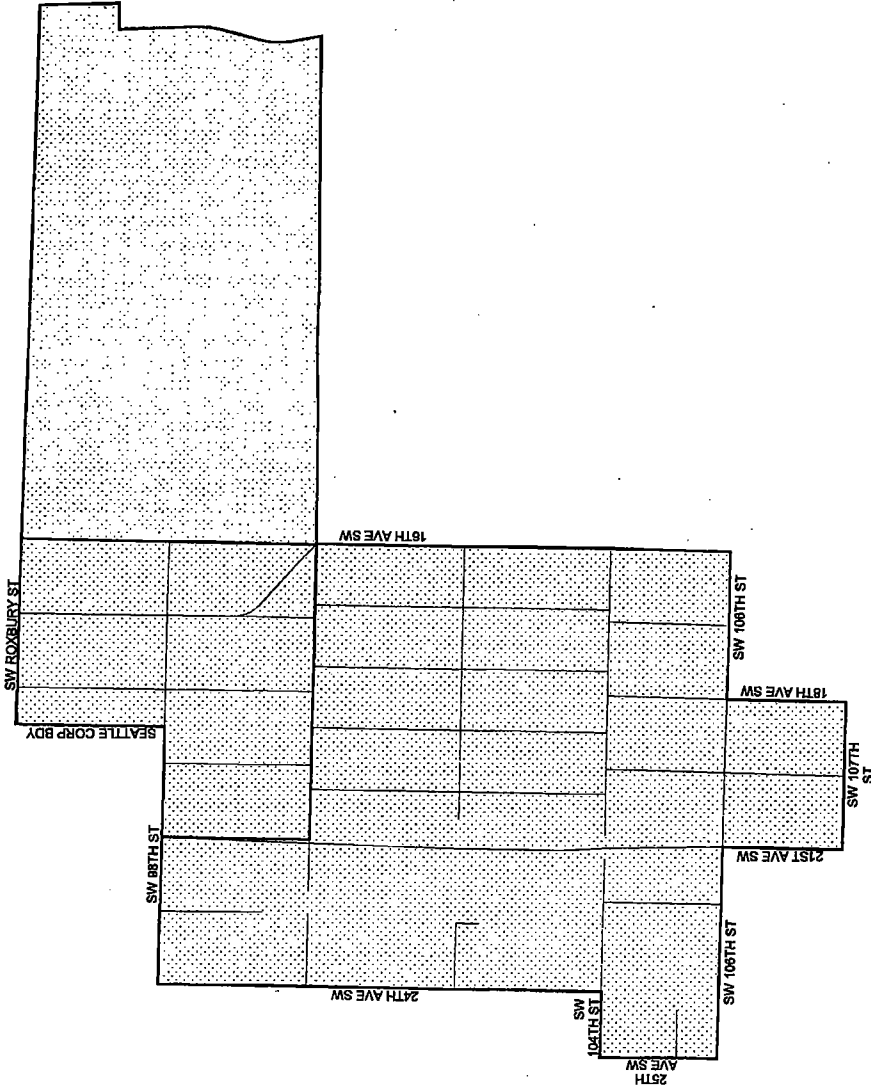

Code	Precinct Name	IG	CG	CC	JU
0956	REGAL	34	7	8	SW
0956	REGAL	34	7	8	SW
1215	WHITE CENTER	34	7	8	SW

- Legislative District Boundaries
- Congressional District Boundaries
- Council District Boundaries
- New Precinct
- Old Precinct



0.2 0 0.2 Miles

Census Tract	Kroll Page	Title	S-T-R
026600	301		1-23-03

15736

2007 PRECINCT ALTERATIONS

Code	Precinct Name	LG	CG	CC	JU
1215	WHITE CENTER	34	7	8	SW
0508	HEIGHTS*	34	7	8	SW
1215	WHITE CENTER	34	7	8	SW

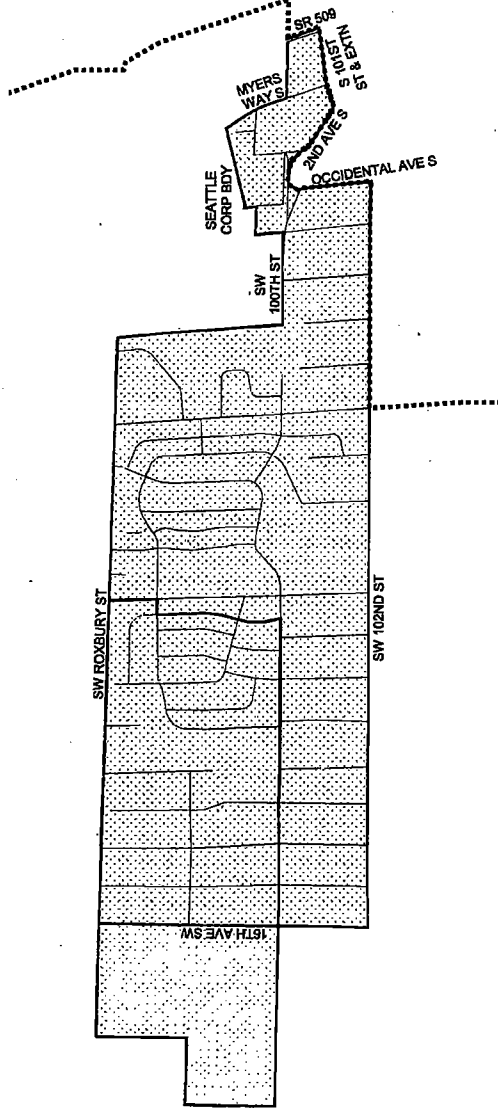

Census Tract	Kroll Page	Title	S-T-R
026500	302		6-23-03

15736

2007 PRECINCT ALTERATIONS

Code	Precinct Name	LG	CG	CC	JU
3525	BRIARWOOD	41	8	9	SE
1183	VALENCIA	41	8	9	SE
2606	HUSKY	41	8	9	SE

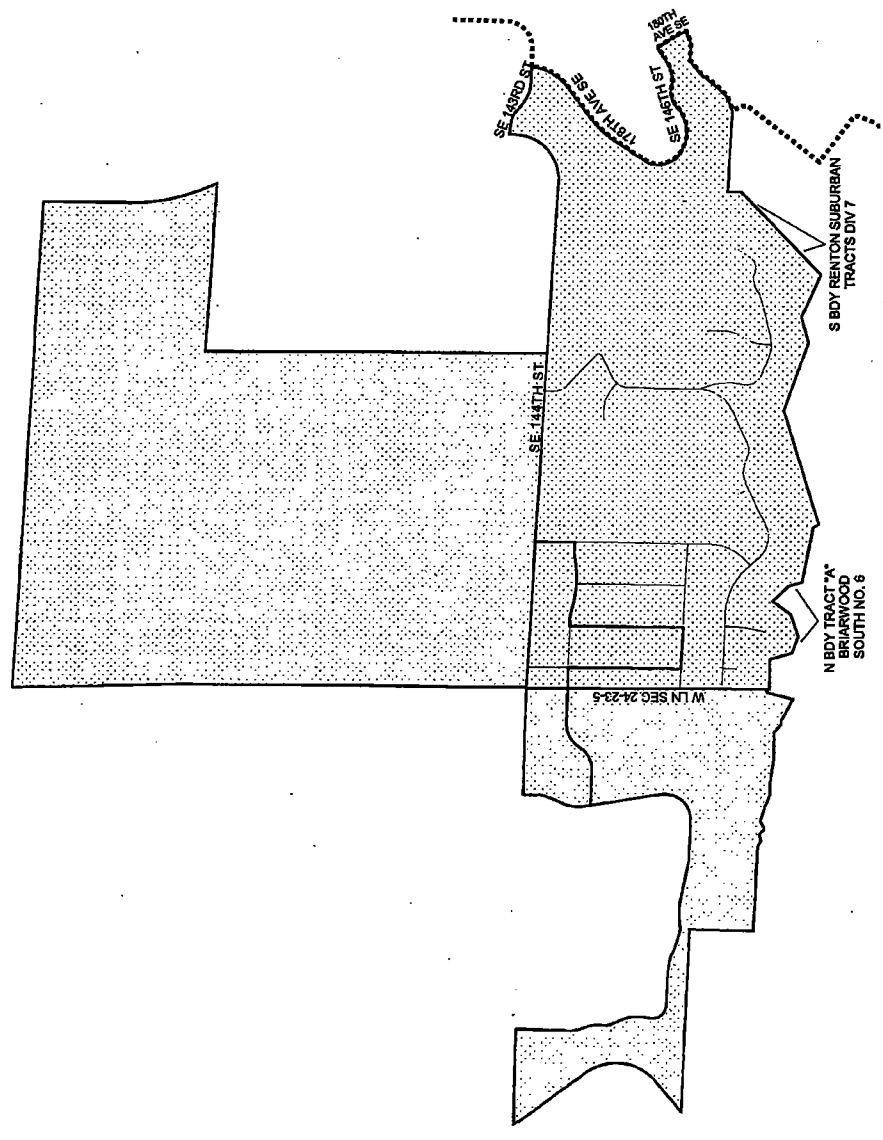

Legislative District Boundaries
 Congressional District Boundaries
 Council District Boundaries
 New Precinct
 Old Precinct

0.2 0 0.2 0.4 Miles

Census Tract	Kroll Page	Title	S-T-R
031903	817		24-23-05

15736

2007 PRECINCT ALTERATIONS

Code	Precinct Name	LG	CG	CC	JU
0293	CARRIAGE LANE	47	8	9	SE
0293	CARRIAGE LANE	47	8	9	SE

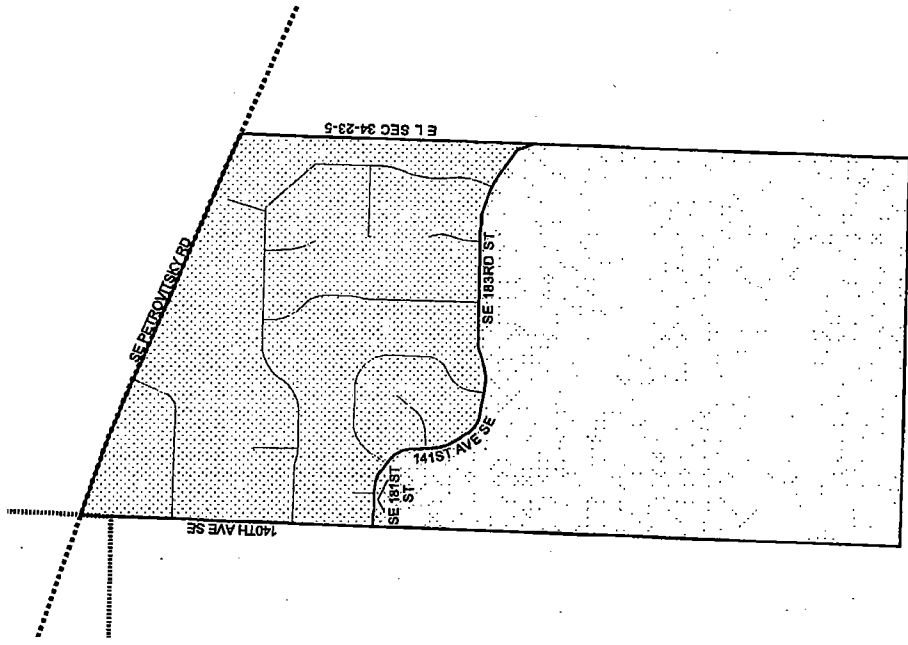

Census Tract	Kroll Page	Tile	S-T-R
031909	825		34-23-05

15736

2007 PRECINCT ALTERATIONS

Code	Precinct Name	LG	CG	CC	JU
0300	CEDAR PARK	41	8	9	SE
0300	CEDAR PARK	41	8	9	SE
2804	DANIEL	41	8	9	SE

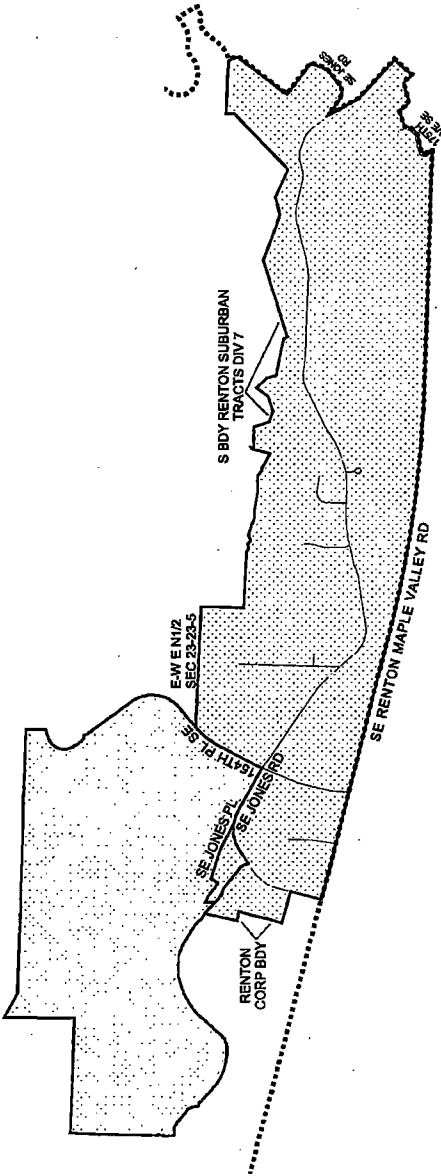

Legislative District Boundaries
 Congressional District Boundaries
 Council District Boundaries
 New Precinct
 Old Precinct

0.5 0 0.5 Miles

Census Tract	Kroll Page	Title	S-T-R
031903	817		23-23-05