

15709

2006-578

9/20/06

Attachment C

Sponsored By: Executive Committee

/pr

1  
2  
3  
4  
5  
6  
7  
8  
9  
10  
11  
12  
13  
14  
15  
16  
17  
18  
19  
20  
21  
22  
23  
24  
25  
26  
27  
28  
29  
30  
31  
32  
33  
34  
35  
36

**MOTION NO. 06-03**

A MOTION to amend the Countywide Planning Policies by designating the Overlake area of Redmond as an Urban Center. Overlake is added to the list of Urban Centers following Countywide Planning Policy LU-39.

WHEREAS, a goal of the Growth Management Act is to encourage development in Urban Areas where adequate public facilities exist or can be provided in an efficient manner;

WHEREAS, Policy LU-39 of the Countywide Planning Policies of King County describes the criteria for Urban Center designation;

WHEREAS, Policy LU-40 of the Countywide Planning Policies of King County describes standards for planned land uses within Urban Centers;

WHEREAS, the City of Redmond has demonstrated that Overlake meets the criteria for designation as an Urban Center; and

WHEREAS, King County Comprehensive Plan Policy U-108 supports the development of Urban Centers to meet the region's needs for housing, jobs, services, culture and recreation and to promote health.

BE IT RESOLVED THAT THE GROWTH MANAGEMENT PLANNING COUNCIL OF KING COUNTY HEREBY MOVES AS FOLLOWS:

1. The Overlake area of Redmond is designated as an Urban Center. The list of Urban Centers following Countywide Planning Policy LU-39 is modified to include Overlake.
2. This amendment is recommended to the Metropolitan King County Council and the Cities of King County for adoption and ratification.

15709

1  
2  
3  
4  
5  
6  
7

ADOPTED by the Growth Management Planning Council of King County on  
September 20, 2006 in open session and signed by the chair of the GMPC.

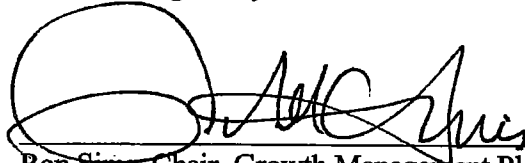

A handwritten signature in black ink, appearing to read "Ron Sims", written over a horizontal line.

Ron Sims, Chair, Growth Management Planning Council

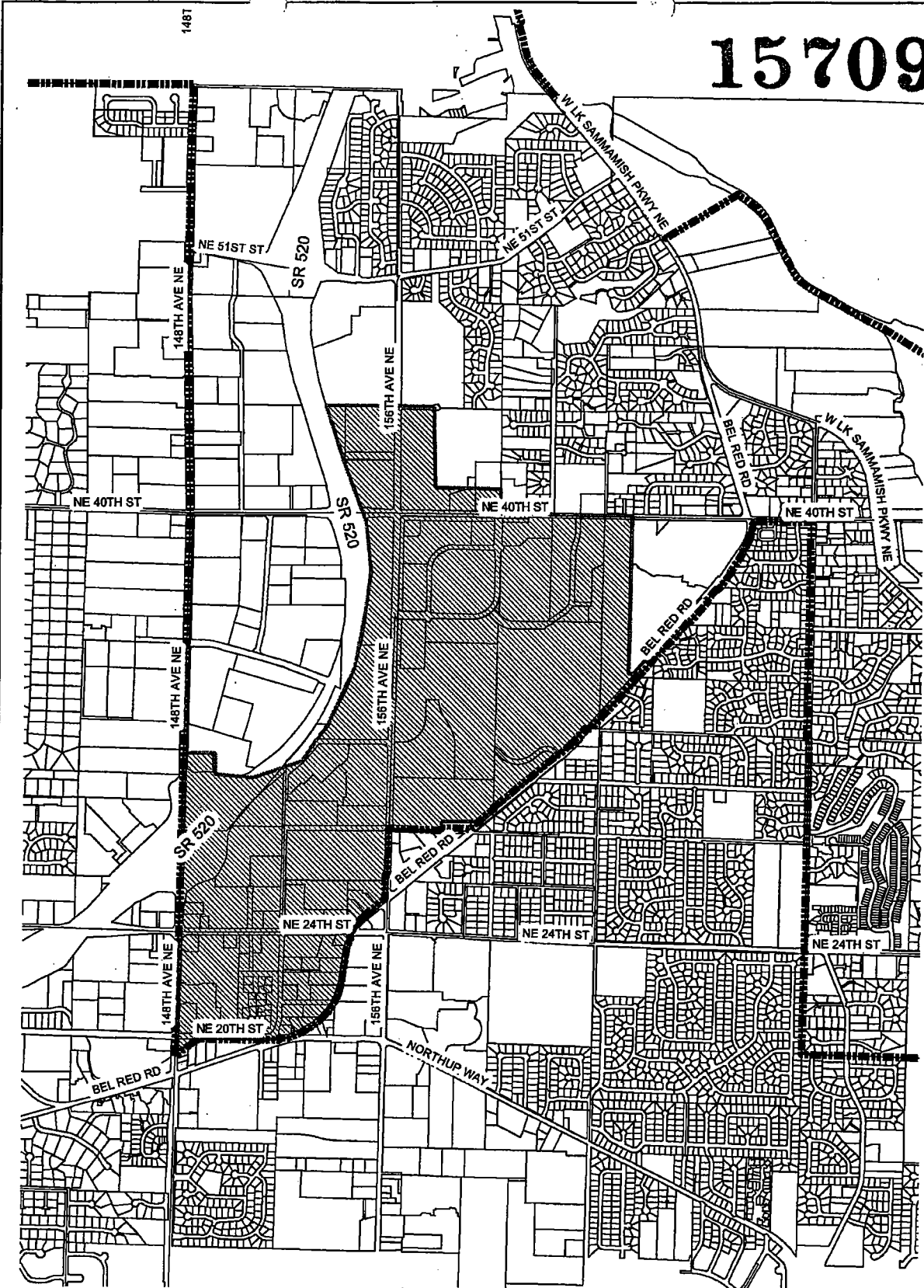
15709



Legend

-  Center
-  City Boundary
-  Parcel Boundaries



# Overlake Urban Center Redmond, WA