



KING COUNTY

1200 King County Courthouse
516 Third Avenue
Seattle, WA 98104

Signature Report

March 19, 2002

Ordinance 14302

Proposed No. 2001-0595.2

Sponsors McKenna

1 AN ORDINANCE relating to the annexation of an area
2 known as Windtree Annexation to Coal Creek Utility
3 District for the purpose of providing future water and sewer
4 service.

5
6

7 **STATEMENT OF FACTS:**

- 8 1. A notice of intention proposing the annexation of an area known as
9 Windtree Annexation for future water and sewer service was filed with
10 the county council on December 4, 2001.
- 11 2. Coal Creek Utility District has found the petition for annexation to be
12 sufficient and has concurred with the proposed annexation in Resolution
13 No. 1597.
- 14 3. Coal Creek Utility District issued a Determination of Nonsignificance
15 on the proposed annexation dated September 21, 2001.
- 16 4. The Utilities Technical Review Committee recommended county
17 council approval of the proposed annexation on January 9, 2002.

18 5. The county council held a public hearing on February 11, 2002 and
19 has considered the criteria set forth in RCW 57.02.040(3).

20 BE IT ORDAINED BY THE COUNCIL OF KING COUNTY:

21 SECTION 1. Findings. The county council finds that:

22 A. The proposed action is in compliance with the county's Comprehensive Plan;

23 B. The proposed action is in compliance with the policies expressed in the
24 district's plan for water or sewage facilities, or both.

25 SECTION 2. After consideration of the criteria listed in RCW 57.02.040(3), the
26 annexation by Coal Creek Utility District of the area known as Windtree Annexation and
27 described in Attachment A to this ordinance is consistent with those criteria and is
28 approved. Pursuant to RCW 57.02.045, this approval is final unless review is taken by
29 the King County boundary review board under chapter 36.93 RCW.

30 SECTION 3. Coal Creek Utility District is the appropriate entity to serve the area
31 proposed to be annexed.

32 SECTION 4. Completion of this annexation does not constitute county approval
33 or disapproval of any other permits, certifications or actions necessary to provide service
34 to this annexation area.
35

Ordinance 14302 was introduced on 1/28/2002 and passed by the Metropolitan King County Council on 3/18/2002, by the following vote:

Yes: 12 - Ms. Sullivan, Ms. Edmonds, Mr. von Reichbauer, Mr. Phillips, Mr. Pelz, Mr. McKenna, Mr. Constantine, Mr. Pullen, Mr. Gossett, Ms. Hague, Mr. Irons and Ms. Patterson
No: 0
Excused: 1 - Ms. Lambert

KING COUNTY COUNCIL
KING COUNTY, WASHINGTON

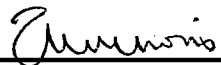

Cynthia Sullivan, Chair

ATTEST:



Anne Noris, Clerk of the Council

APPROVED this 26 day of March, 2002.



Ron Sims, County Executive

Attachments A. Legal Description, B. Maps

EXHIBIT A
COAL CREEK UTILITY DISTRICT
WINDTREE ANNEXATION AREA

THAT PORTION OF THE SOUTHWEST QUARTER OF SECTION 33, TOWNSHIP 24 NORTH, RANGE 5 EAST, WILLAMETTE MERIDIAN, SITUATED IN KING COUNTY, WASHINGTON, DESCRIBED AS FOLLOWS;

BEGINNING AT THE INTERSECTION OF THE WEST LINE OF SAID SOUTHWEST QUARTER AND THE CENTERLINE OF 116TH PLACE SE;

THENCE NORTHERLY ALONG SAID WEST LINE OF SAID QUARTER TO A LINE 330 FEET SOUTH OF AND PARALLEL WITH THE CENTERLINE OF SE 91ST STREET, ALSO KNOWN AS BLANCHE AVENUE;

THENCE EASTERLY ALONG SAID PARALLEL LINE TO THE EASTERLY LINE OF WINDTREE NO. 4 AS RECORDED IN VOLUME 107 OF PLATS, PAGES 66 AND 67, RECORDS OF SAID COUNTY;

THENCE SOUTHERLY ALONG SAID EASTERLY LINE OF WINDTREE NO. 4 AND THE EASTERLY LINE OF WINDTREE NO. 3 AS RECORDED IN VOLUME 107 OF PLATS, PAGES 64 AND 65, RECORDS OF SAID COUNTY, TO THE NORTH MARGIN OF THE ABANDONED P.C.R.R. RIGHT-OF-WAY, SAID MARGIN ALSO BEING THE SOUTH LINE OF WINDTREE NO. 2 AS RECORDED IN VOLUME 95 OF PLATS, PAGES 57 AND 58, RECORDS OF SAID COUNTY;

THENCE NORTHEASTERLY ALONG SAID NORTH MARGIN TO THE WESTERLY LINE OF WINDTREE NO. 5 AS RECORDED IN VOLUME 129 OF PLATS, PAGES 41 THROUGH 43, RECORDS OF SAID COUNTY;

THENCE NORTHERLY ALONG SAID WEST LINE TO A LINE 330 FEET SOUTH OF AND PARALLEL WITH THE CENTERLINE OF SE 91ST STREET (BLANCHE AVENUE);

THENCE EASTERLY ALONG SAID PARALLEL LINE TO THE EAST LINE OF SAID SOUTHWEST QUARTER;

THENCE SOUTHERLY ALONG SAID EAST LINE TO THE SOUTH MARGIN OF GENSING AVENUE;

14302

THENCE SOUTHWESTERLY AND NORTHWESTERLY ALONG SAID SOUTH MARGIN TO THE
EASTERLY LINE OF THE WEST 122 FEET OF LOT 387 OF C.D. HILLMAN'S LAKE
WASHINGTON GARDEN OF EDEN NO. 6 AS RECORDED IN VOLUME 11 OF PLATS, PAGE 84,
RECORDS OF SAID COUNTY;

THENCE SOUTHWESTERLY ALONG SAID EASTERLY LINE TO THE NORTH MARGIN OF SE
95TH WAY, ALSO KNOWN AS BOSS BOULEVARD AND COUNTY ROAD NO. 368;

THENCE SOUTHWESTERLY AND WESTERLY ALONG SAID NORTH MARGIN TO THE WEST
LINE OF THE EAST 1111.28 FEET OF SAID SOUTHWEST QUARTER;

THENCE SOUTH 30 FEET ALONG SAID WEST LINE TO THE SOUTH LINE OF SAID
SOUTHWEST QUARTER;

THENCE WESTERLY ALONG SAID SOUTH LINE TO THE SOUTHEASTERLY PROJECTION OF
THE CENTERLINE OF 116TH PLACE SE;

THENCE NORTHWESTERLY ALONG SAID PROJECTION AND CENTERLINE TO THE WEST
LINE OF SAID SOUTHWEST QUARTER AND THE POINT OF BEGINNING.

14302

ATTACHMENT B

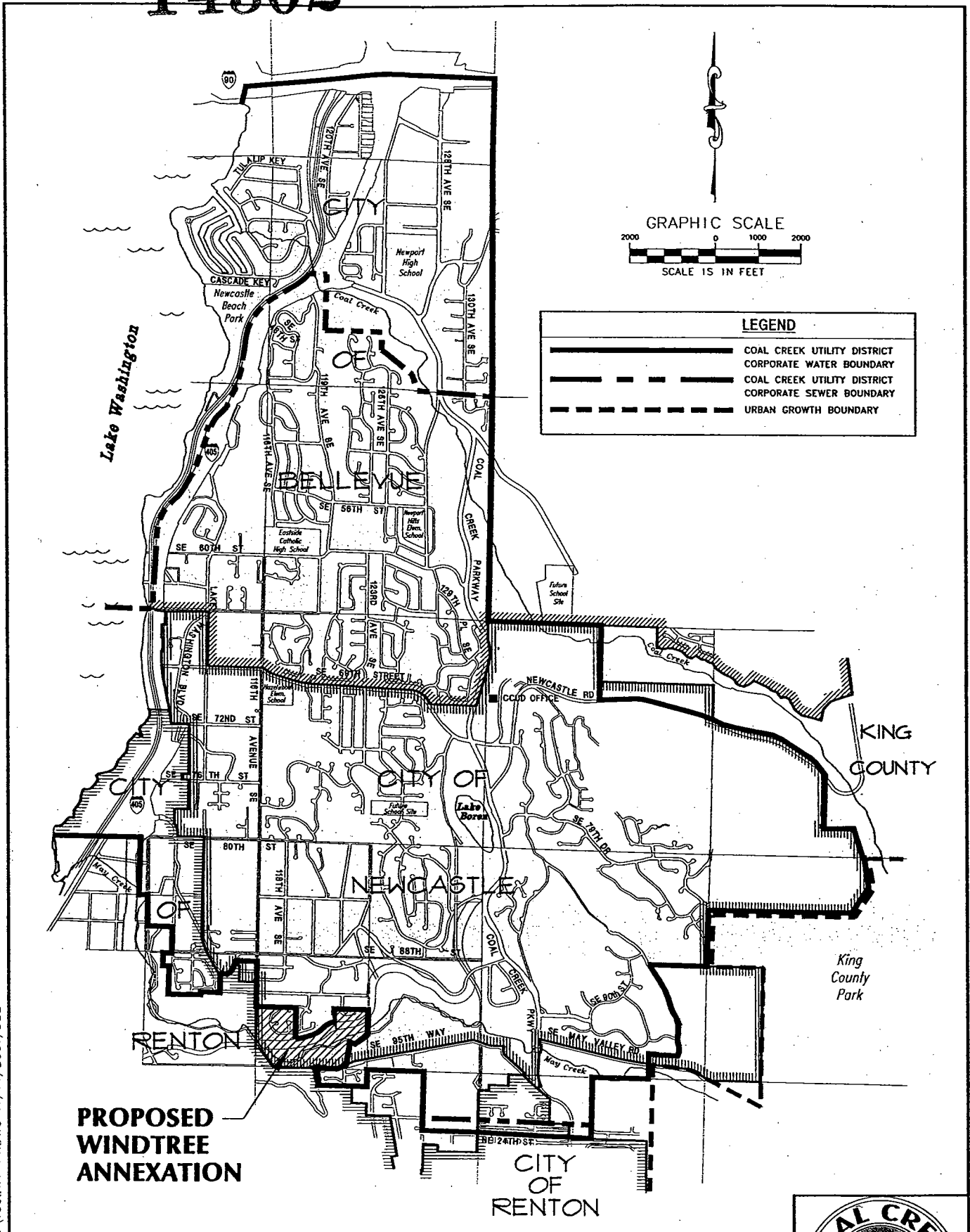

p:\P01\91002\CAD\1002WT-F1.DWG 11/14/2001/DBB

PROPOSED WINDTREE ANNEXATION

CITY OF RENTON



Penhallegon Associates Consulting Engineers
www.paceengrs.com 1-800-945-8408

**Exhibit D-1
Vicinity Map
WINDTREE ANNEXATION**



14302

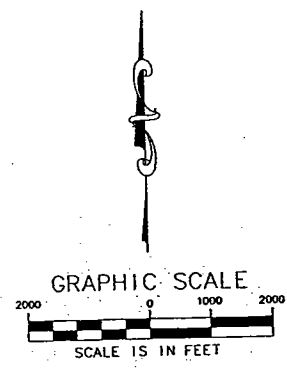
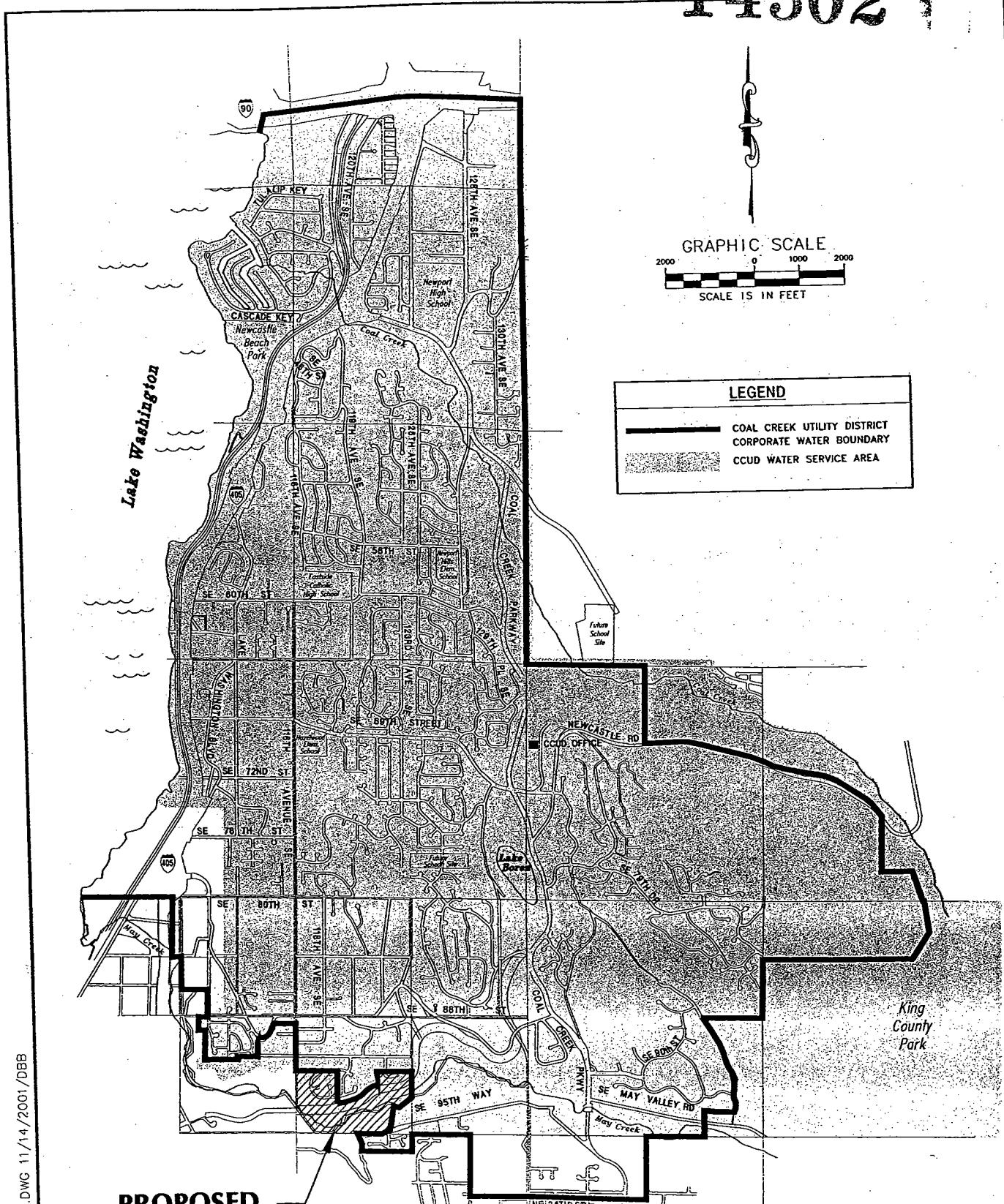

LEGEND	
	COAL CREEK UTILITY DISTRICT CORPORATE WATER BOUNDARY
	CCUD WATER SERVICE AREA

PROPOSED WINDTREE ANNEXATION

S:\P01\91002\CAD\1002WT-F2.DWG 11/14/2001/DBB



Penhallegon Associates Consulting Engineers
www.paceengrs.com 1-800-945-8408

Exhibit D-2

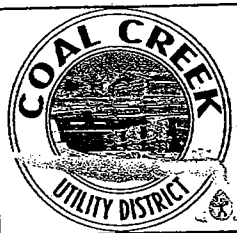

Water District Boundaries and Annexation Area
WINDTREE ANNEXATION

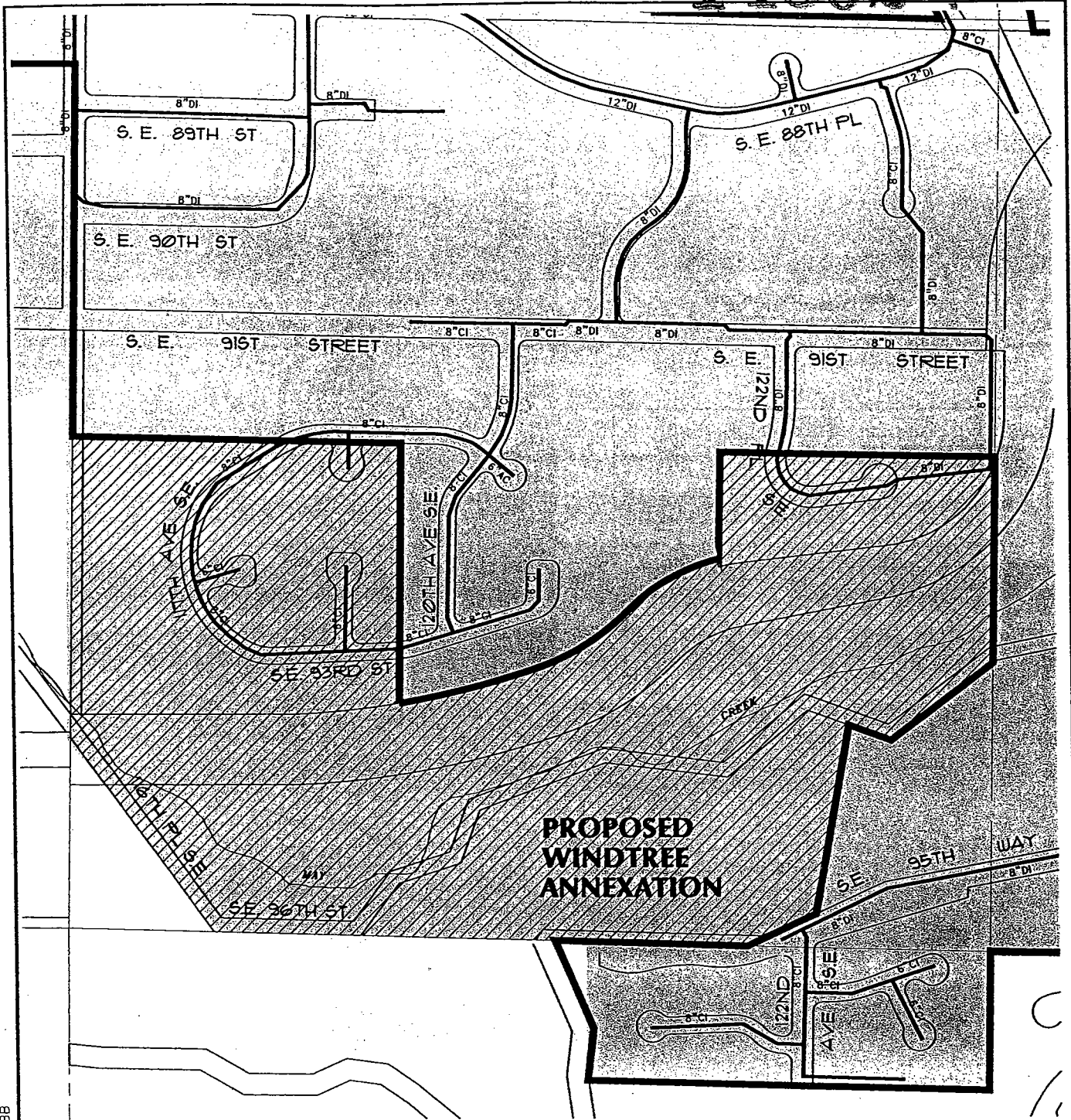

14302



**PROPOSED
WINDTREE
ANNEXATION**

LEGEND	
	COAL CREEK UTILITY DISTRICT CORPORATE WATER BOUNDARY
	CCUD WATER SERVICE AREA

P:\P01\91002\CAD\1002WT-F3.DWG 11/14/2001/DBB



Penhallegon Associates Consulting Engineers
www.paceengrs.com 1-800-945-8408

Exhibit D-3 Water System Map WINDTREE ANNEXATION

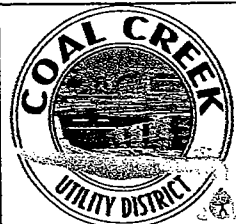

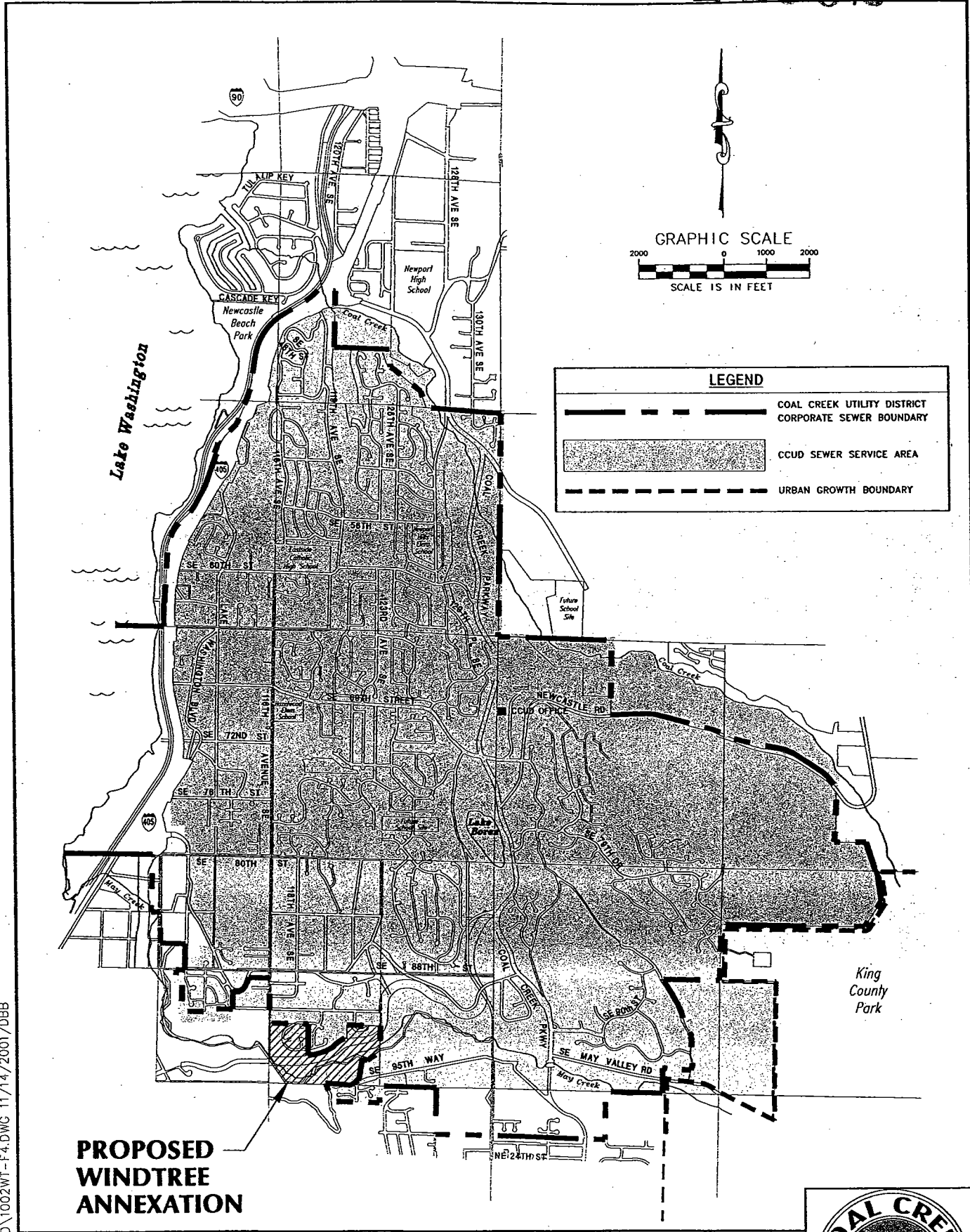

**PROPOSED
WINDTREE
ANNEXATION**

p:\PO1\01002\CAD\1002WT-F4.DWG 11/14/2001/DBB



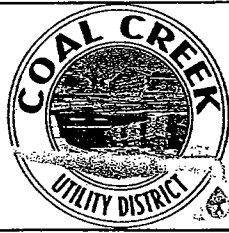

Penhallegon Associates Consulting Engineers
www.paceengrs.com 1-800-945-8408

**Exhibit D-4
Sewer District Boundaries and Annexation Area
WINDTREE ANNEXATION**

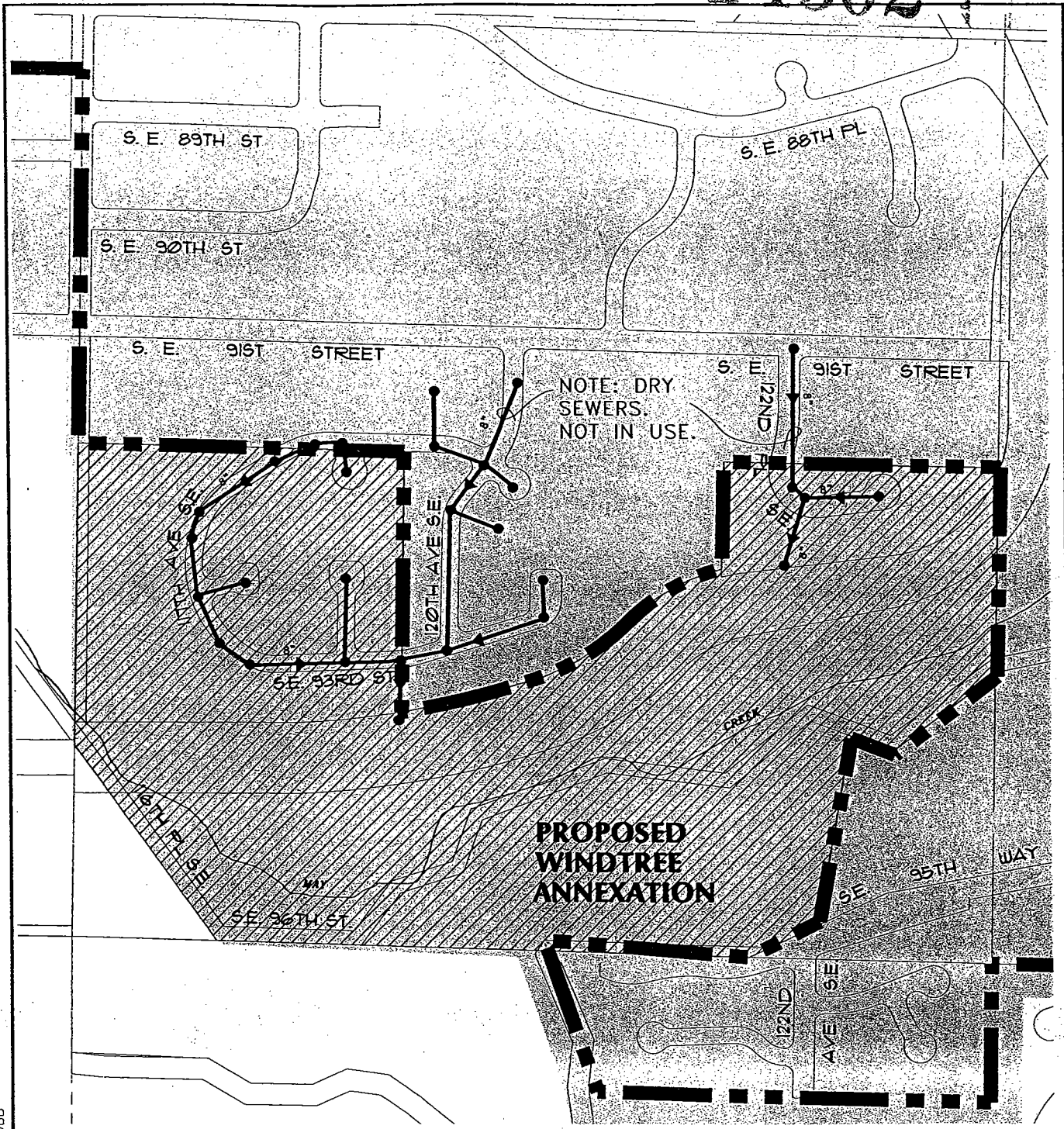

14302



LEGEND	
	COAL CREEK UTILITY DISTRICT CORPORATE SEWER BOUNDARY
	CCUD SEWER SERVICE AREA

p:\P01\01002\CAD\1002WT-F5.DWG 11/14/2001/DBB



Penhallegon Associates Consulting Engineers
www.paceengrs.com 1-800-945-8408

Exhibit D-5 Sewer System Map WINDTREE ANNEXATION

