



EXISTING CONDITIONS

WSP FIRE TRAINING ACADEMY, NORTH BEND | KING COUNTY FILE LUT418-0002 SUPPLEMENTAL INFORMATION | JULY 2, 2020



RICER *fergus* **MILLER**

Exhibit no.	A1
Case name	Washington State Patrol Fire Training Academy
Case number	LUT418-0002
Date received	7/2/2020
KING COUNTY HEARING EXAMINER	



EXISTING CONDITIONS

RICE
ambrogio
fergus
MILLER
 ARCHITECTS & PLANNERS
 275 FIFTH STREET
 SUITE 100
 BREMERTON, WA 98327
 (360) 377-8773
 FAX: 753-1385
 INFO@RMAFCY.COM

4754 REGISTERED ARCHITECT
 DAVID A. FERGUS
 STATE OF WASHINGTON

WASHINGTON STATE PATROL
WSP FTA SPECIAL USE PERMIT
 50810 SE GROUSE RIDGE, NORTH BEND, WA 98045

PROJECT # 201506.03
 SPECIAL USE PERMIT
 ISSUED: AUGUST 8, 2014
 REVISION SCHEDULE

PHASE ONE SITE PLAN

SHEET:
A10.1

LEGEND - DRAWING

- BUILDINGS**
- EXISTING BUILDING
 - EXISTING PAVED SURFACE
 - EXISTING GRAVEL SURFACE
 - NEW PAVED SURFACE
 - NEW BUILDING
 - BUILDING KEYNOTE
- TREES**
- EXISTING TREES TO REMAIN
 - EXISTING TREES TO BE REMOVED
 - SIGNIFICANT TREE KEYNOTE (TREES IN DIAMETER 8" OR GREATER)

LEGEND - PHASE 1

Number	Description	Square Foot Total	Renovation
01	EXISTING CORNARY	1866 SF	Yes
04A	EXISTING APPF & SUPPORT BUILDING	11746 SF	Yes
04B	EXISTING APPF & SUPPORT BUILDING	2512 SF	Yes
05	NEW FEEDS BUILDING	1306 SF	Yes
06	NEW COMMERCIAL COVER BUILDING	1263 SF	Yes
09	EXISTING BURN BUILDING	2776 SF	Yes
12	NEW PRESIDENTIAL COVER BUILDING	4000 SF	Yes
14	EXISTING ACORN BUILDING	4026 SF	Yes
15	NEW APARTMENT BURN BUILDING	7675 SF	Yes
16	NEW PALLET STORAGE BUILDING	1000 SF	Yes
17	EXISTING MAINTENANCE STORAGE BUILDING	3000 SF	Yes
20	EXISTING MAINTENANCE STORAGE BUILDING	1000 SF	Yes
23	EXISTING ACORN BUILDING	4000 SF	Yes
24	EXISTING ACORN BUILDING	4000 SF	Yes
25	EXISTING ACORN BUILDING	4000 SF	Yes
26	EXISTING ACORN BUILDING	4000 SF	Yes
27	EXISTING ACORN BUILDING	4000 SF	Yes
28	EXISTING ACORN BUILDING	4000 SF	Yes
29	EXISTING ACORN BUILDING	4000 SF	Yes
30	EXISTING ACORN BUILDING	4000 SF	Yes
31	EXISTING ACORN BUILDING	4000 SF	Yes
32	EXISTING ACORN BUILDING	4000 SF	Yes
33	EXISTING ACORN BUILDING	4000 SF	Yes
34	EXISTING ACORN BUILDING	4000 SF	Yes
35	EXISTING ACORN BUILDING	4000 SF	Yes
36	EXISTING ACORN BUILDING	4000 SF	Yes
37	EXISTING ACORN BUILDING	4000 SF	Yes
38	EXISTING ACORN BUILDING	4000 SF	Yes
39	EXISTING ACORN BUILDING	4000 SF	Yes
40	EXISTING ACORN BUILDING	4000 SF	Yes
41	EXISTING ACORN BUILDING	4000 SF	Yes
42	EXISTING ACORN BUILDING	4000 SF	Yes
43	EXISTING ACORN BUILDING	4000 SF	Yes
44	EXISTING ACORN BUILDING	4000 SF	Yes
45	EXISTING ACORN BUILDING	4000 SF	Yes
46	EXISTING ACORN BUILDING	4000 SF	Yes
47	EXISTING ACORN BUILDING	4000 SF	Yes
48	EXISTING ACORN BUILDING	4000 SF	Yes
49	EXISTING ACORN BUILDING	4000 SF	Yes
50	EXISTING ACORN BUILDING	4000 SF	Yes
51	EXISTING ACORN BUILDING	4000 SF	Yes
52	EXISTING ACORN BUILDING	4000 SF	Yes
53	EXISTING ACORN BUILDING	4000 SF	Yes
54	EXISTING ACORN BUILDING	4000 SF	Yes
55	EXISTING ACORN BUILDING	4000 SF	Yes
56	EXISTING ACORN BUILDING	4000 SF	Yes
57	EXISTING ACORN BUILDING	4000 SF	Yes
58	EXISTING ACORN BUILDING	4000 SF	Yes
59	EXISTING ACORN BUILDING	4000 SF	Yes
60	EXISTING ACORN BUILDING	4000 SF	Yes
61	EXISTING ACORN BUILDING	4000 SF	Yes
62	EXISTING ACORN BUILDING	4000 SF	Yes
63	EXISTING ACORN BUILDING	4000 SF	Yes
64	EXISTING ACORN BUILDING	4000 SF	Yes
65	EXISTING ACORN BUILDING	4000 SF	Yes
66	EXISTING ACORN BUILDING	4000 SF	Yes
67	EXISTING ACORN BUILDING	4000 SF	Yes
68	EXISTING ACORN BUILDING	4000 SF	Yes
69	EXISTING ACORN BUILDING	4000 SF	Yes
70	EXISTING ACORN BUILDING	4000 SF	Yes
71	EXISTING ACORN BUILDING	4000 SF	Yes
72	EXISTING ACORN BUILDING	4000 SF	Yes
73	EXISTING ACORN BUILDING	4000 SF	Yes
74	EXISTING ACORN BUILDING	4000 SF	Yes
75	EXISTING ACORN BUILDING	4000 SF	Yes
76	EXISTING ACORN BUILDING	4000 SF	Yes
77	EXISTING ACORN BUILDING	4000 SF	Yes
78	EXISTING ACORN BUILDING	4000 SF	Yes
79	EXISTING ACORN BUILDING	4000 SF	Yes
80	EXISTING ACORN BUILDING	4000 SF	Yes
81	EXISTING ACORN BUILDING	4000 SF	Yes
82	EXISTING ACORN BUILDING	4000 SF	Yes
83	EXISTING ACORN BUILDING	4000 SF	Yes
84	EXISTING ACORN BUILDING	4000 SF	Yes
85	EXISTING ACORN BUILDING	4000 SF	Yes
86	EXISTING ACORN BUILDING	4000 SF	Yes
87	EXISTING ACORN BUILDING	4000 SF	Yes
88	EXISTING ACORN BUILDING	4000 SF	Yes
89	EXISTING ACORN BUILDING	4000 SF	Yes
90	EXISTING ACORN BUILDING	4000 SF	Yes
91	EXISTING ACORN BUILDING	4000 SF	Yes
92	EXISTING ACORN BUILDING	4000 SF	Yes
93	EXISTING ACORN BUILDING	4000 SF	Yes
94	EXISTING ACORN BUILDING	4000 SF	Yes
95	EXISTING ACORN BUILDING	4000 SF	Yes
96	EXISTING ACORN BUILDING	4000 SF	Yes
97	EXISTING ACORN BUILDING	4000 SF	Yes
98	EXISTING ACORN BUILDING	4000 SF	Yes
99	EXISTING ACORN BUILDING	4000 SF	Yes
100	EXISTING ACORN BUILDING	4000 SF	Yes

LEGEND - PHASE 1 SIGNIFICANT TREES

Number	Species	Approximate Base Diameter	Removal
1	DOUGLAS FIR	20"	Yes
2	DOUGLAS FIR	20"	Yes
3	DOUGLAS FIR	20"	Yes
4	DOUGLAS FIR	20"	Yes
5	DOUGLAS FIR	20"	Yes
6	DOUGLAS FIR	20"	Yes
7	ALDER	12"	Yes
8	ALDER	12"	Yes
9	ALDER	12"	Yes
10	ALDER	12"	Yes

NOTES
 *ATTENTION: A SMALL NUMBER OF ALDER TREES 4" TO 10" IN BASE DIAMETER TO BE REMOVED NEAR BUILDING 12 FOR CONSTRUCTION OF BURN

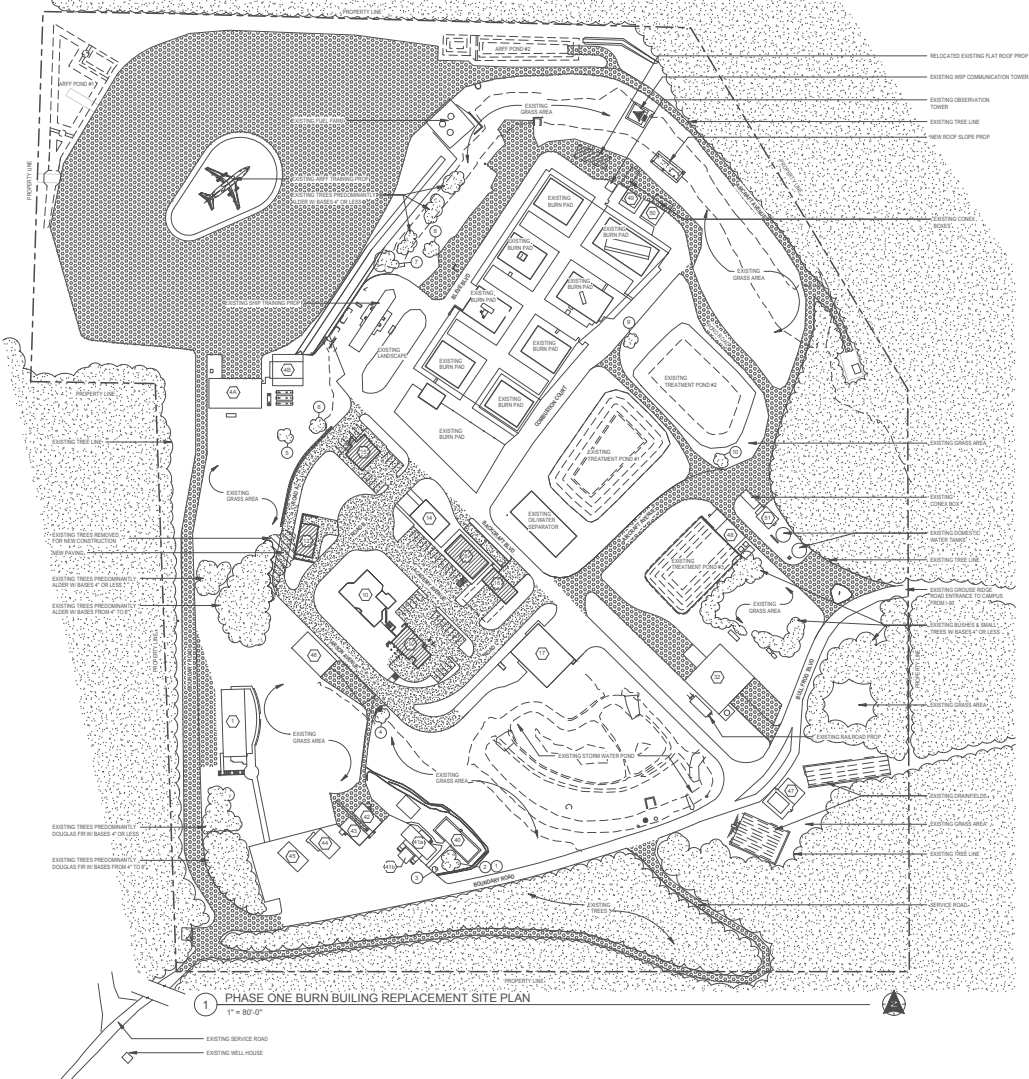

1 PHASE ONE BURN BUILDING REPLACEMENT SITE PLAN
 1" = 80'-0"

RICE
ARCHITECTURE
& PLANNING
MILLER

275 FIFTH STREET
SUITE 100
BREMERTON, WA 98521
(360) 377-8773
FAX: 736-1388
INFO@RFMARCH.COM



WASHINGTON STATE PATROL
WSP FTA SPECIAL USE PERMIT
50810 SE GROUSE RIDGE, NORTH BEND, WA 98045

PROJECT # 2013066.00
SPECIAL USE PERMIT
ISSUED: AUGUST 8, 2018

REVISION	DATE	DESCRIPTION

PHASE THREE SITE PLAN

SHEET:
A10.3

LEGEND - DRAWING

- | | | | |
|--|-------------------------|--|---|
| | EXISTING BUILDING | | EXISTING TREES TO REMAIN |
| | EXISTING PAVED SURFACE | | EXISTING TREES TO BE REMOVED |
| | EXISTING GRAVEL SURFACE | | SIGNIFICANT TREE KEYNOTE
(TREES W/ DIAMETER 8" OR GREATER) |
| | NEW PAVED SURFACE | | |
| | NEW BUILDING | | |
| | BUILDING KEYNOTE | | |

LEGEND - PHASE 3

Number	Description	Square Foot Total	Removal
1	EXISTING LABORATORY	8490 SF	Yes
AA	EXISTING ARFF & SUPPORT BUILDING	8850 SF	Yes
AB	EXISTING ARFF & SUPPORT BUILDING	2130 SF	Yes
AC	EXISTING ADMINISTRATIVE CLASSROOM/STORAGE BUILDING	4500 SF	Yes
AD	EXISTING REPAIR BUILDING	1200 SF	Yes
AE	EXISTING COMMERCIAL TOWER BURN BUILDING	3900 SF	Yes
AF	EXISTING BURN BUILDING	1700 SF	Yes
AG	EXISTING PRESIDENTIAL BURN BUILDING	8800 SF	Yes
AH	EXISTING BURN BUILDING	2400 SF	Yes
AI	EXISTING APARTMENT BURN BUILDING	9170 SF	Yes
AJ	EXISTING PALLET STORAGE BUILDING	1800 SF	Yes
AK	EXISTING PALLET STORAGE BUILDING	2870 SF	Yes
AL	EXISTING MAINTENANCE/TORQUE BUILDING	1800 SF	Yes
AM	NEW BOCK HANGAR	7400 SF	No
AN	EXISTING HONOLULU SANITARIUM TRAINING BUILDING	1700 SF	Yes
AO	EXISTING ANDON INVESTIGATION BUILDING	2240 SF	Yes
AP	EXISTING ARFF FACILITY	1100 SF	Yes
AQ	EXISTING ARFF PROTECTIVE/STAMP HOUSE	1240 SF	Yes
AR	EXISTING SUPPORT BUILDING	200 SF	Yes
AS	EXISTING STORAGE/TORQUE CLASSROOM BUILDING	873 SF	Yes
AT	EXISTING DOMESTIC WATER PUMP BUILDING	100 SF	Yes
		14820 SF	

LEGEND - PHASE 3 SIGNIFICANT TREES

Number	Species	Approximate Base Diameter	Removal
1	DOUGLASS FIR	24"	Yes
2	DOUGLASS FIR	22"	Yes
3	DOUGLASS FIR	12"	Yes
4	DOUGLASS FIR	12"	Yes
5	DOUGLASS FIR	12"	Yes
6	DOUGLASS FIR	12"	Yes
7	ALDER	12"	Yes
8	ALDER	12"	Yes
9	ALDER	8"	Yes
10	ALDER	8"	Yes

NOTE:
ALL TREES & SMALL NUMBER OF ALDER TREES 4" TO 12" IN BASE DIAMETER TO BE REMOVED NEAR EXISTING SWP TRAINING POND FOR CONSTRUCTION OF MARINE LOOP RD.

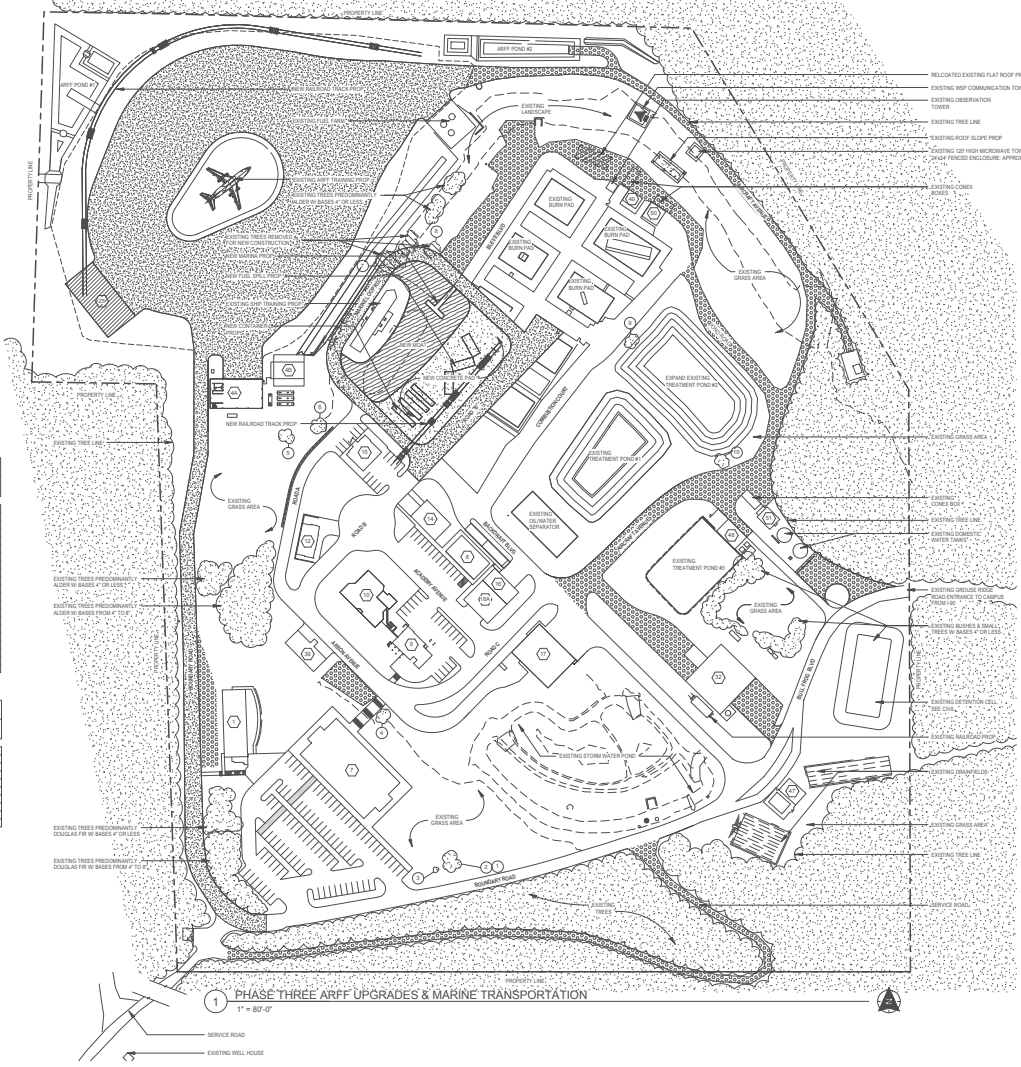

PHASE THREE ARFF UPGRADES & MARINE TRANSPORTATION
1" = 80'-0"

-
-

LEGEND - DRAWING

- BUILDING
- EXISTING BUILDING
- EXISTING PAVED SURFACE
- EXISTING GRAVEL SURFACE
- NEW PAVED SURFACE
- NEW BUILDING
- BUILDING KEYNOTE
- TREE
- EXISTING TREES TO REMAIN
- EXISTING TREES TO BE REMOVED
- SIGNIFICANT TREE KEYNOTE (TREES IN DIAMETER OF GREATER)

LEGEND - PHASE 6				
Number	Description	Square Foot Total	Renovation	
1	EXISTING CORRIDORY	3644 SF	NO	
2	EXISTING SHIP FINDER BUILDING	2432 SF	NO	
3	EXISTING AMP & SUPPORT BUILDING	2022 SF	NO	
4	EXISTING AMP & SUPPORT BUILDING	2100 SF	NO	
5	EXISTING ADMINISTRATIVE CLASSROOMING BUILDING	12027 SF	NO	
6	EXISTING BURN BUILDING	1200 SF	NO	
7	EXISTING COMMERCIAL TOWER BURN BUILDING	12923 SF	NO	
8	EXISTING BURN BUILDING	1784 SF	NO	
9	EXISTING RESIDENTIAL BURN BUILDING	2080 SF	NO	
10	EXISTING BURN BUILDING	1784 SF	NO	
11	EXISTING APARTMENT BURN BUILDING	1975 SF	NO	
12	EXISTING BURN BUILDING	1784 SF	NO	
13	EXISTING PALLET STORAGE BUILDING	2070 SF	NO	
14	EXISTING PALLET STORAGE BUILDING	2070 SF	NO	
15	EXISTING MOTOR CHANGING	1400 SF	NO	
16	NEW HAZARDOUS MATERIALS TRAINING BUILDING	1781 SF	NO	
17	NEW HAZARDOUS MATERIALS TRAINING BUILDING	1781 SF	NO	
18	EXISTING COVERED OUTDOOR CLASSROOM WITH SYSTEM'S ROOM SUPPORT	1280 SF	NO	
19	EXISTING HAZARDOUS MATERIALS TRAINING BUILDING	2008 SF	NO	
20	EXISTING AMBULANCE BAY	1784 SF	NO	
21	EXISTING AMBULANCE BAY	1784 SF	NO	
22	EXISTING FIRE PROTECTION PUMP HOUSE	1348 SF	NO	
23	EXISTING DOMESTIC WATER PUMP BUILDING	287 SF	NO	
24	EXISTING DOMESTIC WATER PUMP BUILDING	287 SF	NO	
25	EXISTING DOMESTIC WATER PUMP BUILDING	287 SF	NO	
26	EXISTING DOMESTIC WATER PUMP BUILDING	287 SF	NO	
27	EXISTING DOMESTIC WATER PUMP BUILDING	287 SF	NO	
28	EXISTING DOMESTIC WATER PUMP BUILDING	287 SF	NO	
29	EXISTING DOMESTIC WATER PUMP BUILDING	287 SF	NO	
30	EXISTING DOMESTIC WATER PUMP BUILDING	287 SF	NO	
31	EXISTING DOMESTIC WATER PUMP BUILDING	287 SF	NO	
32	EXISTING DOMESTIC WATER PUMP BUILDING	287 SF	NO	
33	EXISTING DOMESTIC WATER PUMP BUILDING	287 SF	NO	
34	EXISTING DOMESTIC WATER PUMP BUILDING	287 SF	NO	
35	EXISTING DOMESTIC WATER PUMP BUILDING	287 SF	NO	
36	EXISTING DOMESTIC WATER PUMP BUILDING	287 SF	NO	
37	EXISTING DOMESTIC WATER PUMP BUILDING	287 SF	NO	
38	EXISTING DOMESTIC WATER PUMP BUILDING	287 SF	NO	
39	EXISTING DOMESTIC WATER PUMP BUILDING	287 SF	NO	
40	EXISTING DOMESTIC WATER PUMP BUILDING	287 SF	NO	
41	EXISTING DOMESTIC WATER PUMP BUILDING	287 SF	NO	
42	EXISTING DOMESTIC WATER PUMP BUILDING	287 SF	NO	
43	EXISTING DOMESTIC WATER PUMP BUILDING	287 SF	NO	
44	EXISTING DOMESTIC WATER PUMP BUILDING	287 SF	NO	
45	EXISTING DOMESTIC WATER PUMP BUILDING	287 SF	NO	
46	EXISTING DOMESTIC WATER PUMP BUILDING	287 SF	NO	
47	EXISTING DOMESTIC WATER PUMP BUILDING	287 SF	NO	
48	EXISTING DOMESTIC WATER PUMP BUILDING	287 SF	NO	
49	EXISTING DOMESTIC WATER PUMP BUILDING	287 SF	NO	
50	EXISTING DOMESTIC WATER PUMP BUILDING	287 SF	NO	
51	EXISTING DOMESTIC WATER PUMP BUILDING	287 SF	NO	
52	EXISTING DOMESTIC WATER PUMP BUILDING	287 SF	NO	
53	EXISTING DOMESTIC WATER PUMP BUILDING	287 SF	NO	
54	EXISTING DOMESTIC WATER PUMP BUILDING	287 SF	NO	
55	EXISTING DOMESTIC WATER PUMP BUILDING	287 SF	NO	
56	EXISTING DOMESTIC WATER PUMP BUILDING	287 SF	NO	
57	EXISTING DOMESTIC WATER PUMP BUILDING	287 SF	NO	
58	EXISTING DOMESTIC WATER PUMP BUILDING	287 SF	NO	
59	EXISTING DOMESTIC WATER PUMP BUILDING	287 SF	NO	
60	EXISTING DOMESTIC WATER PUMP BUILDING	287 SF	NO	
61	EXISTING DOMESTIC WATER PUMP BUILDING	287 SF	NO	
62	EXISTING DOMESTIC WATER PUMP BUILDING	287 SF	NO	
63	EXISTING DOMESTIC WATER PUMP BUILDING	287 SF	NO	
64	EXISTING DOMESTIC WATER PUMP BUILDING	287 SF	NO	
65	EXISTING DOMESTIC WATER PUMP BUILDING	287 SF	NO	
66	EXISTING DOMESTIC WATER PUMP BUILDING	287 SF	NO	
67	EXISTING DOMESTIC WATER PUMP BUILDING	287 SF	NO	
68	EXISTING DOMESTIC WATER PUMP BUILDING	287 SF	NO	
69	EXISTING DOMESTIC WATER PUMP BUILDING	287 SF	NO	
70	EXISTING DOMESTIC WATER PUMP BUILDING	287 SF	NO	
71	EXISTING DOMESTIC WATER PUMP BUILDING	287 SF	NO	
72	EXISTING DOMESTIC WATER PUMP BUILDING	287 SF	NO	
73	EXISTING DOMESTIC WATER PUMP BUILDING	287 SF	NO	
74	EXISTING DOMESTIC WATER PUMP BUILDING	287 SF	NO	
75	EXISTING DOMESTIC WATER PUMP BUILDING	287 SF	NO	
76	EXISTING DOMESTIC WATER PUMP BUILDING	287 SF	NO	
77	EXISTING DOMESTIC WATER PUMP BUILDING	287 SF	NO	
78	EXISTING DOMESTIC WATER PUMP BUILDING	287 SF	NO	
79	EXISTING DOMESTIC WATER PUMP BUILDING	287 SF	NO	
80	EXISTING DOMESTIC WATER PUMP BUILDING	287 SF	NO	
81	EXISTING DOMESTIC WATER PUMP BUILDING	287 SF	NO	
82	EXISTING DOMESTIC WATER PUMP BUILDING	287 SF	NO	
83	EXISTING DOMESTIC WATER PUMP BUILDING	287 SF	NO	
84	EXISTING DOMESTIC WATER PUMP BUILDING	287 SF	NO	
85	EXISTING DOMESTIC WATER PUMP BUILDING	287 SF	NO	
86	EXISTING DOMESTIC WATER PUMP BUILDING	287 SF	NO	
87	EXISTING DOMESTIC WATER PUMP BUILDING	287 SF	NO	
88	EXISTING DOMESTIC WATER PUMP BUILDING	287 SF	NO	
89	EXISTING DOMESTIC WATER PUMP BUILDING	287 SF	NO	
90	EXISTING DOMESTIC WATER PUMP BUILDING	287 SF	NO	
91	EXISTING DOMESTIC WATER PUMP BUILDING	287 SF	NO	
92	EXISTING DOMESTIC WATER PUMP BUILDING	287 SF	NO	
93	EXISTING DOMESTIC WATER PUMP BUILDING	287 SF	NO	
94	EXISTING DOMESTIC WATER PUMP BUILDING	287 SF	NO	
95	EXISTING DOMESTIC WATER PUMP BUILDING	287 SF	NO	
96	EXISTING DOMESTIC WATER PUMP BUILDING	287 SF	NO	
97	EXISTING DOMESTIC WATER PUMP BUILDING	287 SF	NO	
98	EXISTING DOMESTIC WATER PUMP BUILDING	287 SF	NO	
99	EXISTING DOMESTIC WATER PUMP BUILDING	287 SF	NO	
100	EXISTING DOMESTIC WATER PUMP BUILDING	287 SF	NO	

LEGEND - PHASE 6 SIGNIFICANT TREES				
Number	Species	Approximate Base Diameter	Removal	
1	DOUGLASS FIR	8"	NO	
2	DOUGLASS FIR	8"	NO	
3	DOUGLASS FIR	8"	NO	
4	DOUGLASS FIR	8"	NO	
5	ALDER	8"	NO	

NOTE: SPECIFY A SMALL NUMBER OF ALDER TREES LESS THAN 4" IN BASE DIAMETER TO BE REMOVED NEAR EXISTING FUEL TANKS FOR CONSTRUCTION OF NEW COVERED OUTDOOR CLASSROOM BUILDING 26.

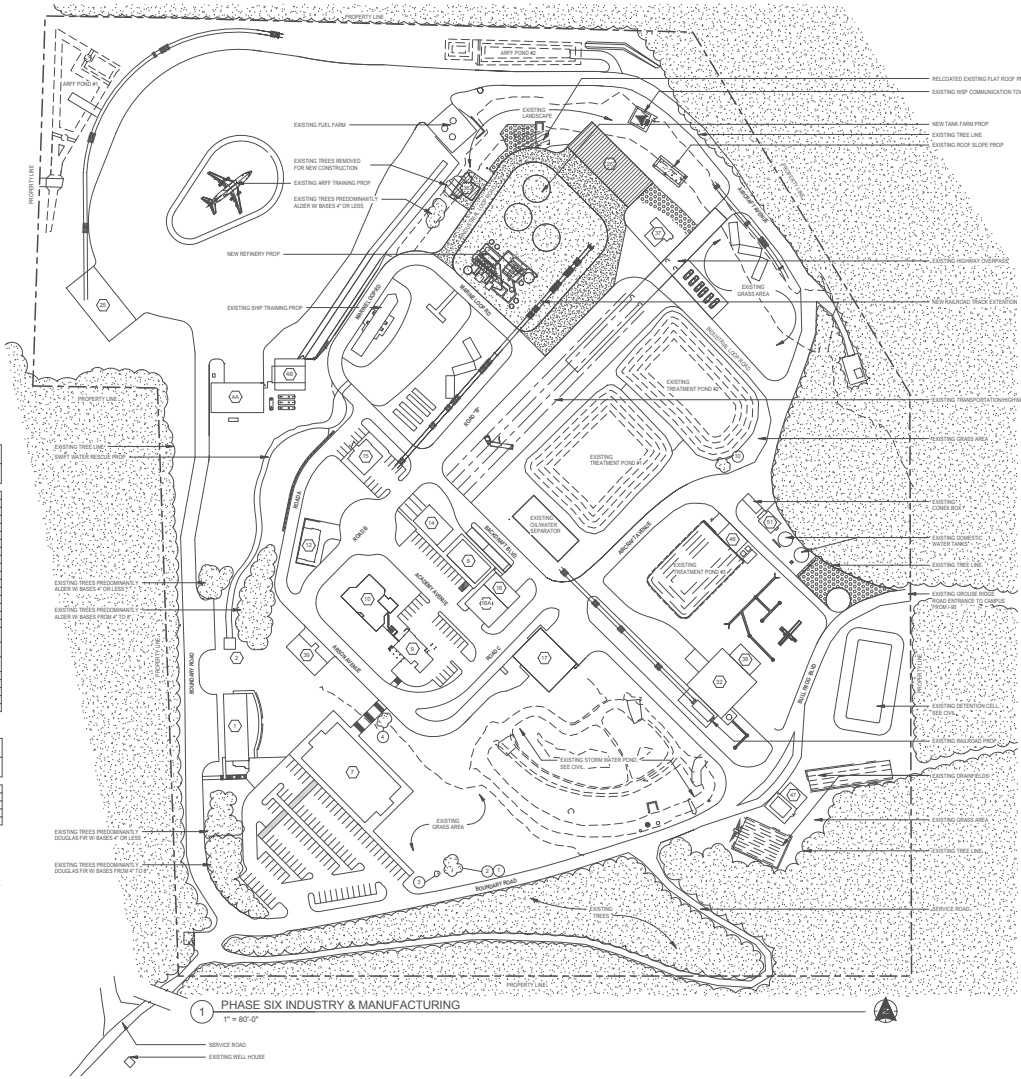

RICE Ferguson MILLER
 275 FIFTH STREET
 SUITE 100
 BREMERTON, WA 98507
 (360) 377-8723
 FAX: 736-7385
 INFO@RFMARCH.COM

474 REGISTERED ARCHITECT
 DAVID A. FERDUS
 STATE OF WASHINGTON

**WASHINGTON STATE PATROL
 WSP FTA SPECIAL USE PERMIT**
 50810 SE GROUSE RIDGE, NORTH BEND, WA 98045

PROJECT #	2013066.01
SPECIAL USE PERMIT	
ISSUED	AUGUST 9, 2018
REVISION SCHEDULE	

PHASE SIX SITE PLAN

SHEET: **A10.6**