

# EXHIBIT D

## LEGAL DESCRIPTIONS

### PARCEL 1: 292303-9261

No address

That portion of the southwest quarter of the northeast quarter of Section 29, Township 23 North, Range 3 East, W.M., King County, Washington lying southerly of county road No. 1210 and easterly of the centerline of a 100-ft. strip center line of which begins at a point on the south line of said southwest quarter of the northeast quarter, 1198.60 feet from the southeast comer of said subdivision;

thence N 19 20'00"W, 223.50 feet;

thence N 33 32'50"W, 144.50 feet;

thence N 56 56'00"W, 110.90 feet;

thence N 17 25'40"W, 353.30 feet;

thence N 68 09'10"W, 328.00 feet;

thence N 14 52'20"W, 276.70 feet;

thence N 07 46'00"W, 80 feet, more or less, to said road;

EXCEPT any portion lying within Lots 1 and 2 of King County Short Plat No. S91S0086 as recorded in Volume 97 of Surveys on page 285, Records of said county.

### PARCEL 2: 292303-9269

8736 SW Gorsuch Rd.

Vashon, WA 98070

Parcel 2923039269 of King County BLA recording number 20060509001598.

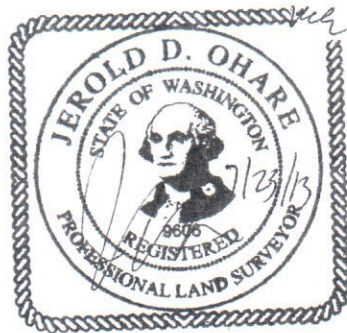

July 23, 2013