



**KING COUNTY**  
**Signature Report**

1200 King County Courthouse  
516 Third Avenue  
Seattle, WA 98104

**December 3, 2012**

**Ordinance 17487**

**Proposed No. 2012-0436.2**

**Sponsors Phillips**

1 AN ORDINANCE adopting Growth Management Planning  
2 Council Motion 12-5 and ratifying Motion 12-5 for  
3 unincorporated King County.

4 STATEMENT OF FACTS:

5 1. The Countywide Planning Policies ("CPPs") are adopted in accordance  
6 with the state Growth Management Act, under 36.70A.210 RCW.

7 2. The Growth Management Planning Council ("GMPC") was formed in  
8 1992 to guide the development of the CPPs. The GMPC is a  
9 representative body of elected officials from King County, the city of  
10 Seattle, the city of Bellevue and the Suburban Cities Association.

11 Representatives of the special districts serve as ex officio members.

12 3. The CPPs establish a framework for guiding development in all King  
13 County jurisdictions.

14 4. The CPPs are deemed adopted when ratified by King County and the  
15 requisite number of cities and satisfying the required population  
16 percentage.

17 5. The GMPC recommends CPP amendments to the King County council  
18 for consideration, possible revision and ratification.

19 BE IT ORDAINED BY THE COUNCIL OF KING COUNTY:

20            SECTION 1. Findings:

21            A. On June 6, 2012, the Growth Management Planning Council introduced  
22 Motion 12-5 listing the proposed changes to the urban growth area then under  
23 consideration by the King County Council and accepted public testimony regarding the  
24 proposed changes.

25            B. On September 11, 2012, the Growth Management Planning Council approved  
26 Motion 12-5 following additional public testimony regarding the proposed changes to the  
27 urban growth area.

28            C. Attachment A to this ordinance incorporates Motion 12-5.

29            SECTION 2. The amendments to 2012 King County Planning Policies, as shown

30 in Attachment A to this ordinance, are hereby adopted and ratified on behalf of the  
31 population of unincorporated King County.  
32

Ordinance 17487 was introduced on 10/29/2012 and passed by the Metropolitan King County Council on 12/3/2012, by the following vote:

Yes: 9 - Mr. Phillips, Mr. von Reichbauer, Mr. Gossett, Ms. Hague,  
Ms. Patterson, Ms. Lambert, Mr. Ferguson, Mr. Dunn and Mr.  
McDermott  
No: 0  
Excused: 0

KING COUNTY COUNCIL  
KING COUNTY, WASHINGTON

  
Larry Gossett, Chair

ATTEST:



Anne Noris, Clerk of the Council

APPROVED this 13 day of DECEMBER, 2012.



Dow Constantine, County Executive

Attachments: A. Motion No. 12-5

ATTACHMENT A

9/11/12

Decision: Approved

Sponsored By:

Executive Committee

/pr

1

**MOTION NO. 12-5**

2

A MOTION to amend the Urban Growth Area of King  
County. This Motion also modifies the Potential Annexation  
Area map in the Countywide Planning Policies.

3

4

5

6

7

WHEREAS, the Washington State Growth Management Act, RCW 36.70A.110 requires  
counties to designate an urban growth area or areas within which urban growth shall be  
encouraged and outside of which growth can occur only if it is not urban in nature; and

8

9

10

11

WHEREAS, Countywide Planning Policy FW-1 Step 8 recognizes that King County may  
initiate amendments to the Urban Growth Area; and

12

13

14

WHEREAS, the King County Executive and the Metropolitan King County Council  
requests the Growth Management Planning Council consider the attached amendments to  
the Urban Growth Area for eventual adoption by the Metropolitan King County Council  
and ratification by the cities; and

15

16

17

18

19

WHEREAS, Countywide Planning Policies LU-31 and LU-32 anticipate the collaborative  
designation of Potential Annexation Areas and the eventual annexation of these areas by  
cities. The attached amendments are supported by the affected city.

20

21

22

23

BE IT RESOLVED THAT THE GROWTH MANAGEMENT PLANNING COUNCIL OF  
KING COUNTY HEREBY MOVES AS FOLLOWS:

24

25

26

1. Amend the Urban Growth Area as designated by the Urban Growth Areas Map in the  
Countywide Planning Policies, the Potential Annexation Area map, as depicted on the  
following attached maps:

27

28

29

30

Attachment 1: Sammamish – Soaring Eagle

31

Attachment 2: Snoqualmie – Mining Site

32

Attachment 3: Auburn – 148<sup>th</sup> Ave. SE technical correction

33

Attachment 4: Black Diamond – 212<sup>th</sup> Ave. SE technical correction

34

Attachment 5: Redmond – NE Union Hill Road/196<sup>th</sup> Ave NE technical correction

35

Attachment 6: Black Diamond – Lake Sawyer Road SE technical correction

36

Attachment 7: Renton – SE Old Petrovitski Road technical correction

1  
2  
3  
4  
5  
6  
7  
8  
9  
10  
11  
12  
13  
14  
15  
16  
17  
18  
19  
20  
21  
22  
23  
24  
25  
26  
27

- Attachment 8: Maple Valley – SE 281<sup>st</sup> Way technical correction
- Attachment 9: Maple Valley – SE 288<sup>th</sup> St. technical correction
- Attachment 10: Enumclaw – SE 440<sup>th</sup> St. technical correction
- Attachment 11: North Bend – SE 142<sup>nd</sup> St. technical correction
- Attachment 12: North Bend – SE 150<sup>th</sup> ST technical correction
- Attachment 13: Auburn – SE Green Valley Road technical correction
- Attachment 14: Duvall – SR 203/NE 140<sup>th</sup> St. technical correction
- Attachment 15: Maple Valley split parcel

- 2. Amend the Interim Potential Annexation Area Map by including any additional unincorporated urban land created by these UGA amendments in the Potential Annexation Area of the adjoining city, and deleting any land changed from urban to rural from the respective PAA.
- 3. These amendments are recommended to the King County Council and the Cities of King County for adoption and ratification.

ADOPTED by the Growth Management Planning Council of King County in open session on September 11, 2012 and signed by the chair of the GMPC.

\_\_\_\_\_  
Dow Constantine, Chair, Growth Management Planning Council

# Soaring Eagle Recommended Land Use Map



**King County**  
Department of Development and  
Environmental Services

The information included on this map has been compiled by King County staff from a variety of sources and is subject to change without notice. King County makes no representations or warranties, express or implied, as to accuracy, completeness, timeliness, or rights to the use of such information. This document is not intended for use as a survey product. King County shall not be liable for any general, special, indirect, incidental, or consequential damages including, but not limited to, lost revenues or lost profits resulting from the use or misuse of the information contained on this map. Any sale of this map or information on this map is prohibited except by written permission of King County.

Date: January 26, 2012  
\\gisnas1\Projects\ddes\2012\_CompPlan\Projects\SoaringEagle\_rec\_lubw.mxd  
\\gisnas1\Projects\ddes\2012\_CompPlan\delivery\SoaringEagle\_rec\_lubw.pdf  
MCCOMBSP

OS KC Open Space System  
Op Other Parks/Wilderness

 Incorporated Areas

 Urban Growth Boundary

 Study Area

 Proposed Urban  
Growth Boundary



0 200 400  
Feet

OS

Op  
~~OS~~

Sammamish

SE 9TH WAY

SE 9TH WAY

268TH WAY SE  
269TH AVE SE

TROSSACHS BLVD SE  
270TH PL SE

270TH CT SE  
271ST AVE SE

SE 12TH ST

SE 11TH ST

17487

# Snoqualmie - Mining





## Recommended Land Use Map



**King County**  
Department of Development and  
Environmental Services

The information included on this map has been compiled by King County staff from a variety of sources and is subject to change without notice. King County makes no representations or warranties, express or implied, as to accuracy, completeness, timeliness, or rights to the use of such information. This document is not intended for use as a survey product. King County shall not be liable for any general, special, indirect, incidental, or consequential damages including, but not limited to, lost revenues or lost profits resulting from the use or misuse of the information contained on this map. Any sale of this map or information on this map is prohibited except by written permission of King County.

Date: August 11, 2012  
\\gisnas1\projects\ddes\2012\_CompPlan\Projects\SnoqualmieMining.mxd  
\\gisnas1\projects\ddes\2012\_CompPlan\Delivery\SnoqualmieMining.pdf  
MCCOMBSP



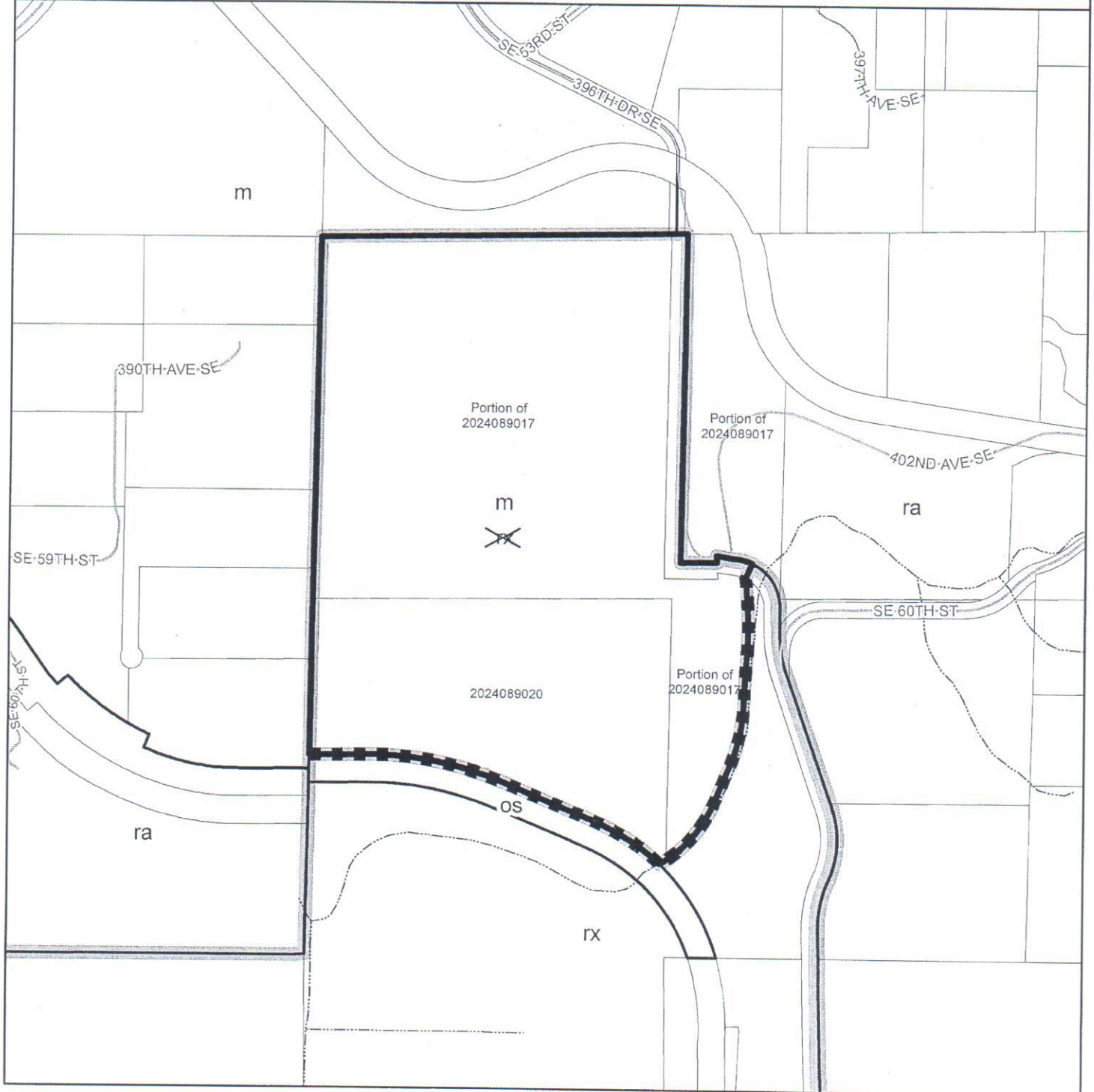

- rx** Rural Cities Urban Growth Area
- ra** Rural Area
- m** Mining
- OS** King County Open Space System
-  Incorporated Areas
-  Urban Growth Boundary
-  Change
-  Proposed Urban Growth Boundary

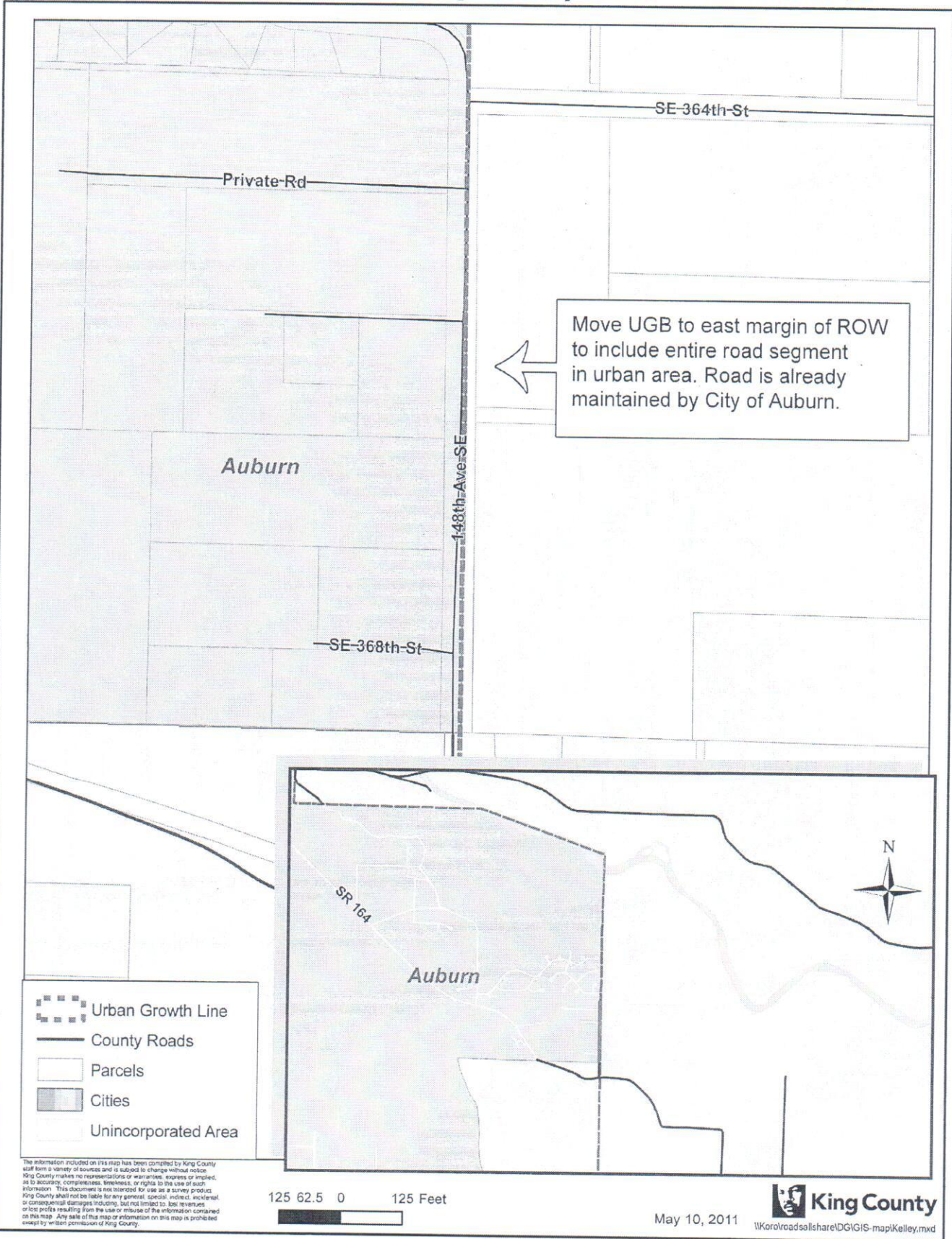

# Urban Growth Boundary Right of Way Issues - 148th Avenue SE

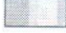

Move UGB to east margin of ROW to include entire road segment in urban area. Road is already maintained by City of Auburn.

-  Urban Growth Line
-  County Roads
-  Parcels
-  Cities
-  Unincorporated Area

The information included on this map has been compiled by King County staff from a variety of sources and is subject to change without notice. King County makes no representations or warranties, express or implied, as to accuracy, completeness, timeliness, or rights to the use of such information. This document is not intended for use as a survey product. King County shall not be liable for any general, special, indirect, incidental, or consequential damages including, but not limited to, lost revenues or lost profits resulting from the use or misuse of the information contained on this map. Any sale of this map or information on this map is prohibited except by written permission of King County.

125 62.5 0 125 Feet



# Urban Growth Boundary Right of Way Issues - 212th Avenue SE

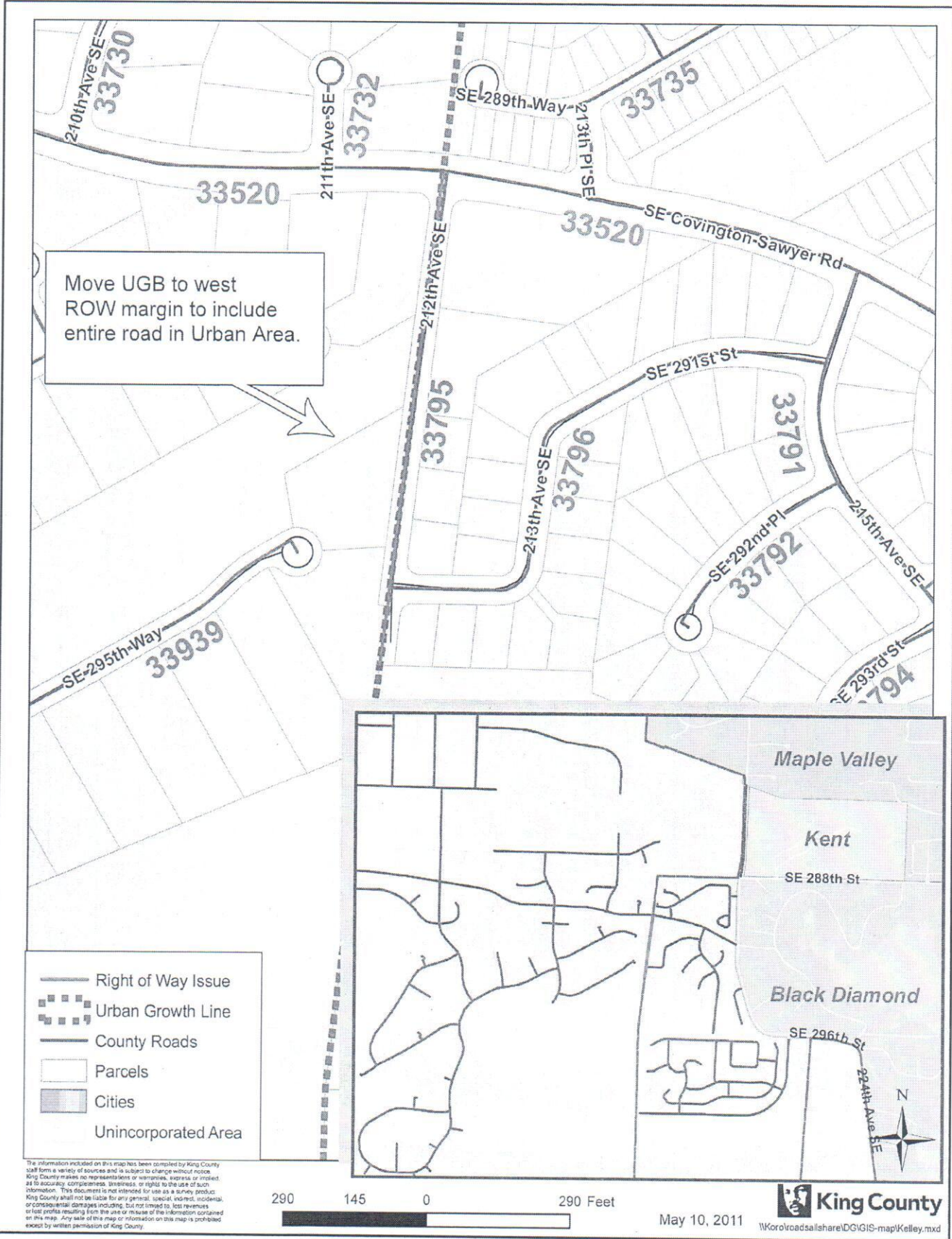

Move UGB to west ROW margin to include entire road in Urban Area.

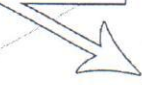

17487

# Urban Growth Boundary Right of Way Issues - NE Union Hill Road

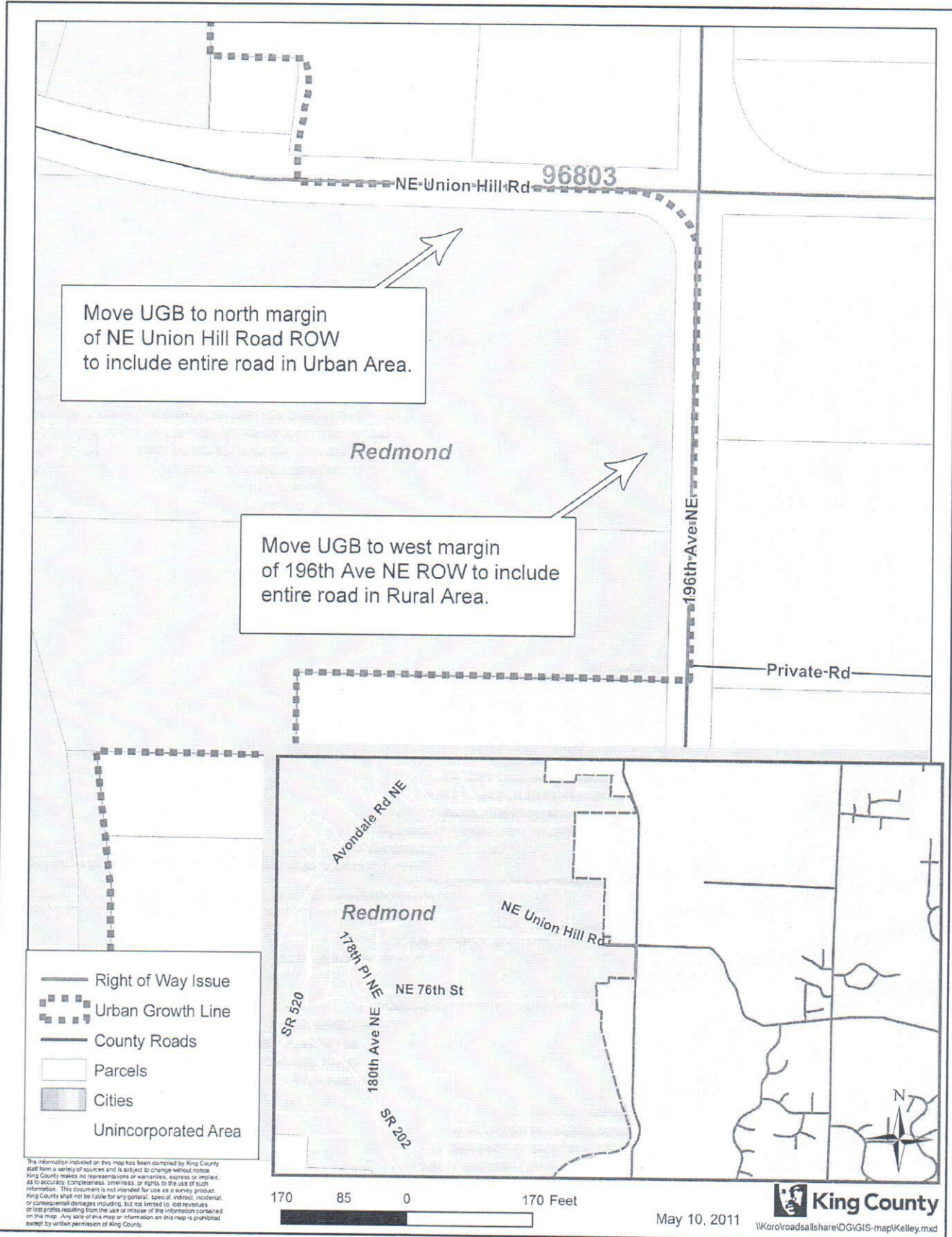

### Urban Growth Boundary Right of Way Issues - Lake Sawyer Rd SE

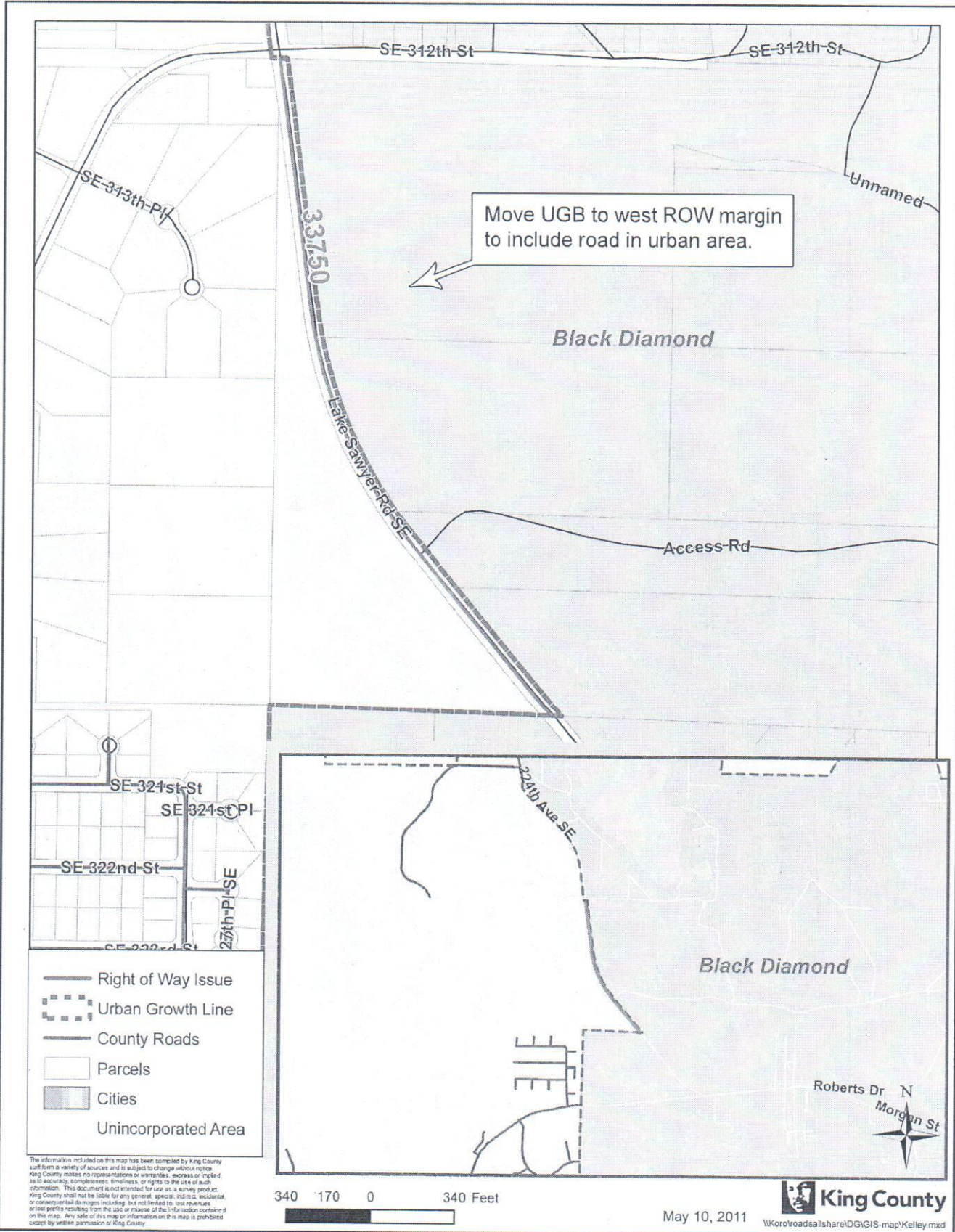

### Urban Growth Boundary Right of Way Issues - SE Old Petrovitsky Road

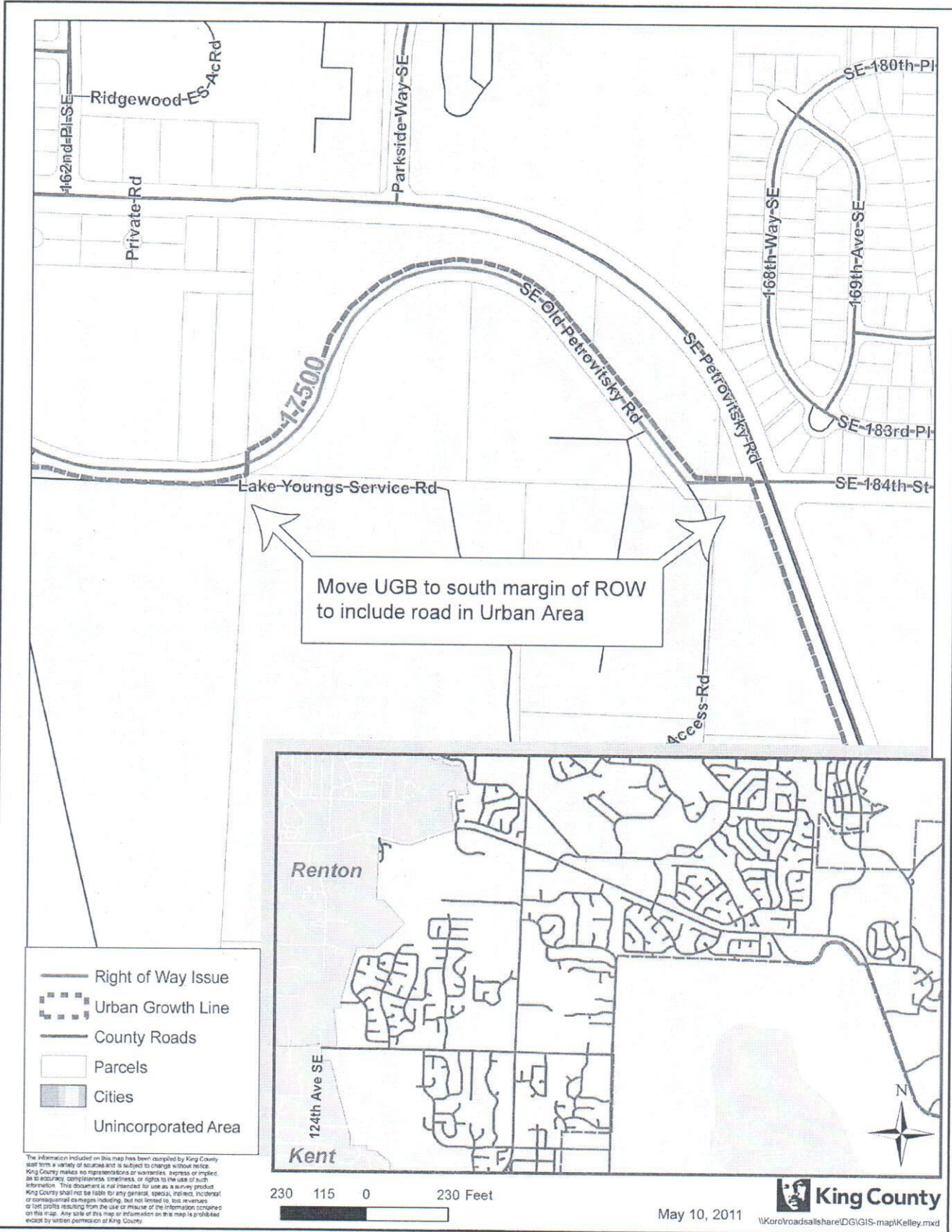

### Urban Growth Boundary Right of Way Issues - SE 281st Way

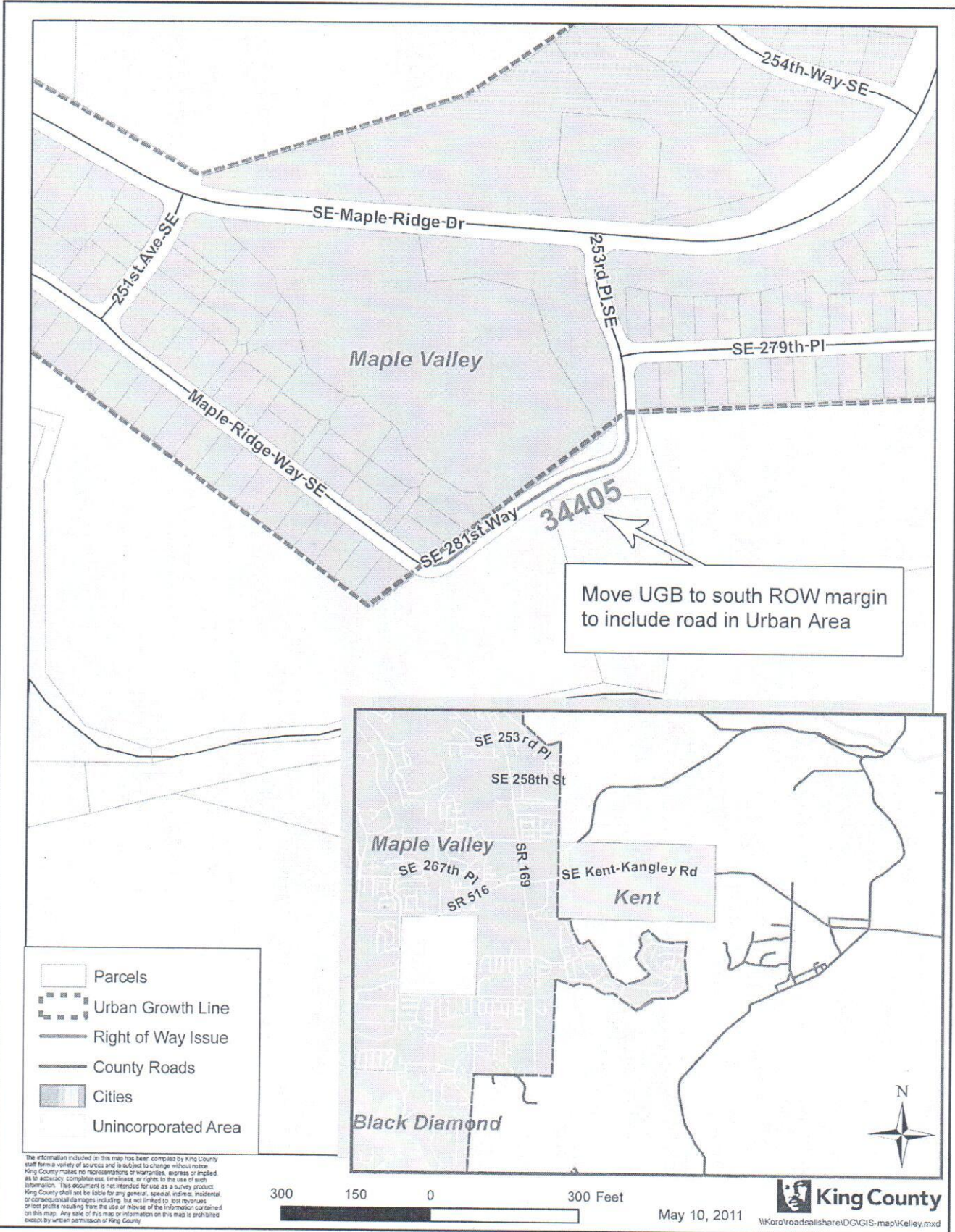

34405

Move UGB to south ROW margin to include road in Urban Area

- Parcels
- Urban Growth Line
- Right of Way Issue
- County Roads
- Cities
- Unincorporated Area

The information included on this map has been compiled by King County staff from a variety of sources and is subject to change without notice. King County makes no representations or warranties, express or implied, as to the accuracy, completeness, timeliness, or rights to the use of such information. This document is not intended for use as a survey product. King County shall not be liable for any general, special, indirect, incidental, or consequential damages including, but not limited to, lost revenues or lost profits resulting from the use or misuse of the information contained on this map. Any sale of this map or information on this map is prohibited except by written permission of King County.



May 10, 2011

### Urban Growth Boundary Right of Way Issues - SE 288th Street

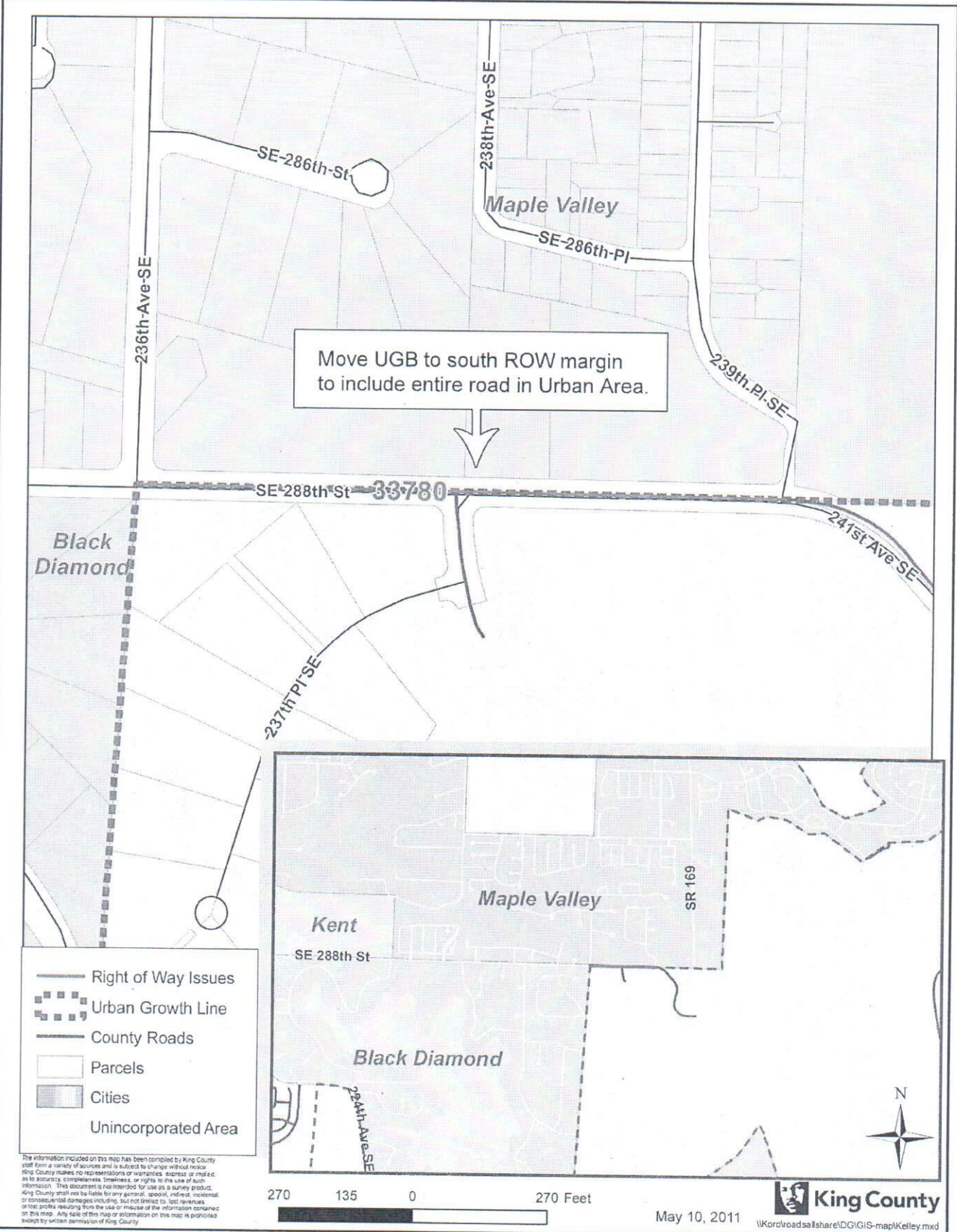

# Urban Growth Boundary Right of Way Issues - SE 440th Street

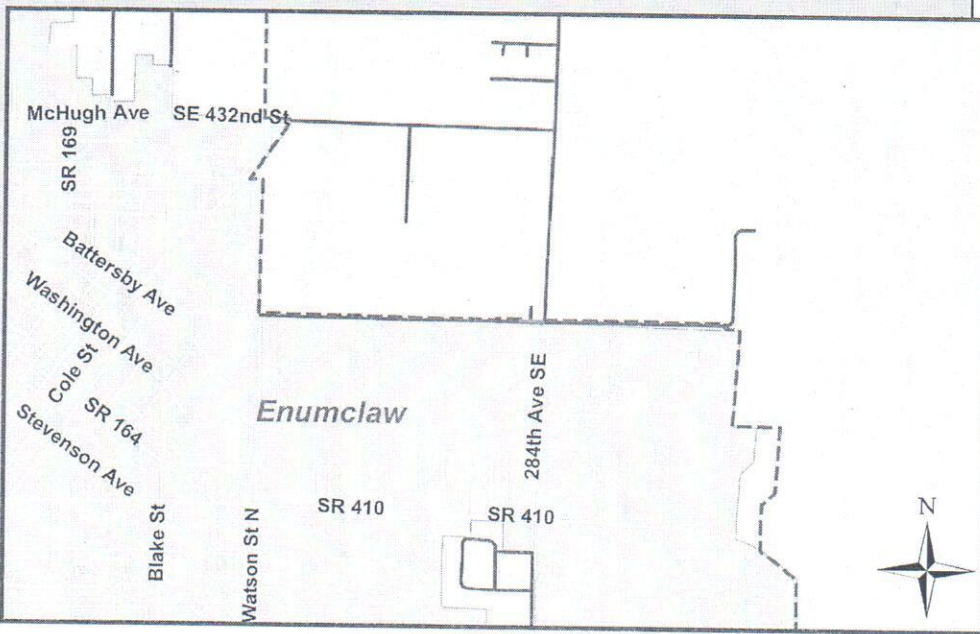
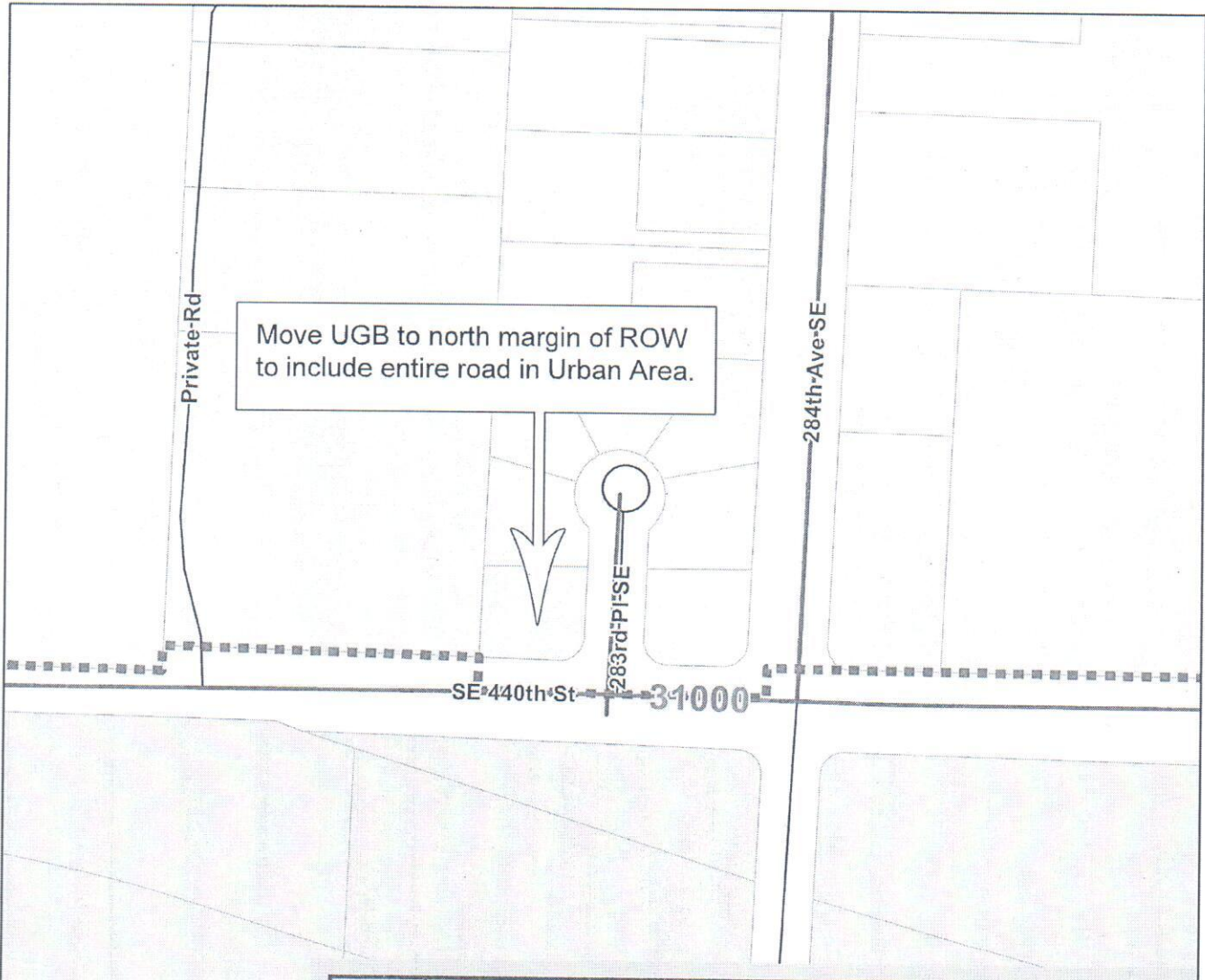

- Right of Way Issue
- Urban Growth Line
- County Roads
- Parcels
- Cities
- Unincorporated Area

The information included on this map has been compiled by King County staff from a variety of sources and is subject to change without notice. King County makes no representations or warranties, express or implied, as to accuracy, completeness, timeliness, or rights to the use of such information. This document is not intended for use as a survey product. King County shall not be liable for any general, special, indirect, incidental, or consequential damages including, but not limited to, lost revenues or lost profits resulting from the use or misuse of the information contained on this map. Any sale of this map or information on this map is prohibited except by written permission of King County.







17487

# Proposed Revision to UGBL

For Informational Use Only

SE 142nd Street  
Section 15, Township 23,  
Range 8 E

-  City of North Bend
-  North Bend Potential Annexation Area
-  KC Maintained
-  Current UGBL
-  Proposed UGBL



King County

250 125 0 250 500 Feet

June 21, 2011

The information included on this map has been compiled by King County staff from a variety of sources and is subject to change without notice. King County makes no representations or warranties, express or implied, as to accuracy, completeness, timeliness, or rights to the use of this information. This document is not intended for use as a survey product. King County shall not be liable for any general, special, indirect, incidental, or consequential damages including, but not limited to, lost revenues or lost profits resulting from the use or misuse of the information contained on this map. Any sale of this map or information on this map is prohibited except by written permission of King County.

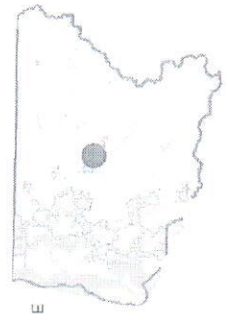

© King County North Bend Area - UGBL, East/SE 142nd St map

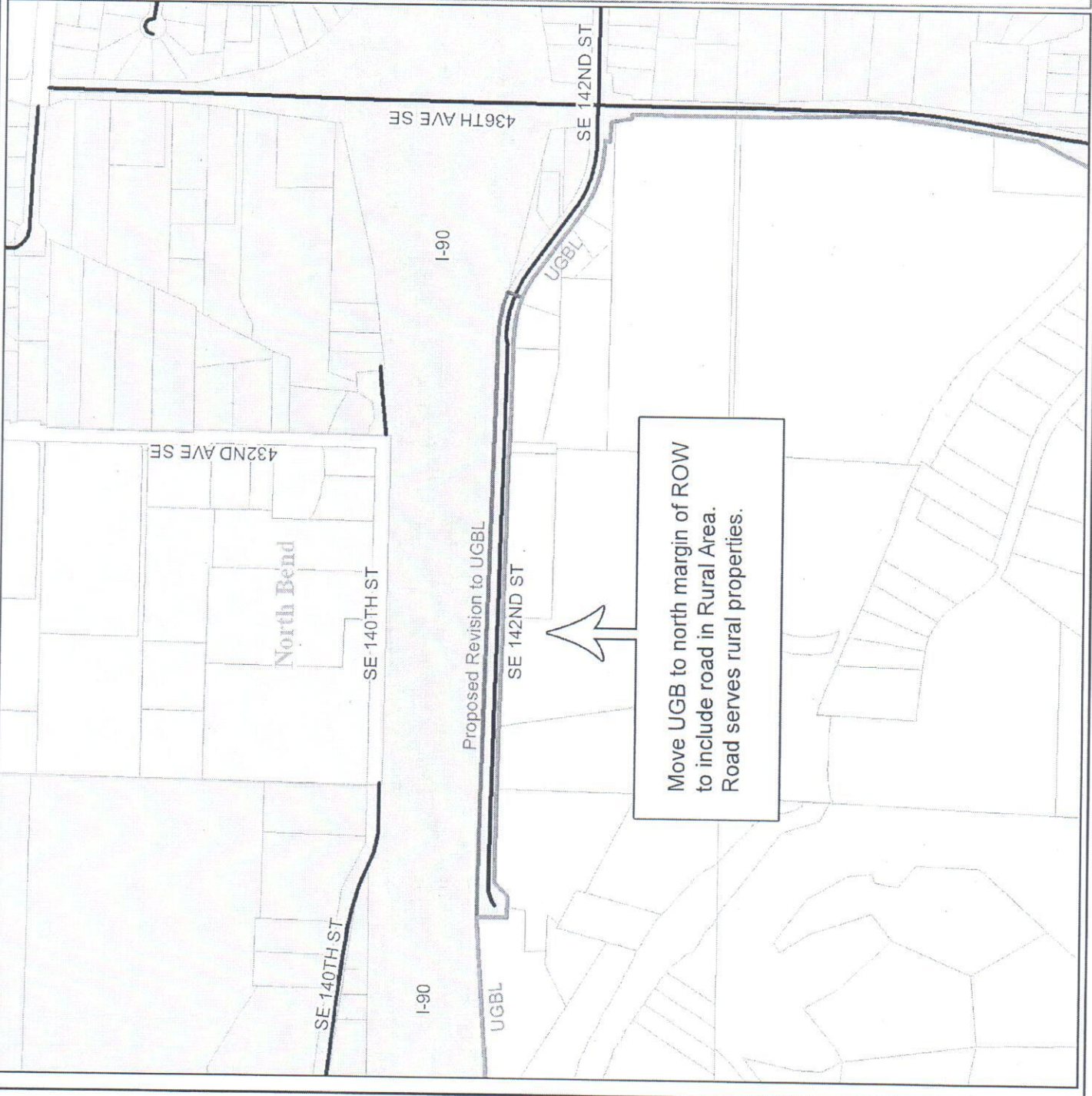



# Proposed Revision to UGBL

For Informational Use Only

SE 150th Street  
Section 24, Township 23,  
Range 8 E

-  City of North Bend
-  KC Maintained
-  Current UGBL
-  Proposed UGBL



King County

250125 0 250 500 Feet

June 21, 2011

The information included on this map has been compiled by King County staff from a variety of sources and is subject to change without notice. King County makes no representations or warranties, express or implied, as to accuracy, completeness, timeliness, or rights to the use of such information. This document is not intended for use as a survey product. King County shall not be liable for any general, special, indirect, incidental or consequential damages, including, but not limited to, lost revenues or lost profits resulting from the use or misuse of the information contained on this map. Any sale of this map or information on this map is prohibited except by written permission of King County.

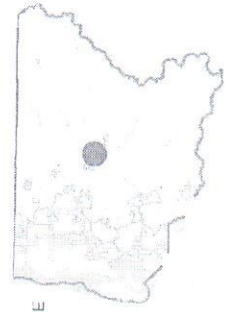

City of North Bend Area - UGBL Edits SE 150th St.doc

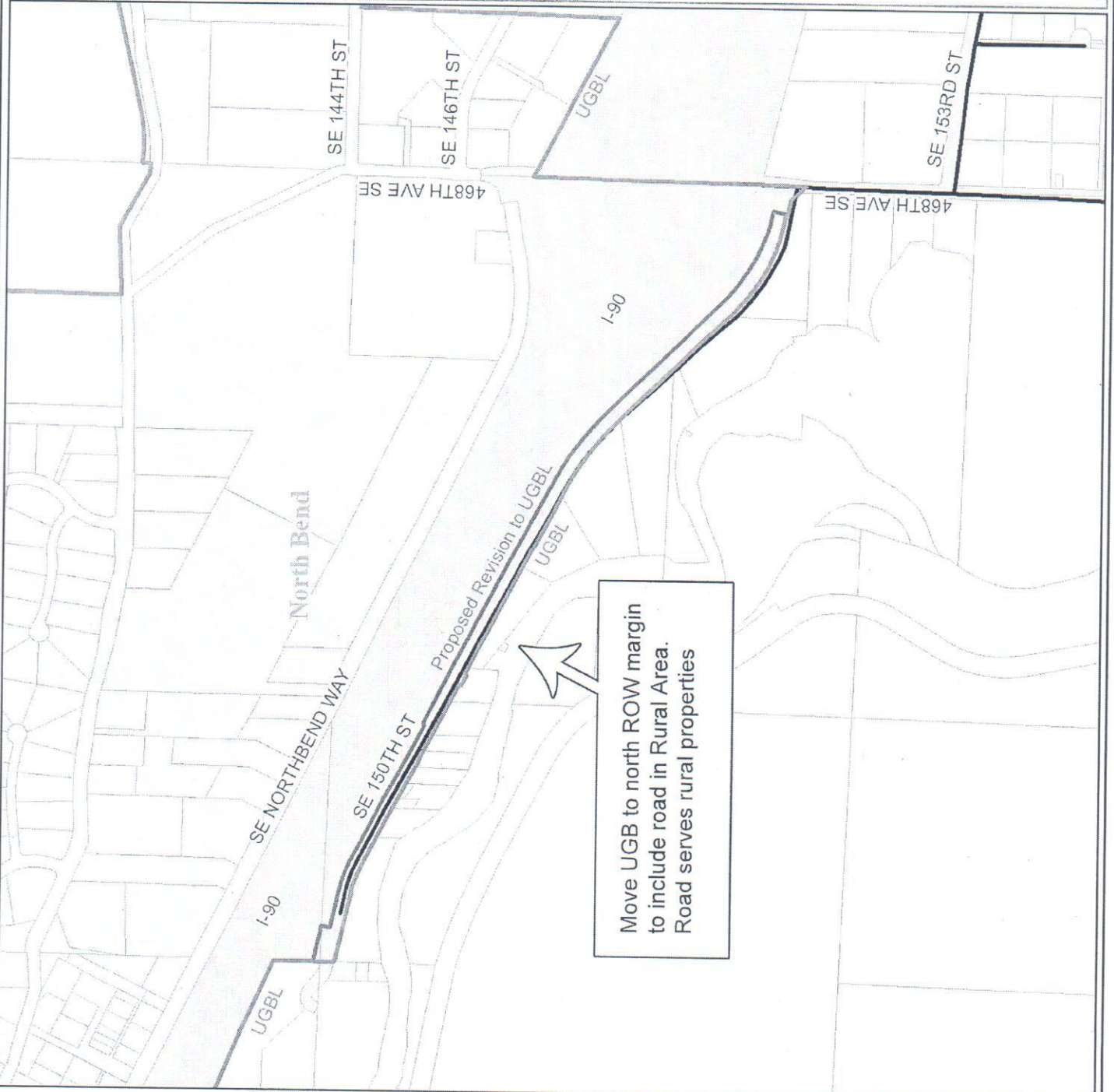

# Urban Growth Boundary Right of Way Issues - SE Green Valley Road

Move UGB to south ROW margin to include road in Rural Area. All other segments of SE Green Valley Road are rural.

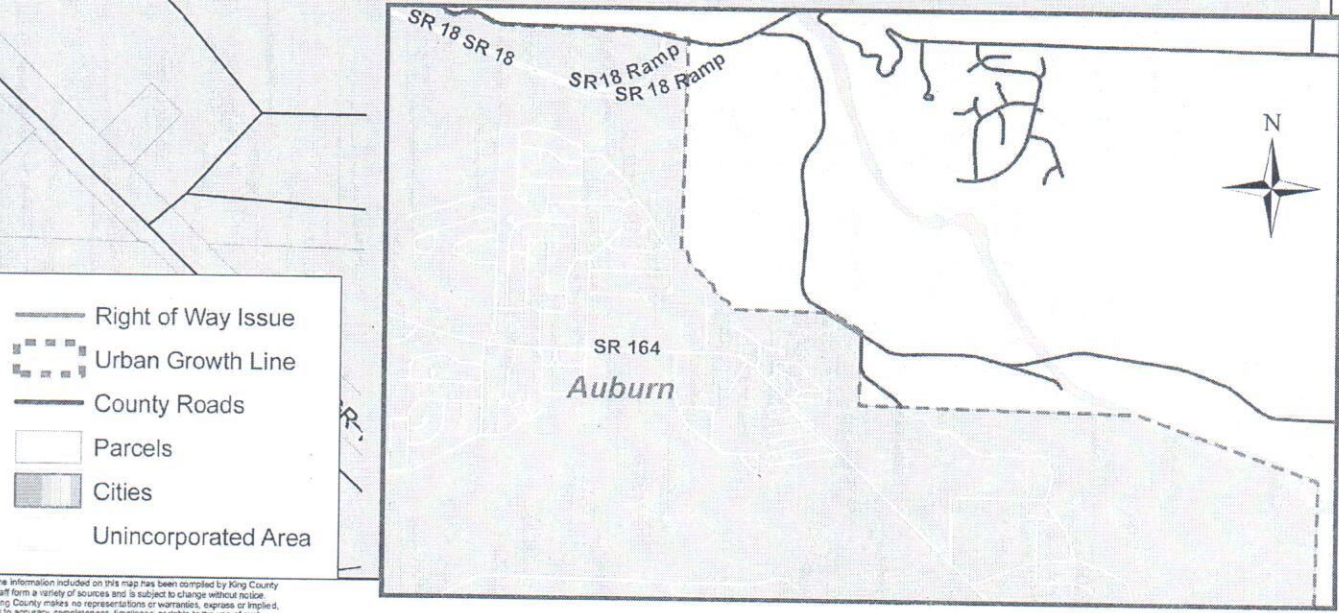
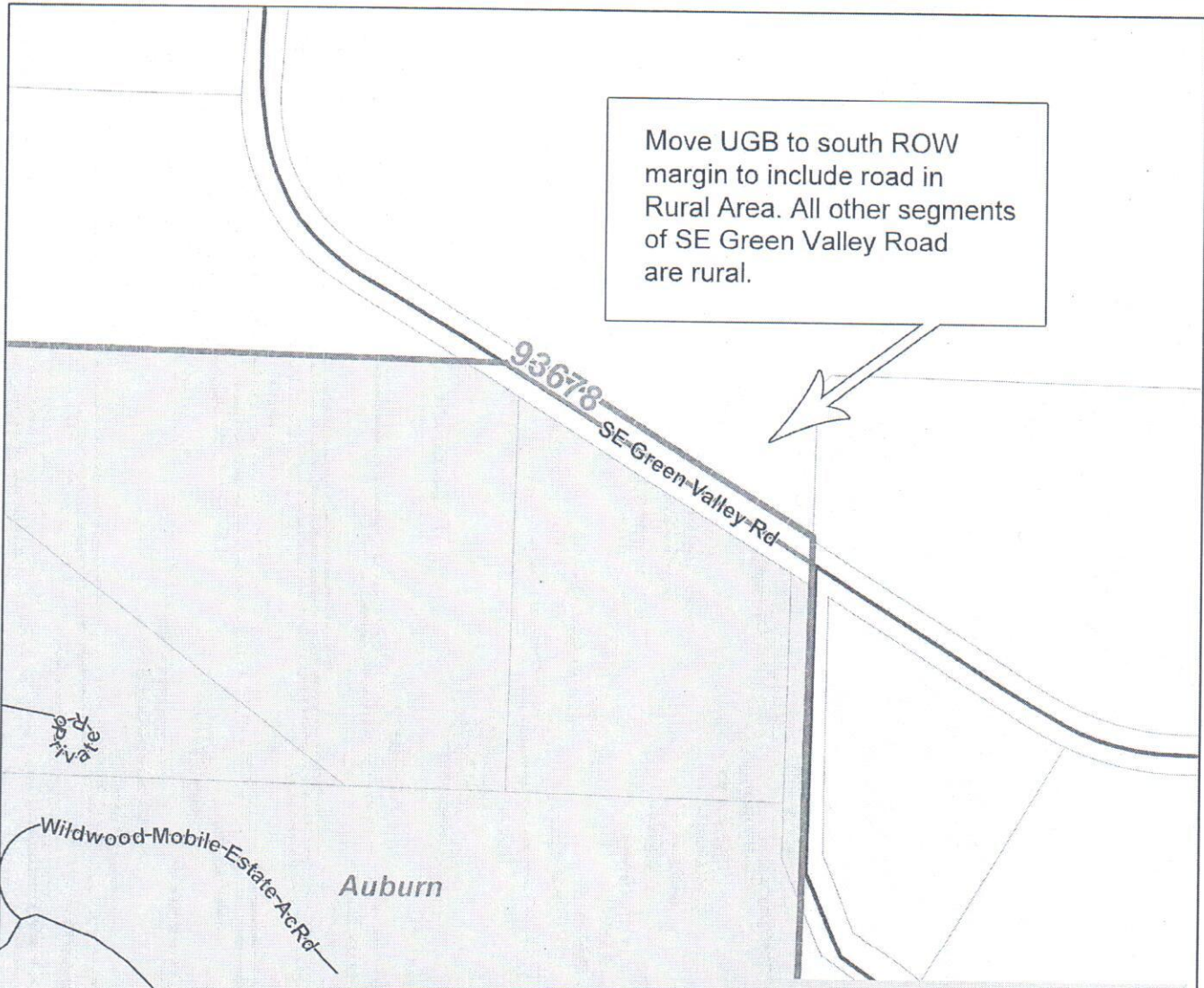

- Right of Way Issue
- Urban Growth Line
- County Roads
- Parcels
- Cities
- Unincorporated Area

The information included on this map has been compiled by King County staff from a variety of sources and is subject to change without notice. King County makes no representations or warranties, express or implied, as to accuracy, completeness, timeliness, or rights to the use of such information. This document is not intended for use as a survey product. King County shall not be liable for any general, special, indirect, incidental, or consequential damages including, but not limited to, lost revenues or lost profits resulting from the use or misuse of the information contained on this map. Any sale of this map or information on this map is prohibited except by written permission of King County.

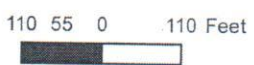

# Urban Growth Boundary Right of Way Issues - SR 203 & NE 140th Street

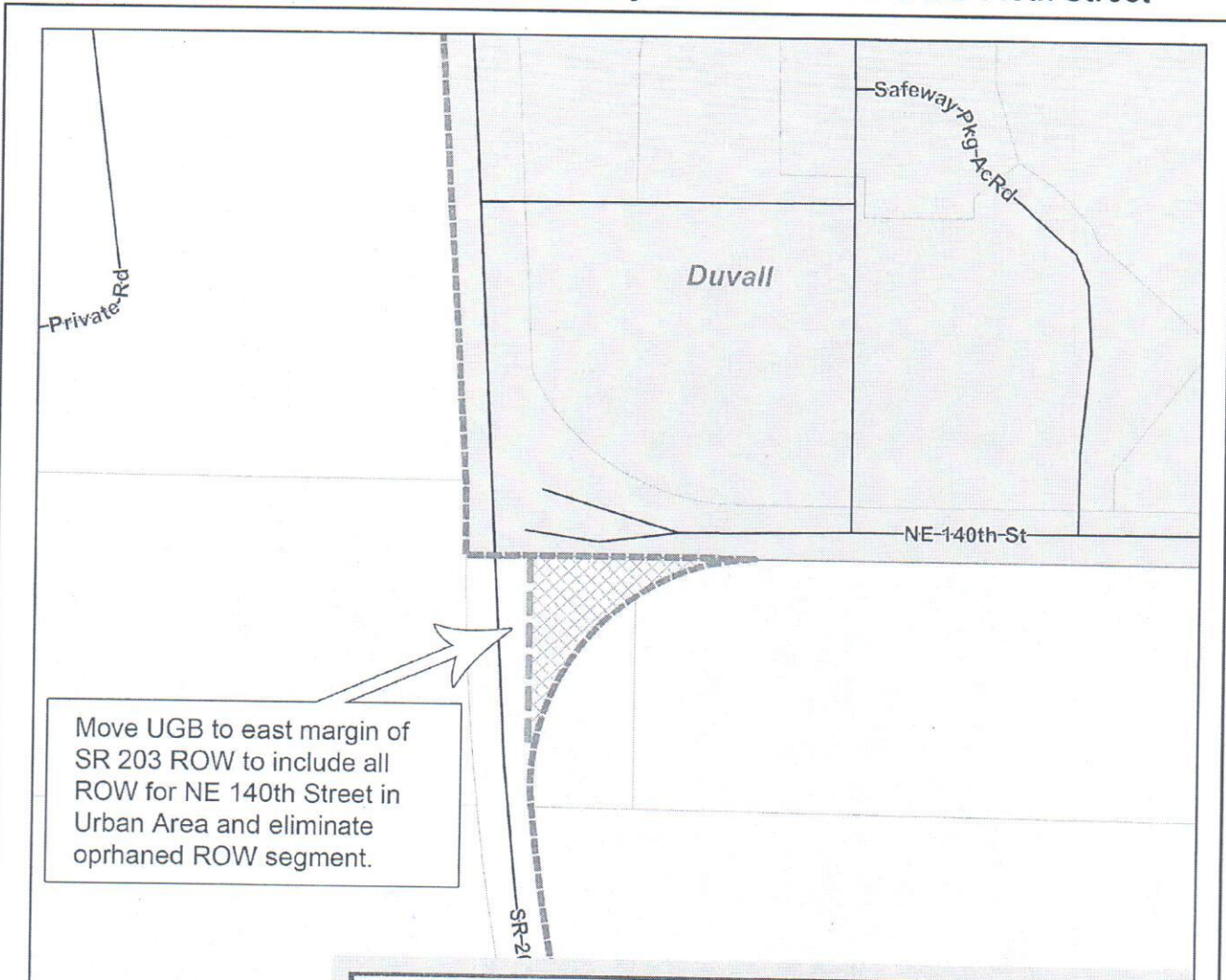

Move UGB to east margin of SR 203 ROW to include all ROW for NE 140th Street in Urban Area and eliminate orphaned ROW segment.

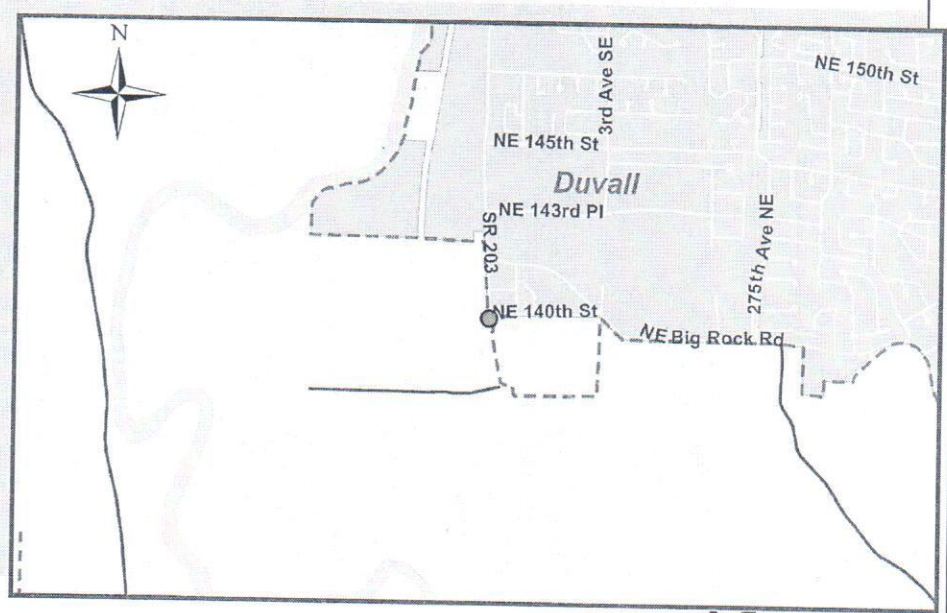

- Urban Growth Line
- County Roads
- Parcels
- Cities
- Unincorporated Area

The information included on this map has been compiled by King County staff from a variety of sources and is subject to change without notice. King County makes no representations or warranties, express or implied, as to accuracy, completeness, timeliness, or rights to the use of such information. This document is not intended for use as a survey product. King County shall not be liable for any general, special, indirect, incidental, or consequential damages including, but not limited to, lost revenues or lost profits resulting from the use or misuse of the information contained on this map. Any sale of this map or information on the map is prohibited except by written permission of King County.





© 2008 King County

COMMENTS: Parcel 9405680050 is totally within the City of Maple Valley. However, the UGA line does not conform to the City's jurisdictional boundary.

The information included on this map has been compiled by King County staff from a variety of sources and is subject to change without notice. King County makes no representations or warranties, express or implied, as to accuracy, completeness, timeliness, or rights to the use of such information. This document is not intended for use as a survey product. King County shall not be liable for any general, special, indirect, incidental, or consequential damages including, but not limited to, lost revenues or lost profits resulting from the use or misuse of the information contained on this map. Any sale of this map or information on this map is prohibited except by written permission of King County.

Date: 8/24/2012 Source: King County IMAP - Property Information (<http://www.metrokc.gov/GIS/IMAP>)

